

MHTL STATION COORDINATES					
STATION #	NORTHING	EASTING	STATION #	NORTHING	EASTING
STA 506	2000244	5880928	STA 521	2000244	5881968
STA 507	2000245	5880999	STA 522	2000257	5882039
STA 508	2000245	5881071	STA 523	2000262	5882115
STA 509	2000246	5881141	STA 524	2000268	5882177
STA 510	2000246	5881212	STA 525	2000271	5882246
STA 511	2000247	5881281	STA 526	2000277	5882317
STA 512	2000247	5881350	STA 527	2000285	5882387
STA 513	2000247	5881420	STA 528	2000292	5882447
STA 514	2000248	5881487	STA 529	2000287	5882524
STA 515	2000269	5881558	STA 530	2000291	5882600
STA 516	2000265	5881625	STA 531	2000298	5882671
STA 517	2000258	5881698	STA 532	2000322	5882718
STA 518	2000245	5881771	STA 533	2000335	5882735
STA 519	2000241	5881838	STA 534	2000333	5882788
STA 520	2000240	5881899			

NOTE: MHTL STATIONS 506 THRU 511, 514, 525
THRU 527, AND 529 THRU 533 ARE ON THE FACE
OF SEAWALL.

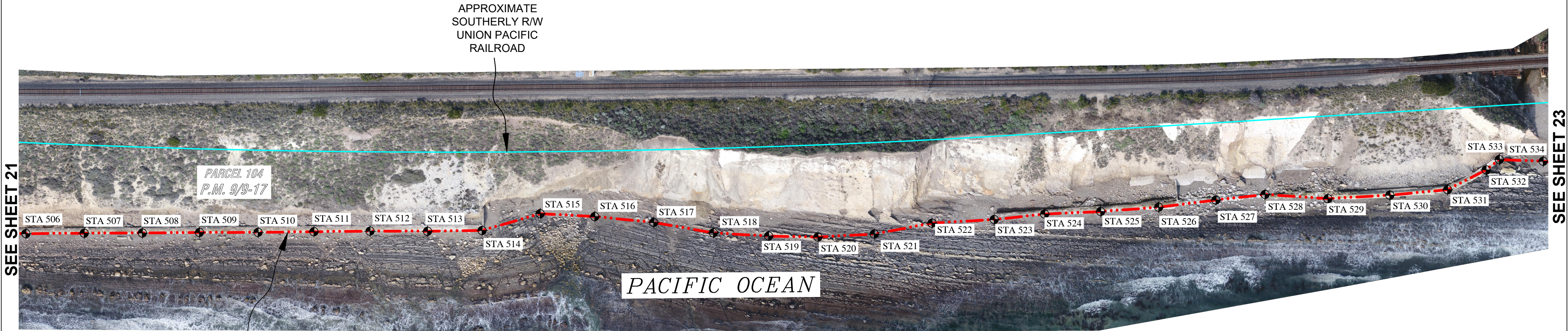

JANUARY 2019
MHTL BASED ON
ELEVATION OF 4.46'
NAVD 88.

LEGEND

- JANUARY 2019 MEAN HIGH TIDE LINE (MHTL) PER FIELD SURVEYS PERFORMED BY CSLC STAFF JAN. 29 & 30, 2019 AND BASED ON AN ELEVATION OF 4.46' NAVD 88.
- APPROXIMATE SOUTHERLY R/W OF UNION PACIFIC RAILROAD. BASED ON RECORD INFORMATION DEPICTED ON SANTA BARBARA COUNTY PARCEL MAPS FILED IN BOOK 8 OF PARCEL MAPS AT PAGES 45 -57 AND BOOK 9 OF PARCEL MAPS AT PAGES 9 - 17.
- MHTL STATION POINT

NOTES

- 1) THE UNITS FOR ALL COORDINATES AS SHOWN ARE US SURVEY FEET, UNLESS OTHERWISE NOTED.
- 2) AERIAL PHOTOGRAPHY PER CSLC UAV IMAGERY OBTAINED DECEMBER 18 THRU 20, 2018, AND JANUARY 29 THRU 31, 2019.
- 3) THIS PLAT HAS NOT BEEN APPROVED BY THE STATE LANDS COMMISSION AND DOES NOT CONSTITUTE AN OFFICIAL PLAT OF SUCH COMMISSION. NOR DOES IT ESTABLISH THE BOUNDARY LINES OR LIMITATIONS OF ANY STATE-OWNED LANDS DEPICTED HEREON.

*SURVEY OF THE
MEAN HIGH TIDE LINE
DECEMBER 4, 5, 18, 19, & 20, 2018,
JANUARY 29, 30, 31, AND
MARCH 18, 2019
HOLLISTER RANCH
SANTA BARBARA COUNTY*

**CALIFORNIA STATE
LANDS COMMISSION**



DRAWING NAME: SD20180809-SH21-24.DWG
FILE NO.: SD20180809.1

DRAWN BY: JOSEPH PORTER, PLS 8266
CHECKED BY:

DATE: 4/4/19

SCALE: 1"=80'

SHEET

22

22 OF 24