

**STAFF REPORT  
C07**

A 3  
S 4

08/23/18  
PRC 2216.1  
S. Evans

**REVISION OF RENT**

**LESSEE:**

Faces, Inc.

**AREA, LAND TYPE, AND LOCATION:**

1.04 acres, more or less, of sovereign land in Sacramento River, adjacent to 6985 Garden Highway, near Nicolaus, Sutter County.

**AUTHORIZED USE:**

Continued use and maintenance of a commercial marina known as Verona Village River Resort; consisting of an uncovered floating boat dock used for side tie berthing, accommodation dock, a portion of a dock, two floats, 13 pilings, electrical and water utility outlets, and a gangway.

**LEASE TERM:**

20 years, beginning September 20, 2013.

**CONSIDERATION:**

This lease provides that the Commission may modify the rent periodically during the lease term. Pursuant to this provision, staff reviewed the rent under this lease and recommends that rent be revised from \$1,715 per year to \$1,775 per year, effective September 20, 2018.

**OTHER PERTINENT INFORMATION:**

1. On September 20, 2013, the Commission authorized a General Lease – Commercial Use to Faces, Inc. for a term of 20 years beginning September 20, 2013 ([Item C17, September 20, 2013](#)). The lease will expire on September 19, 2033.
2. This action is consistent with Strategy 2.2 of the Commission's Strategic Plan to ensure timely receipt of revenues and royalties from the use and development of State lands and minerals.

STAFF REPORT NO. **C07** (CONT'D)

3. Approving the revision of rent is not a project as defined by the California Environmental Quality Act because it is an administrative action that will not result in direct or indirect physical changes in the environment.

Authority: Public Resources Code section 21065 and California Code of Regulations, title 14, section 15378, subdivision (b)(5).

**EXHIBIT:**

- A. Site and Location Map

**RECOMMENDED ACTION:**

It is recommended that the Commission:

**AUTHORIZATION:**

Approve the revision of rent for Lease No. PRC 2216.1 from \$1,715 per year to \$1,775 per year, effective September 20, 2018.

NO SCALE

# SITE

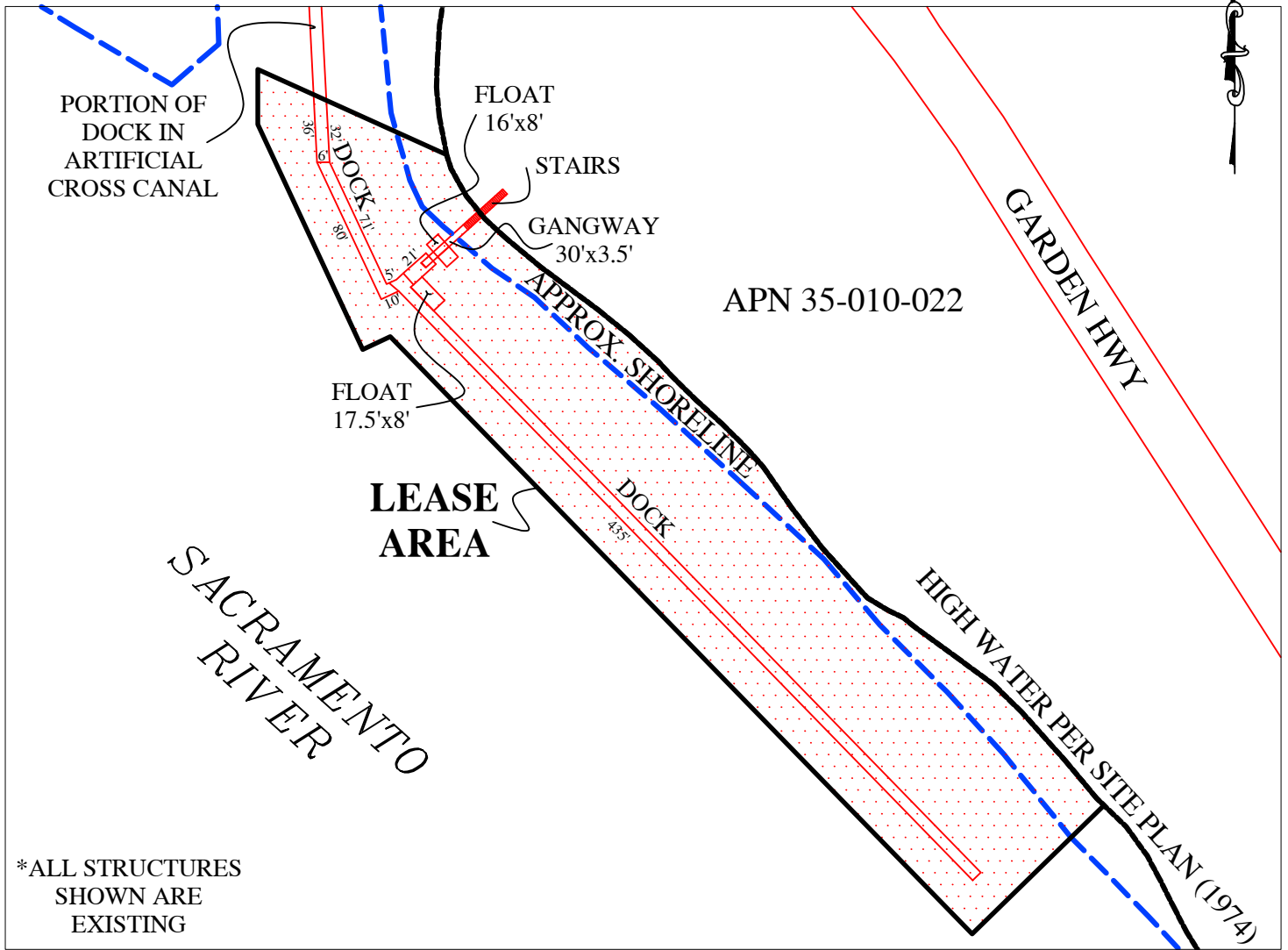

\*ALL STRUCTURES SHOWN ARE EXISTING

6985 Garden Highway, Nicolaus - Sacramento River

NO SCALE

# LOCATION

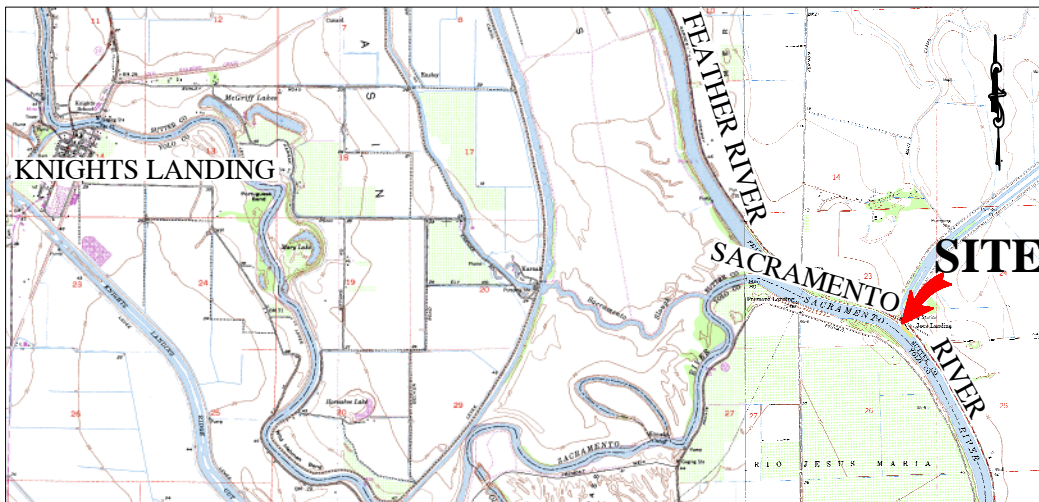

MAP SOURCE: USGS QUAD

# Exhibit A

PRC 2216.1  
 FACES, INC.  
 APN 35-010-022  
 GENERAL LEASE -  
 COMMERCIAL USE  
 SUTTER COUNTY



This Exhibit is solely for purposes of generally defining the lease premises, is based on unverified information provided by the Lessee or other parties and is not intended to be, nor shall it be construed as, a waiver or limitation of any State interest in the subject or any other property.