

**STAFF REPORT
C70**

A 33
S 16

04/19/18
PRC 9059.1
K. Connor

REVISION OF RENT

LESSEE:

Larry L. Large

AREA, LAND TYPE, AND LOCATION:

Sovereign land in the Colorado River, adjacent to 1126 Beach Drive, city of Needles, San Bernardino County.

AUTHORIZED USE:

Use and maintenance of riprap bankline, concrete stairs, rock walls, stacked block retaining wall, concrete patio with railing, and appurtenances.

LEASE TERM:

10 years, beginning April 26, 2013.

CONSIDERATION:

Stacked Block Retaining Wall and Concrete Patio with Railing and Appurtenances: This lease provides that the Commission may modify the rent periodically during the lease term. Pursuant to this provision, staff conducted a review of the rent under this lease and recommends that rent be revised from \$65 to \$125 per year, effective April 26, 2018.

Concrete Stairs, Rock Walls, and Riprap Bankline: Public use and benefit, with the State reserving the right to set a monetary consideration if it is determined to be in the best interest of the State.

OTHER PERTINENT INFORMATION:

1. On April 26, 2013, the Commission authorized a General Lease – Recreational and Protective Structure Use to the Lessee for the use and maintenance of riprap bankline, concrete stairs, rock walls, stacked block retaining wall, concrete patio with railing, and appurtenances ([Item C79, April 26, 2013](#)). The lease will expire on April 25, 2023.

STAFF REPORT NO. **C70** (CONT'D)

2. This action is consistent with Strategy 2.2 of the Commission's Strategic Plan to ensure timely receipt of revenues and royalties from the use and development of State lands and minerals.
3. Approving the revision of rent is not a project as defined by the California Environmental Quality Act because it is an administrative action that will not result in direct or indirect physical changes in the environment.

Authority: Public Resources Code section 21065 and California Code of Regulations, title 14, section 15378, subdivision (b)(5).

EXHIBIT:

- A. Site and Location Map

RECOMMENDED ACTION:

It is recommended that the Commission:

AUTHORIZATION:

Approve the revision of rent for Lease No. PRC 9059.1 from \$65 to \$125 per year, effective April 26, 2018.

NO SCALE

SITE

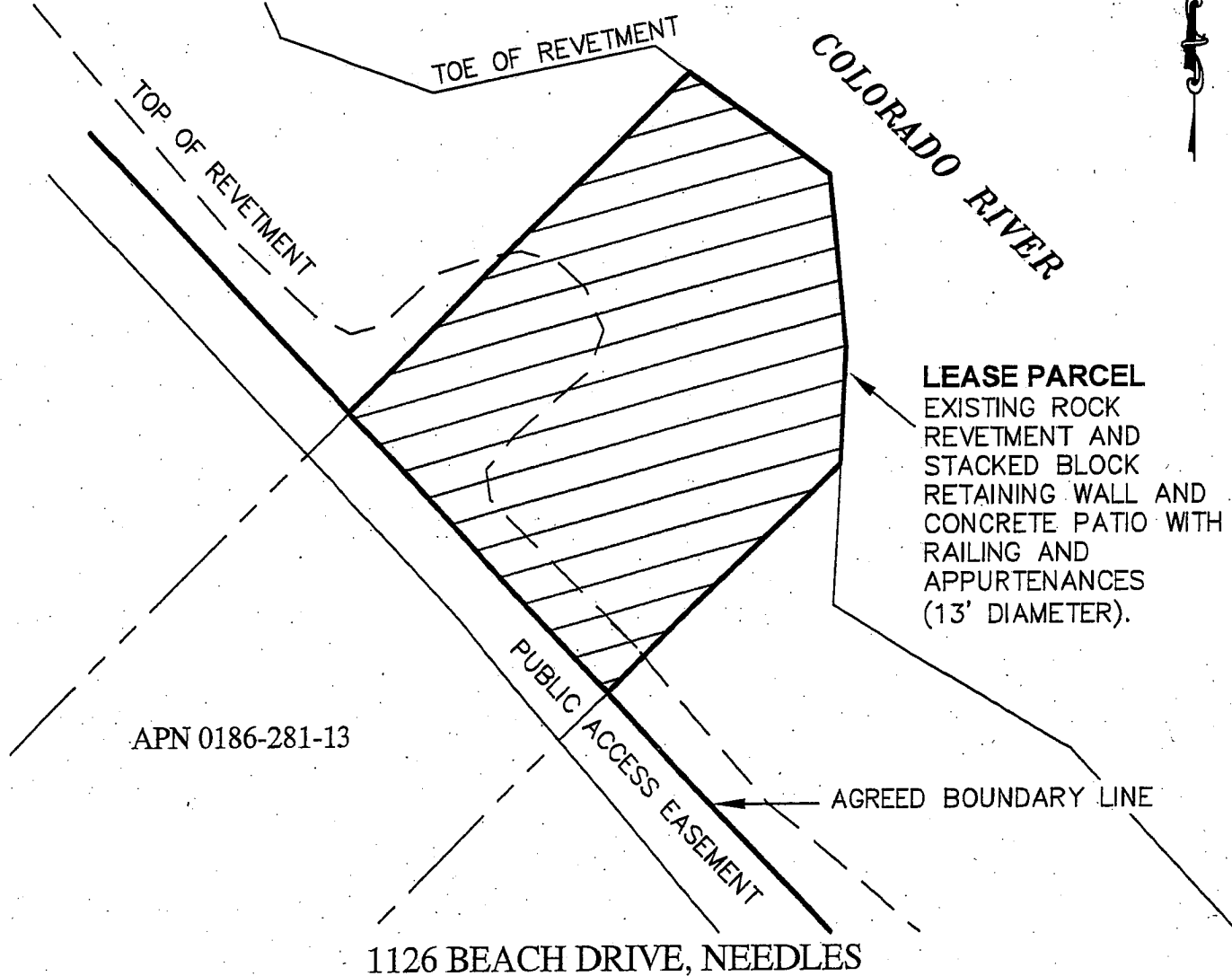

NO SCALE

LOCATION

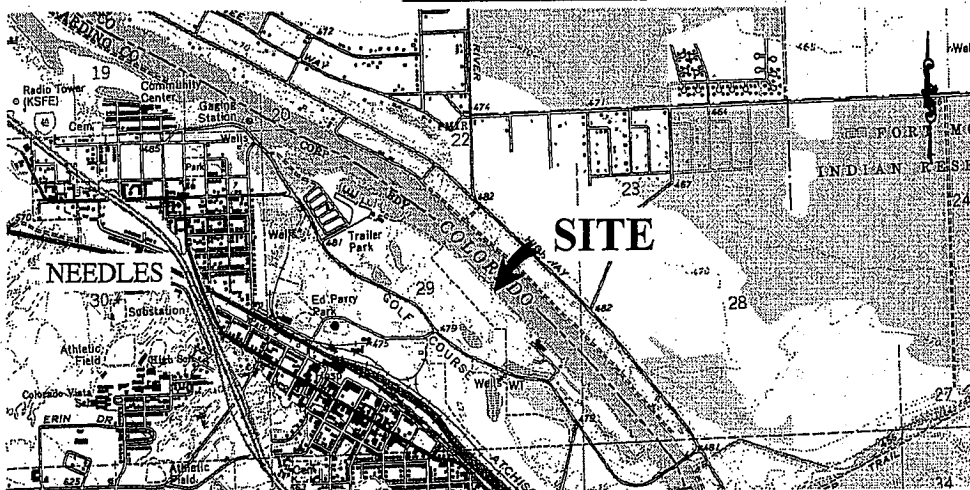
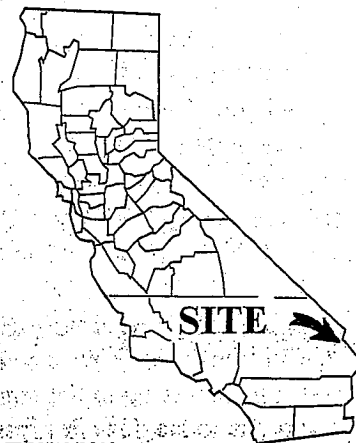

Exhibit A

PRC 9059.1
 LARGE
 APN 0186-281-13
 GENERAL LEASE -
 RECREATIONAL & PROTECTIVE
 STRUCTURE USE
 SAN BERNARDINO COUNTY



This Exhibit is solely for purposes of generally defining the lease premises, is based on unverified information provided by the Lessee or other parties and is not intended to be, nor shall it be construed as, a waiver or limitation of any State interest in the subject or any other property.