

**STAFF REPORT  
C08**

A 1  
S 1

11/29/17  
PRC 3622.1  
K. Connor

**GENERAL LEASE – RECREATIONAL USE**

**APPLICANT:**

Suzanne Scharf

**PROPOSED LEASE:**

*AREA, LAND TYPE, AND LOCATION:*

Sovereign land in Lake Tahoe, adjacent to 4910 West Lake Boulevard, near Homewood, Placer County.

*AUTHORIZED USE:*

Continued use and maintenance of an existing pier and two mooring buoys.

*LEASE TERM:*

10 years, beginning December 15, 2017.

*CONSIDERATION:*

\$1,031 per year, with an annual Consumer Price Index adjustment.

*SPECIFIC LEASE PROVISIONS:*

1. Liability insurance in an amount no less than \$1,000,000 per occurrence.
2. Lessee shall not store any personal items or construct any improvements in the Public Trust easement that may impair the public uses of access, navigation, fishing and lake-related recreational uses.
3. If Lessee does not have a valid Tahoe Regional Planning Agency (TRPA) buoy permit, Lessee is required to obtain such authorization for the mooring buoys within 2 years after the certification of a Final Environmental Impact Statement for the Lake Tahoe Shorezone Ordinance Amendments and approval of the amended ordinances. If the Lessee is unable to obtain such authorization within the time limit, the Lessee may be required to remove the buoys.

STAFF REPORT NO. **C08** (CONT'D)

4. Lessee expressly acknowledges and agrees that issuance of a lease does not substitute for, or provide preference in, obtaining authorizations from TRPA or any other regulatory agency for the improvements authorized by the Commission.

**STAFF ANALYSIS AND RECOMMENDATION:**

**Authority:**

Public Resources Code sections 6005, 6216, 6301, 6501.1, 6503, and 6503.5; California Code of Regulations, title 2, sections 2000 and 2003.

**Public Trust and State's Best Interests Analysis:**

On May 5, 2008, the Commission authorized a Recreational Pier Lease for an existing pier and two mooring buoys to Suzanne Scharf, Trustee of the Suzanne Scharf Revocable Trust, dated June 1, 1995 ([Item C02, May 5, 2008](#)). That lease expires on December 14, 2017. On April 23, 2014, upland ownership was transferred out of the trust to Suzanne Scharf. The Applicant is now applying for a General Lease – Recreational Use for the continued use and maintenance of the existing pier and two mooring buoys.

The Applicant owns the upland adjoining the lease premises. The subject facilities are privately owned and maintained. The pier and two mooring buoys are used for the docking and mooring of boats and facilitate recreational boating. Recreational boating is a water depend-dependent use that is general consistent with the common law Public Trust Doctrine. The California Legislature has identified private recreational boating facilities as an authorized use of Public Trust land (Pub. Resources Code, § 6503.5).

The subject facilities have existed for many years at this location. The pier is built on pilings, which allows the public to navigate or walk next to and, at lower water levels, under the pier. The immediate area of the existing pier is gently sloped with cobblestones and pebbles. The two buoys are located directly lakeward of the upland property and occupy a relatively small area of the lake.

The proposed lease does not alienate the State's fee simple interest or permanently impair public rights. The lease is limited to a 10-year term, does not grant the lessee exclusive rights to the lease premises, and reserves an easement to the public for Public Trust-consistent uses. Upon termination of the lease, the lessee may be required to remove all improvements from State land.

STAFF REPORT NO. **C08** (CONT'D)

The proposed lease requires the lessee to insure the lease premises and indemnify the State for any liability incurred as a result of the lessee's activities thereon. The lease also requires the payment of annual rent to compensate the people of the State for the occupation of the public land involved. For all the reasons above, Commission staff believes the issuance of this lease is consistent with the common law Public Trust Doctrine and in the best interests of the State.

**OTHER PERTINENT INFORMATION:**

1. This action is consistent with Strategy 1.1 of the Commission's Strategic Plan to deliver the highest levels of public health and safety in the protection, preservation, and responsible economic use of the lands and resources under the Commission's jurisdiction, and Strategy 1.3 to promote, expand, and enhance appropriate public use and access to and along the State's inland and coastal waterways.
2. Staff recommends that the Commission find that this activity is exempt from the requirements of the California Environmental Quality Act (CEQA) as a categorically exempt project. The project is exempt under Class 1, Existing Facilities; California Code of Regulations, title 2, section 2905, subdivision (a)(2).

Authority: Public Resources Code section 21084 and California Code of Regulations, title 14, section 15300 and California Code of Regulations, title 2, section 2905.

3. This activity involves lands identified as possessing significant environmental values pursuant to Public Resources Code section 6370 et seq., but such activity will not affect those significant lands. Based upon staff's consultation with the persons nominating such lands and through the CEQA review process, it is staff's opinion that the project, as proposed, is consistent with its use classification.

**EXHIBITS:**

- A. Land Description
- B. Site and Location Map

**RECOMMENDED ACTION:**

It is recommended that the Commission:

**CEQA FINDING:**

Find that the activity is exempt from the requirements of CEQA pursuant to California Code of Regulations, title 14, section 15061 as a categorically

STAFF REPORT NO. **C08** (CONT'D)

exempt project, Class 1, Existing Facilities; California Code of Regulations, title 2, section 2905, subdivision (a)(2).

**PUBLIC TRUST AND STATE'S BEST INTERESTS:**

Find that the proposed lease will not substantially impair the public rights to navigation and fishing or substantially interfere with Public Trust needs and values at this location, at this time, and for the foreseeable term of the lease; is consistent with the common law Public Trust Doctrine; and is in the best interests of the State.

**SIGNIFICANT LANDS INVENTORY FINDING:**

Find that this activity is consistent with the use classification designated by the Commission for the land pursuant to Public Resources Code section 6370 et seq.

**AUTHORIZATION:**

Authorize issuance of a General Lease – Recreational Use to the Applicant beginning December 15, 2017, for a term of 10 years, for the continued use and maintenance of an existing pier and two mooring buoys as described in Exhibit A and shown on Exhibit B (for reference purposes only) attached and by this reference made a part hereof; annual rent in the amount of \$1,031, with an annual Consumer Price Index adjustment; and liability insurance in an amount no less than \$1,000,000 per occurrence.

**EXHIBIT A**

**PRC 3622.1**

**LAND DESCRIPTION**

Three parcels of submerged land situate in the bed of Lake Tahoe, lying adjacent to Lot 3 of fractional Section 1, Township 14 North, Range 16 East, MDM., as shown on Official Government Township Plat approved January 9, 1866, County of Placer, State of California, and more particularly described as follows:

**PARCEL 1 - PIER**

All those lands underlying portion of an existing pier lying adjacent to those parcels as described in Exhibit "A" of that Grant Deed recorded April 23, 2014 in Document Number 2014-0025685 in Official Records of said County.

TOGETHER WITH any applicable impact area(s).

EXCEPTING THEREFROM any portion(s) lying landward of elevation 6223 feet LTD on the shoreline of said Lake Tahoe.

**PARCELS 2 & 3 - BUOYS**

Two (2) circular parcels of land, each being 50 feet in diameter, underlying two (2) existing buoys lying adjacent to said parcels.

Accompanying plat is hereby made part of this description.

**END OF DESCRIPTION**

Prepared September 7, 2017 by the California State Lands Commission Boundary Unit.





LAKE TAHOE

6223± LTD

APPROXIMATE

APN 097-100-013

SHORELINE

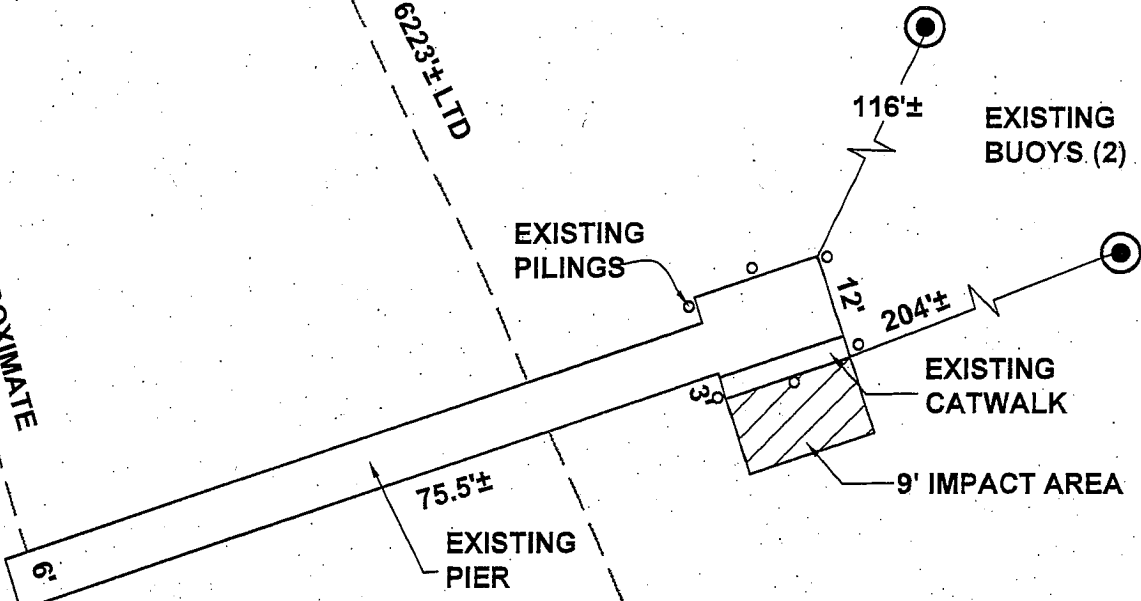

# EXHIBIT A

Page 2 of 2

MJJ 9/08/17

LAND DESCRIPTION PLAT  
 PRC 3622.1, SCHARF  
 PLACER COUNTY

CALIFORNIA STATE  
 LANDS COMMISSION



NO SCALE

# SITE

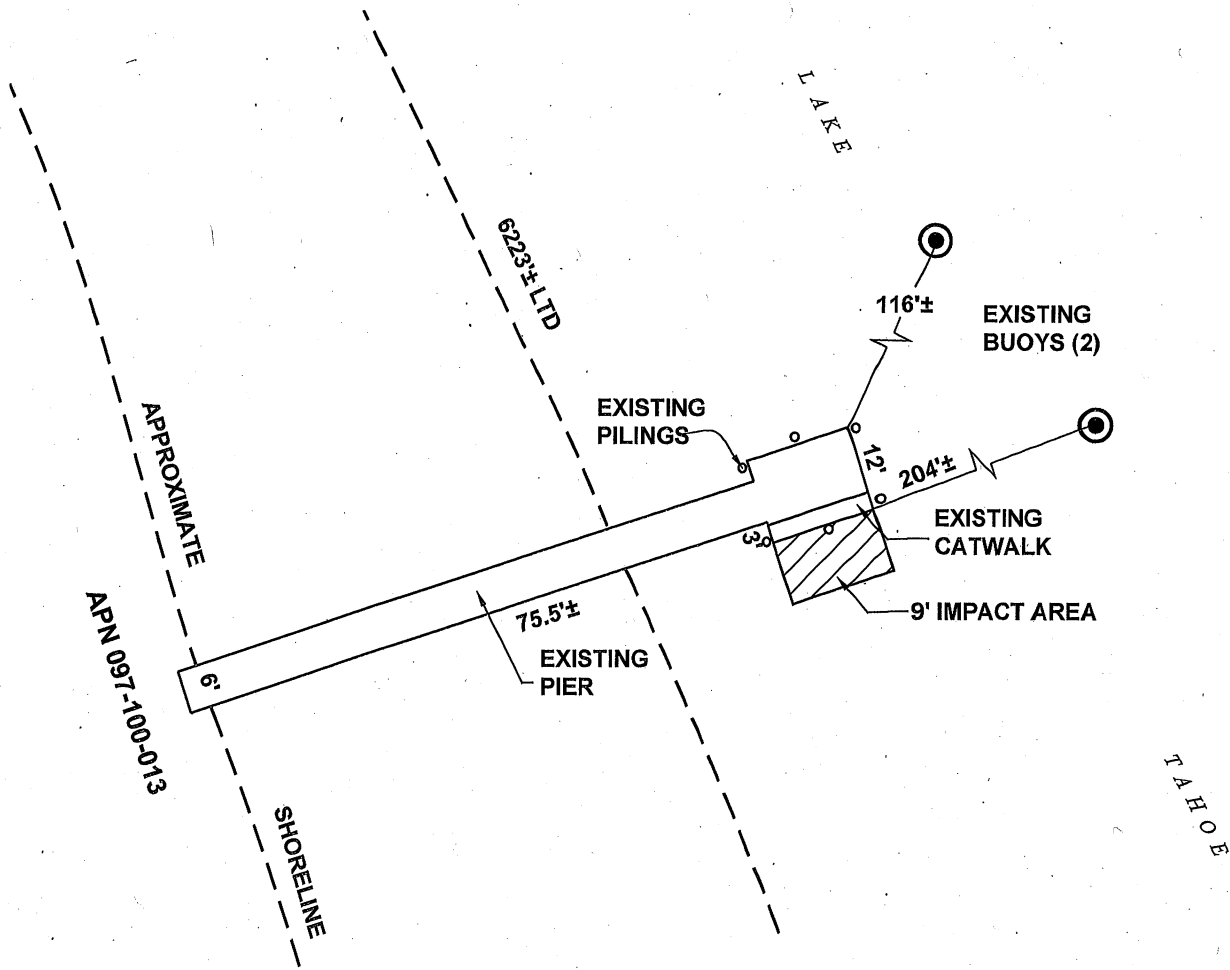

4910 W. LAKE BLVD., NEAR HOMEWOOD

NO SCALE

# LOCATION

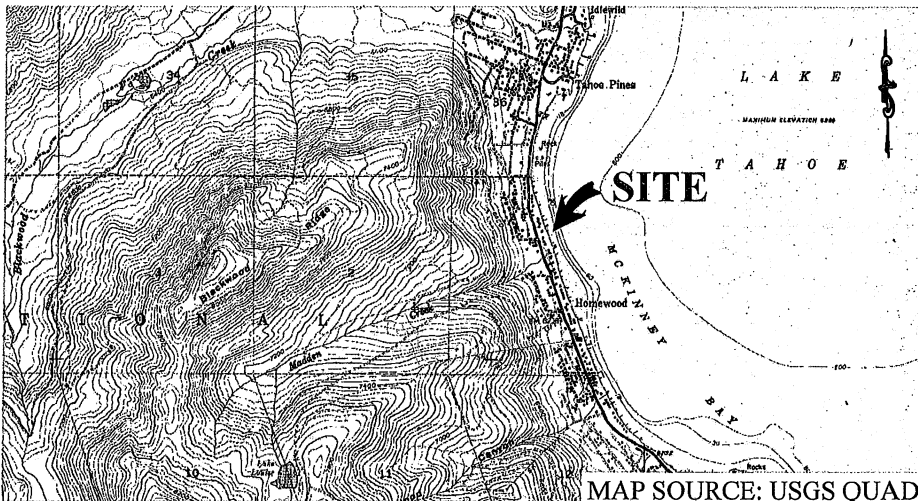

MAP SOURCE: USGS QUAD

## Exhibit B

PRC 3622.1  
 SCHARF  
 APN 097-100-013  
 GENERAL LEASE -  
 RECREATIONAL USE  
 PLACER COUNTY

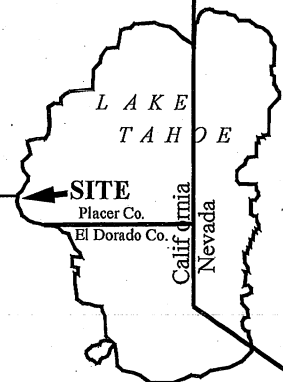

This Exhibit is solely for purposes of generally defining the lease premises, is based on unverified information provided by the Lessee or other parties and is not intended to be, nor shall it be construed as, a waiver or limitation of any State interest in the subject or any other property.