

**CALENDAR ITEM
C68**

A 33
S 16

06/22/17
PRC 8410.2
J. Toy

REVISION OF RENT

LESSEE:

United States of America, and its assigns, acting by and through the Bureau of Land Management

AREA, LAND TYPE, AND LOCATION:

Approximately 1.93 acres, more or less, of State-owned school land within a portion of Section 16, Township 7 North, Range 3 East, SBM, south of Newberry Springs, San Bernardino County.

AUTHORIZED USE:

Continued use, maintenance, and monitoring of approximately 4,200 linear feet of four-strand barbwire livestock fencing, with the bottom strand barbless, within a 20-foot wide corridor.

LEASE TERM:

10 years, beginning June 23, 2012.

CONSIDERATION:

This lease provides that the Commission may modify the rent periodically during the lease term. Pursuant to this provision, staff reviewed the rent under this lease and recommends that rent be revised from \$50 per year to \$208 per year for public agency use, effective June 23, 2017.

OTHER PERTINENT INFORMATION:

1. On June 23, 2012, the Commission authorized a General Lease – Public Agency Use to the United States of America, and its assigns, acting by and through the Bureau of Land Management for a term of 10 years beginning June 23, 2012 ([Calendar Item C92, April 26, 2013](#)). The lease will expire on June 22, 2022.
2. This action is consistent with Strategy 2.2 of the Commission's Strategic Plan to ensure timely receipt of revenues and royalties from the use and development of State lands and minerals.

CALENDAR ITEM NO. **C68** (CONT'D)

3. Approving the revision of rent is not a project as defined by the California Environmental Quality Act because it is an administrative action that will not result in direct or indirect physical changes in the environment.

Authority: Public Resources Code section 21065 and California Code of Regulations, title 14, section 15378, subdivision (b)(5).

EXHIBIT:

- A. Site and Location Map

RECOMMENDED ACTION:

It is recommended that the Commission:

AUTHORIZATION:

Approve the revision of rent for Lease No. PRC 8410.2 from \$50 per year to \$208 per year, effective June 23, 2017.

NO SCALE

SITE

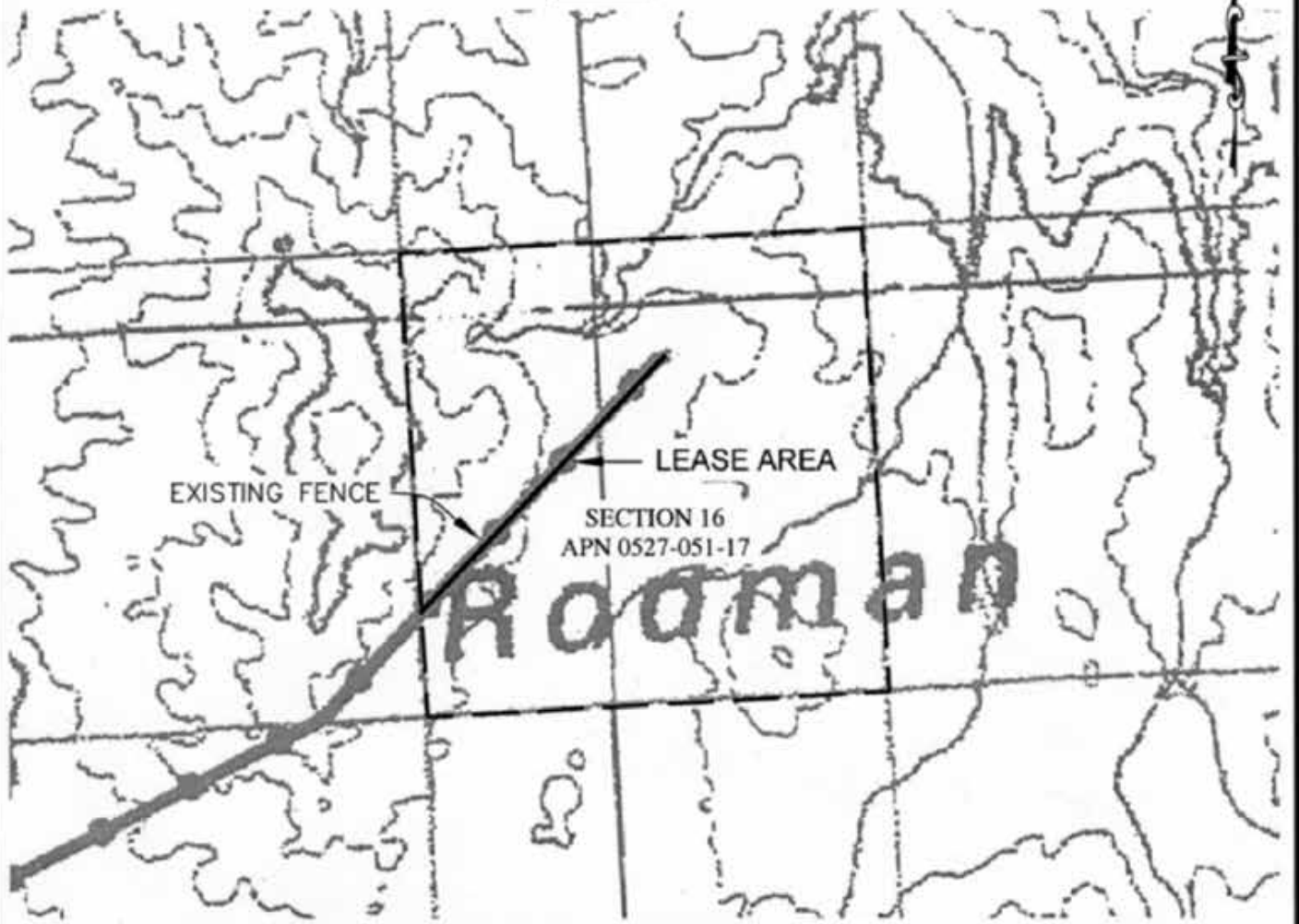

SCHOOL LANDS

SECTION 16, TOWNSHIP 7 NORTH, RANGE 3 EAST, SB.B.&M.

NO SCALE

LOCATION

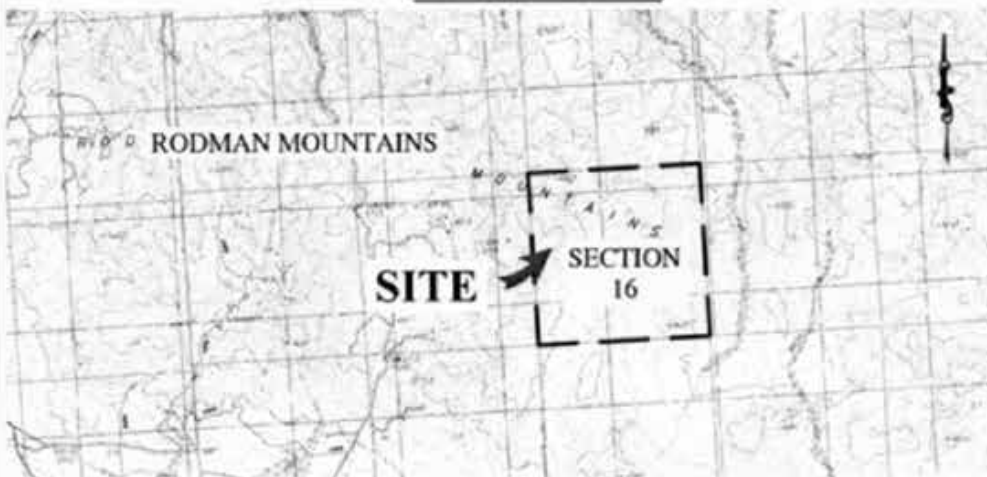

MAP SOURCE: USGS QUAD

Exhibit A

PRC 8410.2
 U.S. BUREAU OF LAND
 MANAGEMENT
 APN 0527-051-17
 MOU FOR BORDER FENCE
 SAN BERNARDINO COUNTY



This Exhibit is solely for purposes of generally defining the lease premises, is based on unverified information provided by the Lessee or other parties and is not intended to be, nor shall it be construed as, a waiver or limitation of any State interest in the subject or any other property.