

**CALENDAR ITEM
C65**

A 50
S 26

06/22/17
PRC 8465.1
J. Toy

REVISION OF RENT

LESSEE:

Bel-Air Bay Club, Ltd.

AREA, LAND TYPE, AND LOCATION:

Sovereign land in the Pacific Ocean, adjacent to 16801 Pacific Coast Highway, near Pacific Palisades, Los Angeles County.

AUTHORIZED USE:

Continued use and maintenance of three groins identified as Groins A, B, and C used for beach erosion control.

LEASE TERM:

20 years, beginning October 20, 2003.

CONSIDERATION:

This lease provides that the Commission may modify the rent periodically during the lease term. Pursuant to this provision, staff reviewed the rent under this lease and recommends that rent be revised from \$16,702 per year to \$18,276 per year, effective October 20, 2017.

OTHER PERTINENT INFORMATION:

1. Lessee owns the upland adjoining the lease premises.
2. On October 20, 2003, the Commission authorized a General Lease – Protective Structure Use to Bel-Air Bay Club, Ltd., for a term of 20 years beginning October 20, 2003 ([Calendar Item C64, October 20, 2003](#)). The lease will expire on October 19, 2023.
3. This action is consistent with Strategy 2.2 of the Commission's Strategic Plan to ensure timely receipt of revenues and royalties from the use and development of State lands and minerals.
4. Approving the revision of rent is not a project as defined by the California Environmental Quality Act because it is an administrative action that will not result in direct or indirect physical changes in the environment.

CALENDAR ITEM NO. **C65** (CONT'D)

Authority: Public Resources Code section 21065 and California Code of Regulations, title 14, section 15378, subdivision (b)(5).

EXHIBIT:

- A. Site and Location Map

RECOMMENDED ACTION:

It is recommended that the Commission:

AUTHORIZATION:

Approve the revision of rent for Lease No. PRC 8465.1 from \$16,702 per year to \$18,276 per year, effective October 20, 2017.

NO SCALE

SITE

PACIFIC COAST HWY.

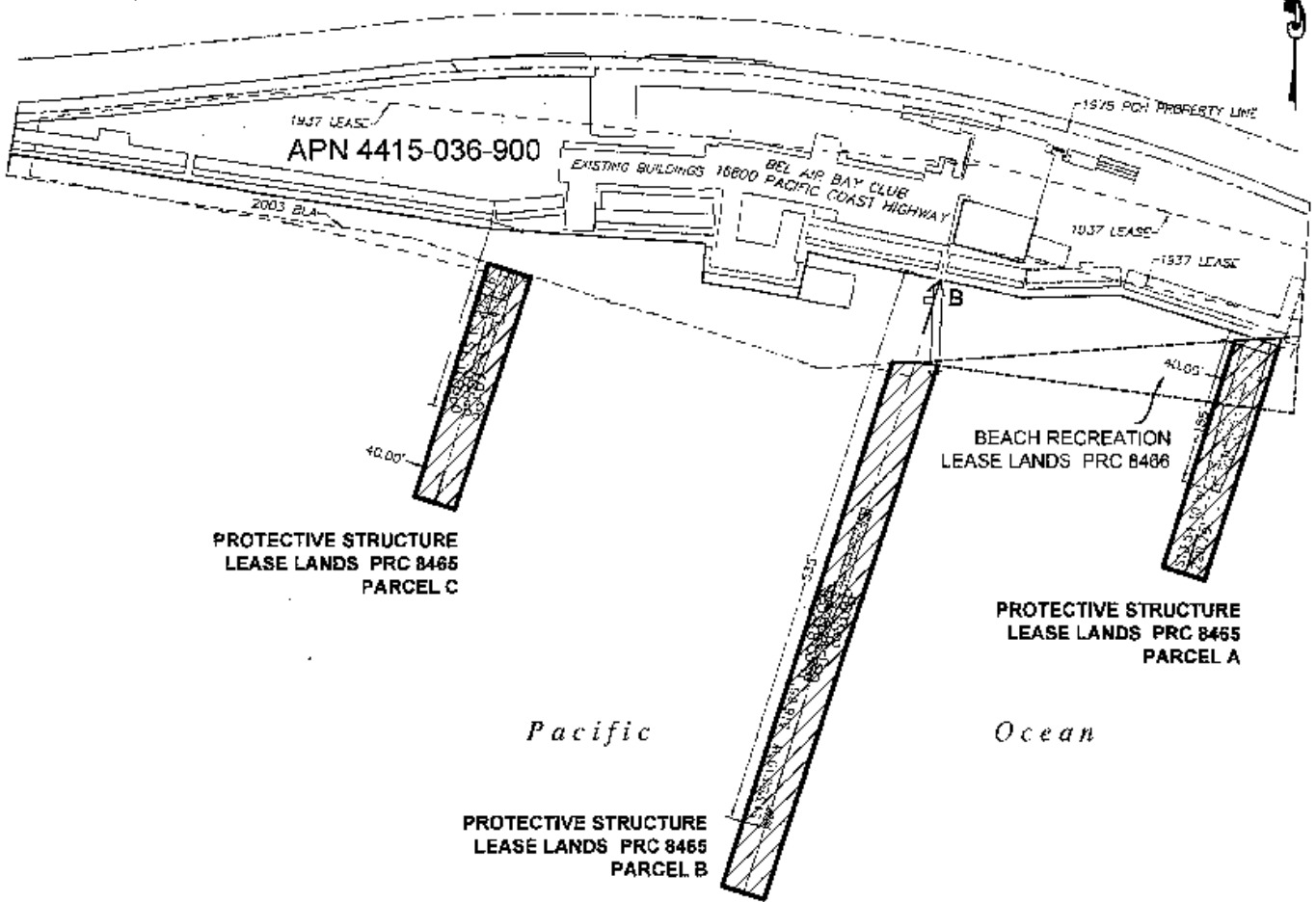

16801 PACIFIC COAST HWY., MALIBU

NO SCALE

LOCATION



MAP SOURCE: USGS QUAD

This Exhibit is solely for purposes of generally defining the lease premises, is based on unverified information provided by the Lessee or other parties and is not intended to be, nor shall it be construed as, a waiver or limitation of any State interest in the subject or any other property.

Exhibit A

PRC 8465.1
 BEL AIR BAY CLUB LTD
 APN 4415-036-900
 PROTECTIVE STRUCTURE
 LOS ANGELES COUNTY



MIT 09/13/12