

**CALENDAR ITEM
C40**

A 14
S 7

06/22/17
PRC 6090.1
J. Toy

REVISION OF RENT

LESSEE:

Larry M. McClure

AREA, LAND TYPE, AND LOCATION:

Sovereign land in Old River, adjacent to Eucalyptus Island, near Byron, Contra Costa County.

AUTHORIZED USE:

Continued use and maintenance of an existing fishing pier, breakwater structure, and submarine electrical cable.

LEASE TERM:

10 years, beginning August 14, 2012.

CONSIDERATION:

This lease provides that the Commission may modify the rent periodically during the lease term. Pursuant to this provision, staff reviewed the rent under this lease and recommends that rent be revised from \$157 per year to \$450 per year, effective August 14, 2017.

OTHER PERTINENT INFORMATION:

1. Lessee owns the upland adjoining the lease premises.
2. On August 14, 2012, the Commission authorized a General Lease – Recreational, Protective Structure, and Right-of-Way Use to Larry M. McClure for a term of 10 years beginning August 14, 2012 ([Calendar Item C26, August 14, 2012](#)). The lease will expire on August 13, 2022.
3. This action is consistent with Strategy 2.2 of the Commission’s Strategic Plan to ensure timely receipt of revenues and royalties from the use and development of State lands and minerals.
4. Approving the revision of rent is not a project as defined by the California Environmental Quality Act because it is an administrative action that will not result in direct or indirect physical changes in the environment.

CALENDAR ITEM NO. **C40** (CONT'D)

Authority: Public Resources Code section 21065 and California Code of Regulations, title 14, section 15378, subdivision (b)(5).

EXHIBIT:

- A. Site and Location Map

RECOMMENDED ACTION:

It is recommended that the Commission:

AUTHORIZATION:

Approve the revision of rent for Lease No. PRC 6090.1 from \$157 per year to \$450 per year, effective August 14, 2017.

NO SCALE

SITE

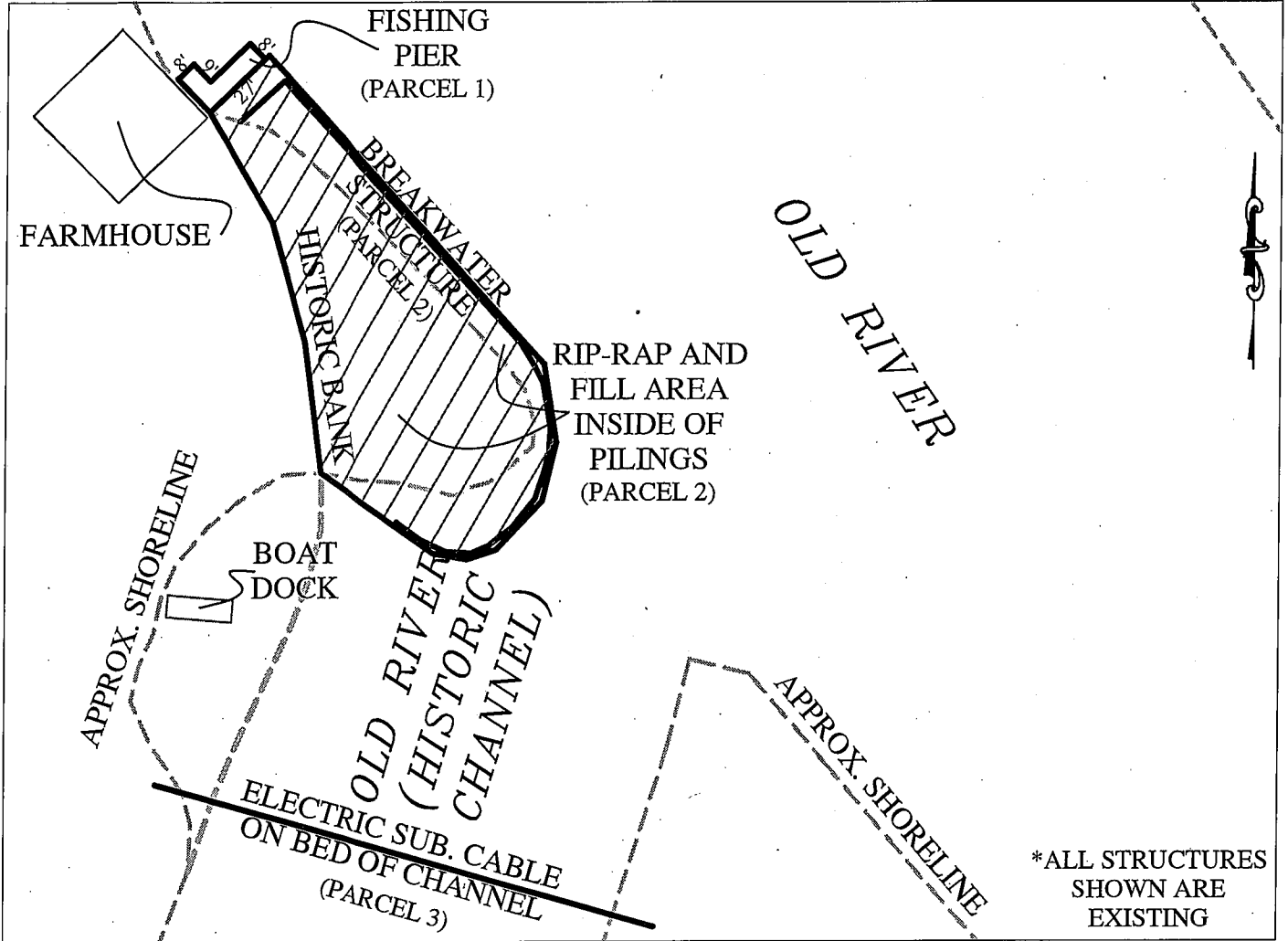

Old River, Byron

NO SCALE

LOCATION

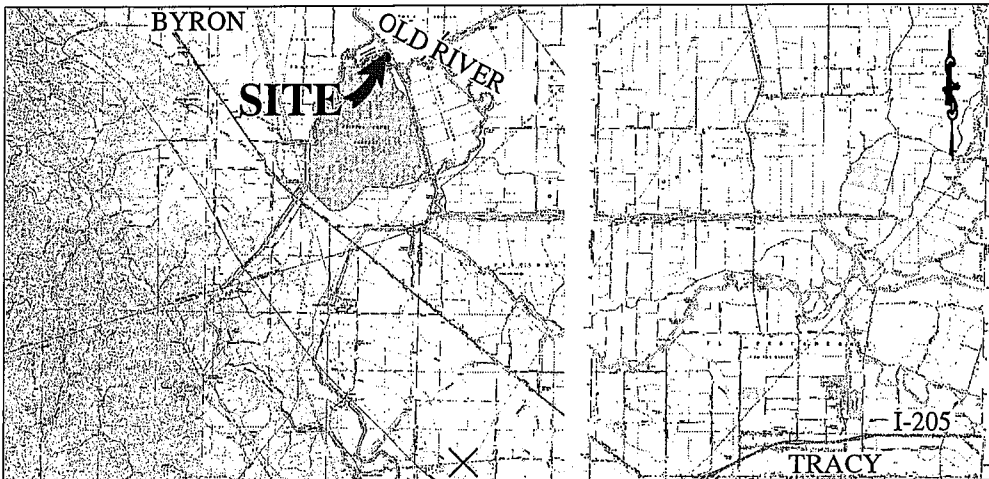

MAP SOURCE: USGS QUAD

Exhibit A

PRC 6090.1
 MCCLURE
 APN 001-101-001
 GENERAL LEASE - RECREATIONAL,
 PROTECTIVE STRUCTURE &
 RIGHT-OF-WAY USE
 CONTRA COSTA COUNTY



This Exhibit is solely for purposes of generally defining the lease premises, is based on unverified information provided by the Lessee or other parties and is not intended to be, nor shall it be construed as, a waiver or limitation of any State interest in the subject or any other property.