

**CALENDAR ITEM  
C82**

A 1  
S 1

06/28/16  
PRC 5391.2  
C. Hudson

**REVISION OF RENT**

**LESSEE:**

Pacific Gas and Electric Company  
1850 Gateway Blvd., 7th Floor  
Concord, CA 94520

**AREA, LAND TYPE, AND LOCATION:**

6.8 acres, more or less, of State-owned school land located within a portion of Section 16, Township 35 North, Range 5 East, MDM, near Fall River Mills, Shasta County.

**AUTHORIZED USE:**

Continued use and maintenance of an existing 60 kV electric transmission line.

**LEASE TERM:**

49 years, beginning October 27, 1976.

**CONSIDERATION:**

This lease provides that Lessor may modify the rent periodically during the lease term. Pursuant to this provision, staff has conducted a review of the rent under this lease and recommends that rent be revised from \$306 per year to \$673 per year, effective October 27, 2016.

**OTHER PERTINENT INFORMATION:**

1. On September 29, 1977, the Commission authorized the issuance of General Lease – Right-of-Way Use, PRC 5391.2 to Pacific Gas and Electric Company for an existing 60 kV electric transmission line. The lease will expire on October 26, 2025.
2. Staff conducted the rent review called for in the lease and recommends that the rent be increased to \$673 per year, effective October 27, 2016.

CALENDAR ITEM NO. **C82** (CONT'D)

3. This action is consistent with Strategy 2.2 of the Commission's Strategic Plan, by ensuring timely receipt of revenues from the use of State lands.
4. Approving the revision of rent is not a project as defined by the California Environmental Quality Act because it is an administrative action that will not result in direct or indirect physical changes in the environment.

Authority: Public Resources Code section 21065 and California Code of Regulations, Title 14, section 15378, subdivision (b)(5).

**EXHIBIT:**

- A. Site and Location Map

**RECOMMENDED ACTION:**

It is recommended that the Commission:

**AUTHORIZATION:**

Approve the revision of rent for Lease No. PRC 5391.2 from \$306 per year to \$673 per year, effective October 27, 2016.

NO SCALE

# SITE

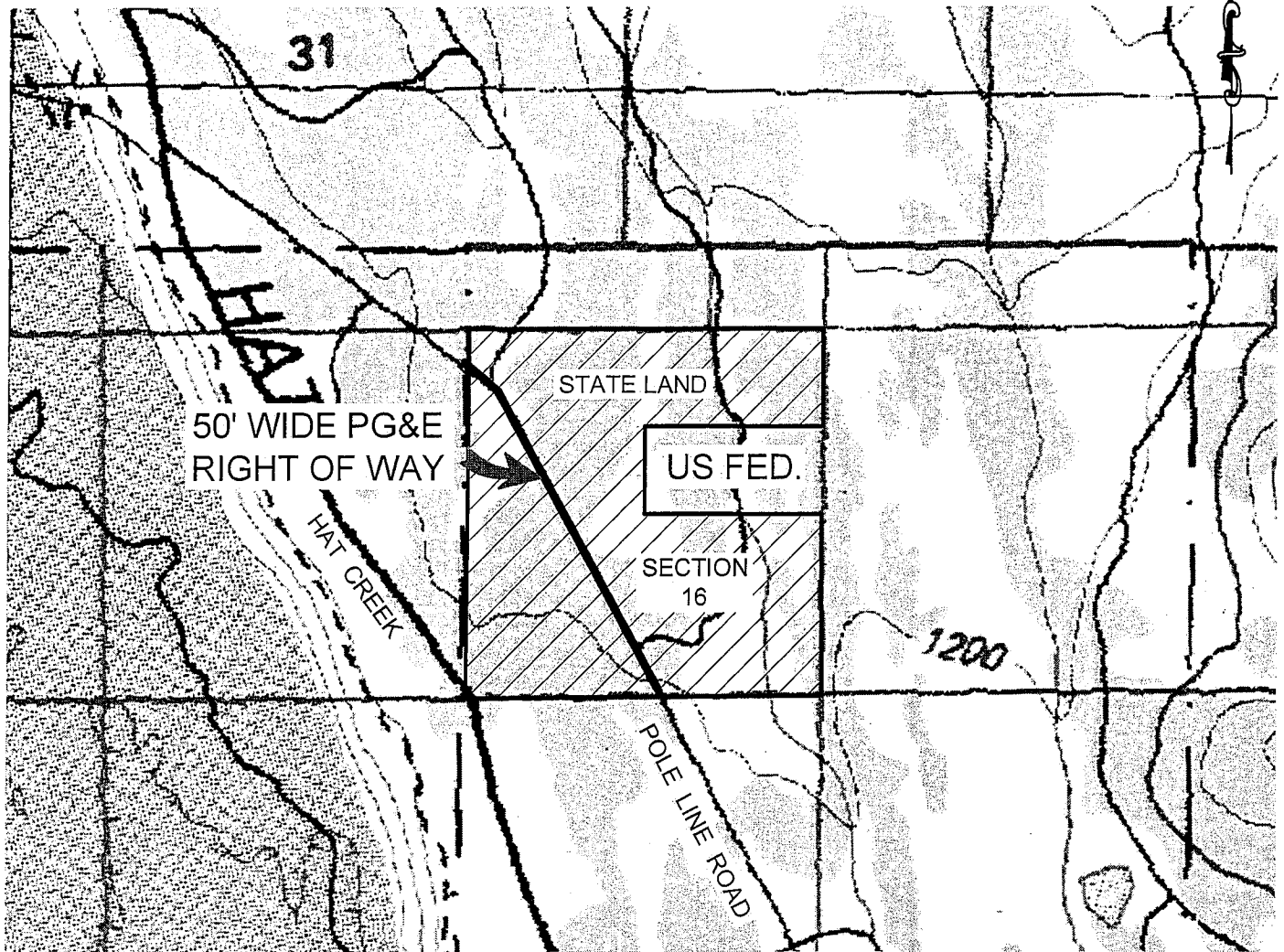

SECTION 16, T35N, R5E, MDM NEAR FALL RIVER MILLS

NO SCALE

# LOCATION

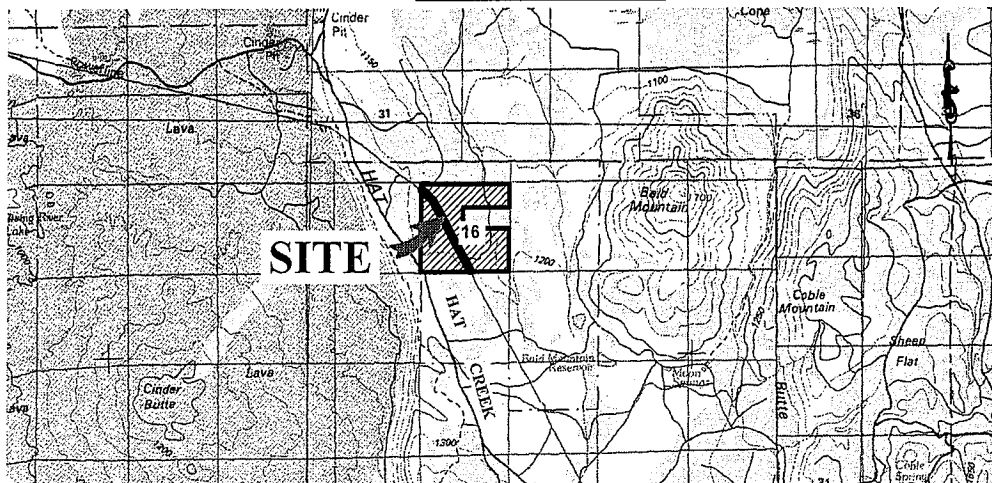

MAP SOURCE: USGS QUAD

## Exhibit A

PRC 5391.2  
 PACIFIC GAS & ELECTRIC CO.  
 GENERAL LEASE -  
 RIGHT-OF-WAY USE  
 SHASTA COUNTY



This Exhibit is solely for purposes of generally defining the lease premises, is based on unverified information provided by the Lessee or other parties and is not intended to be, nor shall it be construed as, a waiver or limitation of any State interest in the subject or any other property.