

**CALENDAR ITEM
C18**

A 5
S 1

04/05/16
PRC 3551.1
M. Schroeder

GENERAL LEASE – RECREATIONAL USE

APPLICANT:

Stephen Roy Miller and Terry P. Miller, as Trustees of the Stephen Roy Miller 1982 Trust

PROPOSED LEASE:

AREA, LAND TYPE, AND LOCATION:

Sovereign land located in Lake Tahoe, adjacent to 235 Drum Road, near Meeks Bay, El Dorado County.

AUTHORIZED USE:

Continued use and maintenance of an existing pier, boathouse with a boat lift, and two mooring buoys.

LEASE TERM:

10 years, beginning June 1, 2016.

CONSIDERATION:

\$1,307 per year, with an annual Consumer Price Index adjustment.

SPECIFIC LEASE PROVISIONS:

Liability insurance in an amount no less than \$1,000,000 per occurrence.

If Lessee does not have valid Tahoe Regional Planning Agency (TRPA) buoy permits, Lessee is required to obtain such authorization for the mooring buoys within two years after the adoption of a Final Environmental Impact Statement (FEIS) for the Lake Tahoe Shorezone Ordinance Amendments and approval of the amended ordinances. If Lessee is unable to obtain such authorization within the time limit, they must remove the buoys.

Lessee expressly acknowledges and agrees that issuance of a lease does not substitute for, or provide preference in, obtaining authorizations from TRPA or any other regulatory agency for the improvements authorized by the Commission.

CALENDAR ITEM NO. **C18** (CONT'D)

STAFF ANALYSIS AND RECOMMENDATION:

Statutory Authority:

Public Resources Code sections 6005, 6216, 6301, and 6503.5; California Code of Regulations, Title 2, section 2000, subdivision (b).

Public Trust and State's Best Interests Analysis:

The subject facilities are for the docking and mooring of boats. Recreational boating is a water-dependent use that is generally consistent with the common law public trust doctrine. The California Legislature has identified private recreational boating facilities as an authorized use of public trust lands (Pub. Resources Code § 6503.5).

The subject facilities have existed for many years at this location. The pier is built on a gently sloped part of the shore consisting of sand and cobbles. The upland houses are on large lots. The topography and upland structures provide ample space for both the pier and other trust activities. Construction of the pier allows the public to walk or navigate under or around the pier. The buoys are located directly lakeward of the upland property and occupy a relatively small area of the lake.

The proposed lease does not alienate the State's fee simple interest or permanently impair public rights. The lease is limited to a 10-year term, does not grant the Lessee exclusive rights to the lease premises, and reserves an easement to the public for access to and across the lease premises. Upon termination of the lease, the Lessee may be required to remove all improvements from State land.

The proposed lease requires the Lessee to insure the lease premises and indemnify the State for any liability incurred as a result of the Lessee's activities thereon. The lease also requires the payment of annual rent to compensate the people of the State for the use of public land. For all the reasons above, Commission staff believes the issuance of this lease is consistent with the common law public trust doctrine, will not substantially interfere with the public trust needs at this location, at this time, and for the foreseeable term of the proposed lease, and is in the best interests of the State.

OTHER PERTINENT INFORMATION:

1. The Applicant owns the upland adjoining the lease premises.
2. On June 26, 2006, the Commission authorized a 10-year Recreational Pier Lease to Nancy Shurtleff Miller and Stephen Roy Miller, Trustees of the Miller 2003 B Trust. That lease will expire on May 31, 2016.

CALENDAR ITEM NO. **C18** (CONT'D)

Ownership of the upland parcel has since been deeded to Stephen Roy Miller and Terry P. Miller, as Trustees of The Stephen Roy Miller 1982 Trust. The Applicant is now applying for a General Lease – Recreational Use.

3. This action is consistent with Strategy 1.1 of the Commission's Strategic Plan to deliver the highest levels of public health and safety in the protection, preservation, and responsible economic use of the lands and resources under the Commission's jurisdiction and Strategy 1.3 to promote, expand, and enhance appropriate public use and access to and along the State's inland and coastal waterways.
4. The staff recommends that the Commission find that this activity is exempt from the requirements of the California Environmental Quality Act (CEQA) as a categorically exempt project. The project is exempt under Class 1, Existing Facilities; California Code of Regulations, Title 2, section 2905, subdivision (a)(2).

Authority: Public Resources Code section 21084 and California Code of Regulations, Title 14, section 15300 and California Code of Regulations, Title 2, section 2905.

5. This activity involves lands identified as possessing significant environmental values pursuant to Public Resources Code section 6370 et seq., but such activity will not affect those significant lands. Based upon the staff's consultation with the persons nominating such lands and through the CEQA review process, it is the staff's opinion that the project, as proposed, is consistent with its use classification.

EXHIBITS:

- A. Land Description
- B. Site and Location Map

RECOMMENDED ACTION:

It is recommended that the Commission:

CEQA FINDING:

Find that the activity is exempt from the requirements of CEQA pursuant to California Code of Regulations, Title 14, section 15061 as a categorically exempt project, Class 1, Existing Facilities; California Code of Regulations, Title 2, section 2905, subdivision (a)(2).

CALENDAR ITEM NO. **C18** (CONT'D)

PUBLIC TRUST AND STATE'S BEST INTERESTS:

Find that the proposed lease will not substantially interfere with the public's public trust needs and values at this location, is consistent with the common law public trust doctrine, and is in the best interests of the State.

SIGNIFICANT LANDS INVENTORY FINDING:

Find that this activity is consistent with the use classification designated by the Commission for the land pursuant to Public Resources Code section 6370 et seq.

AUTHORIZATION:

Authorize issuance of a General Lease – Recreational Use to Stephen Roy Miller and Terry P. Miller, as Trustees of the Stephen Roy Miller 1982 Trust, beginning June 1, 2016, for a term of 10 years, for the continued use and maintenance of an existing pier, boathouse with boat lift, and two mooring buoys as described in Exhibit A and shown on Exhibit B (for reference purposes only) attached and by this reference made a part hereof; annual rent in the amount of \$1,307 with an annual Consumer Price Index adjustment; and liability insurance in an amount no less than \$1,000,000 per occurrence.

EXHIBIT A

PRC 3551.1

LAND DESCRIPTION

Three parcels of submerged lands situated in the bed of Lake Tahoe, lying adjacent to Lot 1 of fractional Section 20, Township 14 North, Range 17 East, M.D.B.&M., as shown on Official Government Township Plat approved January 17, 1866, County of El Dorado, State of California, more particularly described as follows:

PARCEL 1 - PIER

All those lands underlying an existing pier, three catwalks and boathouse with a boat lift lying adjacent to those parcels described in Exhibit "A" of Grant Deed recorded February 11, 2014 in Document Number 2014-0005654-00 in Official Records of said El Dorado County.

TOGETHER WITH any applicable Impact Area(s).

EXCEPTING THEREFROM any portion lying landward of elevation 6223 feet LTD on the shoreline of said Lake Tahoe.

PARCEL 2 & 3 – BUOYS

Two circular parcels of land, each being 50 feet in diameter, underlying two existing buoys lying adjacent to those parcels described in Exhibit "A" of Grant Deed recorded February 11, 2014 in Document Number 2014-0005654-00 in Official Records of said El Dorado County.

Accompanying plat is hereby made part of this description.

END OF DESCRIPTION

Prepared 08/12/2015 by the California State Lands Commission Boundary Unit.



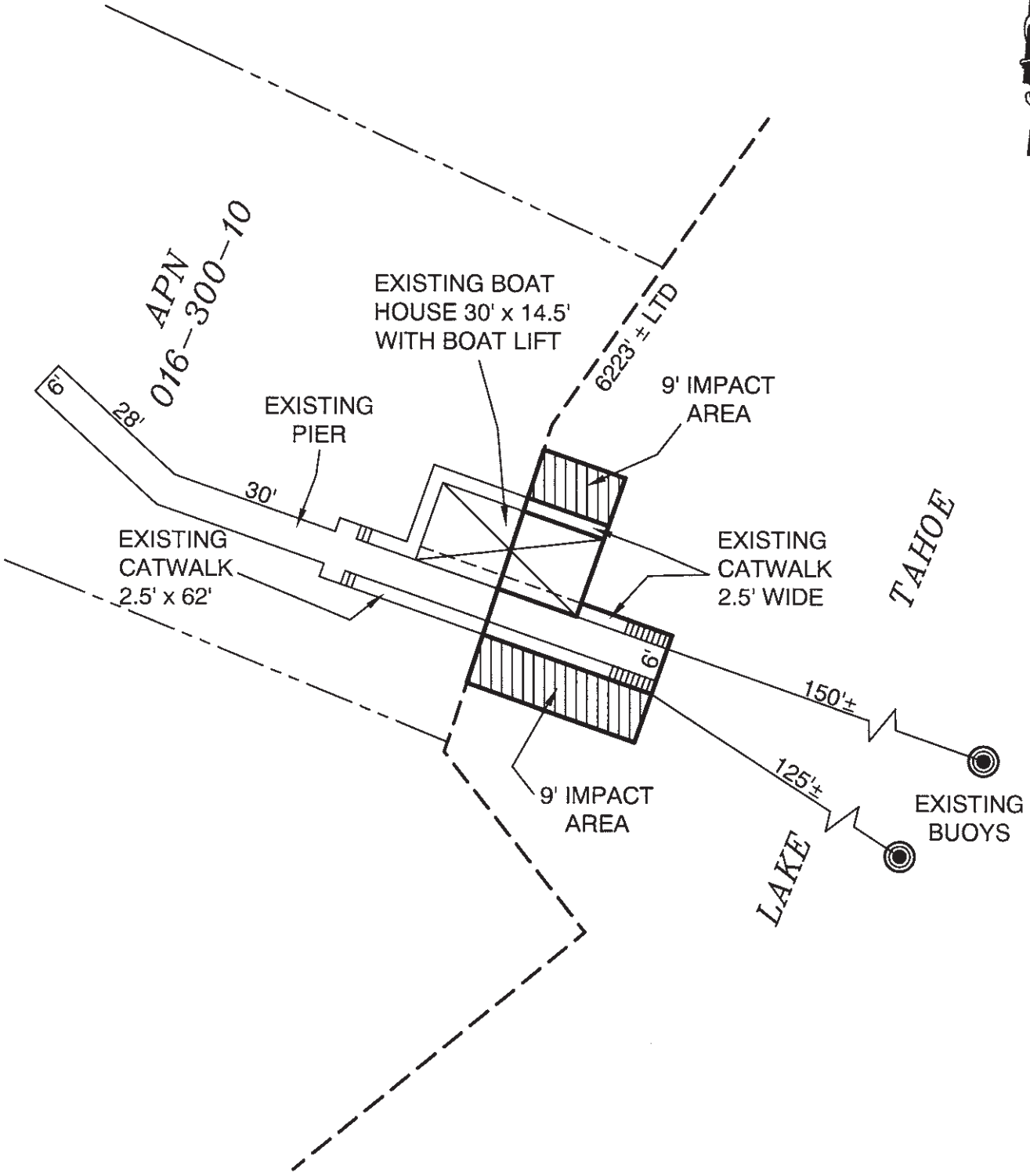

EXHIBIT A

LAND DESCRIPTION PLAT
 PRC 3551.1, MILLER TRUST
 EL DORADO COUNTY

CALIFORNIA STATE
 LANDS COMMISSION



NO SCALE

SITE

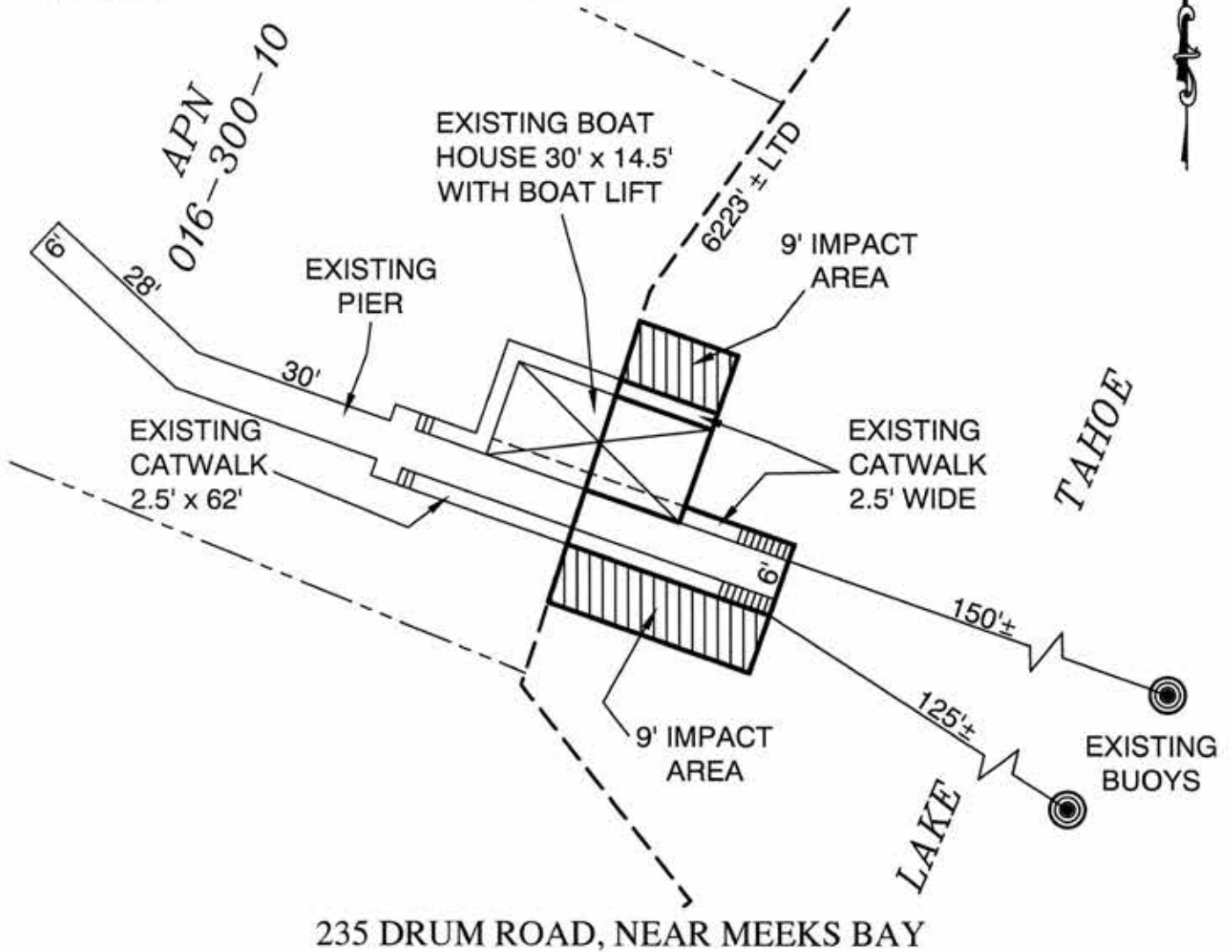

NO SCALE

LOCATION

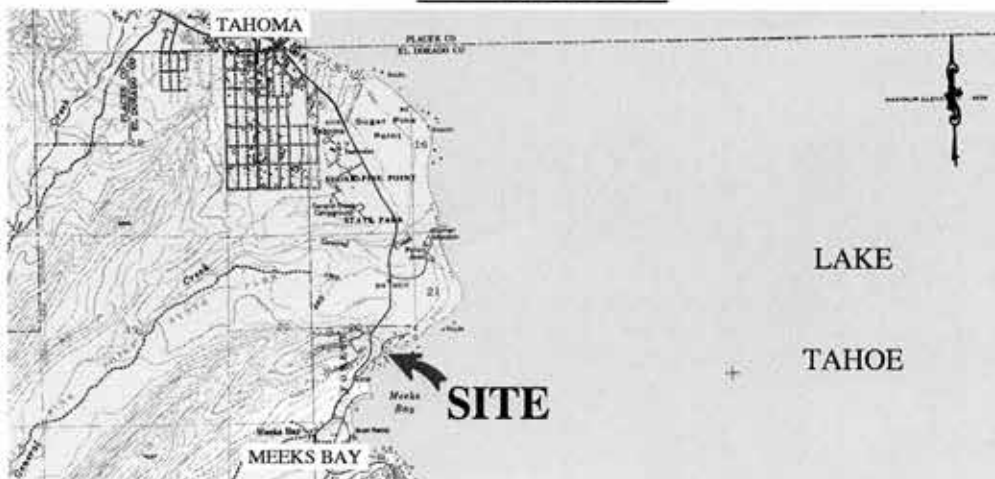

MAP SOURCE: USGS QUAD

Exhibit B

PRC 3551.1
 MILLER TRUST
 APN 016-300-10
 GENERAL LEASE -
 RECREATIONAL USE
 EL DORADO COUNTY



TS 08/12/15

This Exhibit is solely for purposes of generally defining the lease premises, is based on unverified information provided by the Lessee or other parties and is not intended to be, nor shall it be construed as, a waiver or limitation of any State interest in the subject or any other property.