

**CALENDAR ITEM
C53**

A 80
S 37

12/05/12
PRC 6406.1
S. Guerrieri

CONTINUATION OF RENT

LESSEE:

San Diego Gas and Electric Company
P.O. Box 1831
San Diego, CA 92112

AREA, LAND TYPE, AND LOCATION:

0.459 acres, more or less, of sovereign land in the Colorado River, near the town of Bard and downriver of Laguna Dam, Imperial County

AUTHORIZED USE:

Continued operation and maintenance of a 500KV overhead electrical transmission line across the Colorado River. The electrical transmission line is part of a larger facility known as the Southwest Powerlink, which is an interconnection facility between California and Arizona.

LEASE TERM:

49 years, beginning March 15, 1983.

CONSIDERATION:

This lease provides that Lessor may modify the rent periodically during the lease term. Pursuant to this provision, staff has conducted a review of the rent under this lease, and recommends that rent be continued at \$100 per year, effective March 15, 2013.

EXHIBIT:

A. Site and Location Map

OTHER PERTINENT INFORMATION

1. On April 28, 1983, the Commission approved issuance of a General Lease Right-of-Way Use for a 49-year term beginning March 15, 1983 to San Diego Gas and Electric Company for the use and maintenance of a 500kv overhead electrical transmission line.

Authority: Public Resources Code section 21065 and California Code of Regulations, Title 14, sections 15060, subdivision (c)(3), and 15378.

CALENDAR ITEM NO. **C53** (CONT'D)

2. The staff recommends that the Commission find that the subject revision of rent does not have a potential for resulting in either a direct or a reasonably foreseeable indirect physical change in the environment, and is, therefore, not a project in accordance with the California Environmental Quality Act (CEQA).

RECOMMENDED ACTION:

It is recommended that the Commission:

CEQA FINDING:

Find that the subject revision of rent is not subject to the requirements of CEQA pursuant to California Code of Regulations, Title 14, section 15060, subdivision (c)(3), because the subject activity is not a project as defined by Public Resources Code section 21065 and California Code of Regulations, Title 14, section 15378.

AUTHORIZATION:

Approve the continuation of rent for Lease No. PRC 6406.1 at \$100 per year, effective March 15, 2013.

NO SCALE

SITE

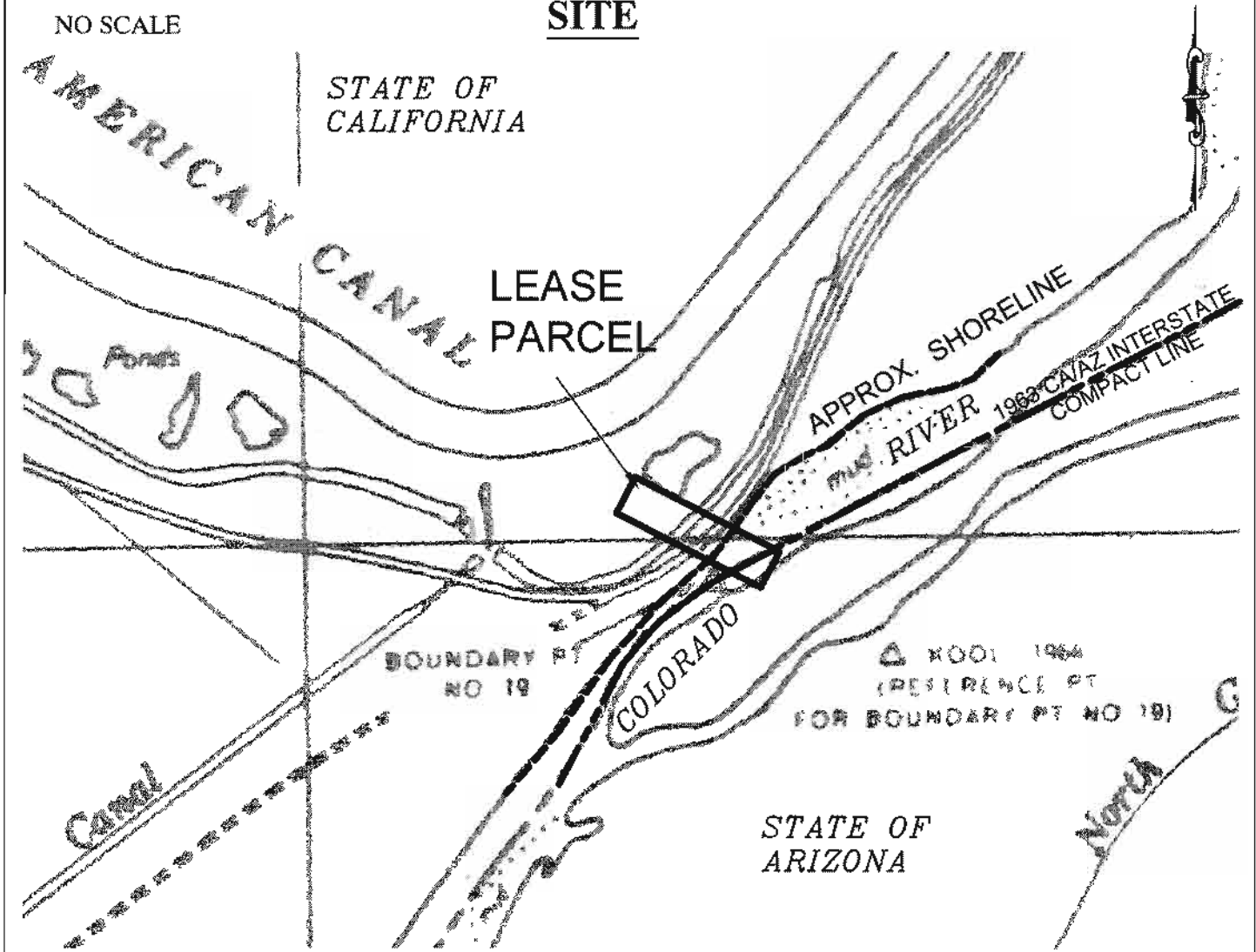

NORTHEAST OF THE TOWN OF BARD, COLORADO RIVER

NO SCALE

LOCATION



MAP SOURCE: USGS QUAD

Exhibit A

PRC 6406.1
 SAN DIEGO GAS &
 ELECTRIC CO.
 GENERAL LEASE -
 RIGHT-OF-WAY USE
 IMPERIAL COUNTY



This Exhibit is solely for purposes of generally defining the lease premises, is based on unverified information provided by the Lessee or other parties and is not intended to be, nor shall it be construed as, a waiver or limitation of any State interest in the subject or any other property.