

**CALENDAR ITEM
C06**

A 4
S 1

10/19/12
PRC 5123.9
R. Barham

GENERAL LEASE – RECREATIONAL USE

APPLICANTS:

Leland C. Nelson and Lois M. Nelson, Trustees of the Leland C. and Lois M. Nelson Trust dated January 25, 1990

AREA, LAND TYPE, AND LOCATION:

Sovereign land in Lake Tahoe, adjacent to 5256 North Lake Boulevard, near Carnelian Bay, Placer County.

AUTHORIZED USE:

Continued use and maintenance of an existing pier and one mooring buoy.

LEASE TERM:

10 years, beginning October 19, 2012.

CONSIDERATION:

No monetary consideration pursuant to Public Resources Code section 6503.5.

SPECIFIC LEASE PROVISIONS:

Insurance:

Liability insurance in the amount of no less than \$1,000,000.

Other:

The proposed lease contains a provision requiring the Applicants to obtain authorization from the Tahoe Regional Planning Agency (TRPA) for the mooring buoy within two years of the adoption of a Final Environmental Impact Statement (FEIS) for the Lake Tahoe Shorezone Ordinance Amendments and approval of the amended ordinances. This is a continuation of the process the Commission used from approximately 1995 to October 2008 when TRPA adopted an FEIS and Ordinance Amendments supported by the FEIS. In September 2010, the U.S. District Court invalidated the FEIS and nullified the Amendments. When additional information is available, Commission staff will advise the Commission on any suggested modifications to the process used by the Commission pending resolution of the TRPA FEIS and ordinance issues.

OTHER PERTINENT INFORMATION:

1. Applicants own the upland parcel adjoining the lease premises.

CALENDAR ITEM NO. **C06** (CONT'D)

2. On February 8, 2000, the Commission authorized a Recreational Pier Lease with Leland C. Nelson and Lois M. Nelson, Trustees of the Leland C. Nelson and Lois M. Nelson trust dated January 25, 1990, for an existing pier, boat lift, and one mooring buoy. That lease expired on November 14, 2009. Applicants are now applying for a new General Lease - Recreational Use.
3. On October 8, 2011, Chapter 585, Statutes of 2011 became law. The law took effect on January 1, 2012. This new law repeals section 6503.5 of the Public Resources Code, which had allowed rent-free use of State-owned land by certain private parties for their recreational piers. It replaced the former section with a new section 6503.5 which provides that the State Lands Commission "shall charge rent for a private recreational pier constructed on state lands." The law provides for two exceptions to the imposition of rent. Those exceptions are for:
 - A. A lease in effect on July 1, 2011 through the remaining term of that lease. If a lease in effect on July 1, 2011 expires or is otherwise terminated, any new lease will be subject to rent; and
 - B. A lease for which the lease application and application fees were submitted to the Commission prior to March 31, 2011.

Because the application was submitted to the Commission prior to March 31, 2011, the lease meets the statutory requirements for an exception to recently-enacted changes to Section 6503.5 of the Public Resources Code for the term of this lease.

4. Staff has confirmed that the previously authorized boat lift is not located on State sovereign land. Therefore, staff recommends bringing only the pier and one mooring buoy under lease.
5. The staff recommends that the Commission find that this activity is exempt from the requirements of CEQA as a categorically exempt project. The project is exempt under Class 1, Existing Facilities; California Code of Regulations, Title 2, section 2905, subdivision (a)(2).

Authority: Public Resources Code section 21084 and, California Code of Regulations, Title 14, section 15300 and, California Code of Regulations, Title 2, section 2905.

6. This activity involves lands identified as possessing significant environmental values pursuant to Public Resources Code section 6370 et

CALENDAR ITEM NO. **C06** (CONT'D)

seq., but such activity will not affect those significant lands. Based upon the staff's consultation with the persons nominating such lands and through the CEQA review process, it is the staff's opinion that the project, as proposed, is consistent with its use classification.

EXHIBITS:

- A. Land Description
- B. Site and Location Map

RECOMMENDED ACTION:

It is recommended that the Commission:

CEQA FINDING:

Find that the activity is exempt from the requirements of CEQA pursuant to California Code of Regulations, Title 14, section 15061 as a categorically exempt project, Class 1, Existing Facilities; California Code of Regulations, Title 2, section 2905, subdivision (a)(2).

SIGNIFICANT LANDS INVENTORY FINDING:

Find that this activity is consistent with the use classification designated by the Commission for the land pursuant to Public Resources Code section 6370 et seq.

AUTHORIZATION:

Authorize issuance of a General Lease – Recreational Use to Leland C. Nelson and Lois M. Nelson, Trustees of the Leland C. Nelson and Lois M. Nelson Trust dated January 25, 1990, beginning October 19, 2012, for a term of 10 years, for the continued use and maintenance of a pier and one mooring buoy described in Exhibit A and shown on Exhibit B (for reference purposes only) attached and by this reference made a part hereof; no monetary consideration pursuant to Public Resources Code section 6503.5; and liability insurance in the amount of no less than \$1,000,000.

EXHIBIT A

PRC 5123.9

LAND DESCRIPTION

Two (2) parcels of submerged land, situate in the bed of Lake Tahoe, lying adjacent to fractional Section 22, Township 16 North, Range 17 East, MDM, as shown on the Official Township Plat, approved November 9th, 1865, County of Placer, State of California, and more particularly described as follows:

Parcel 1 - Pier

All those lands underlying an existing pier adjacent to that Parcel as described in "Exhibit A" of that Grant Deed recorded February 14th, 1990 as Book 3829 Page 177 in Official Records of said County.

TOGETHER WITH a ten (10) foot impact area.

EXCEPTING THEREFROM any portion lying landward of the elevation of 6223 feet LTD along the shoreline of Lake Tahoe.

Parcel 2 - Buoy

A circular parcel of land, being 50 feet in diameter, underlying an existing buoy, adjacent to that Parcel as described in "Exhibit A" of that Grant Deed recorded February 14th, 1990 as Book 3829 Page 177 in Official Records of said County.

Accompanying plat is hereby made a part of this description.

END OF DESCRIPTION

PREPARED 9/19/12 BY THE CALIFORNIA STATE LANDS COMMISSION BOUNDARY UNIT

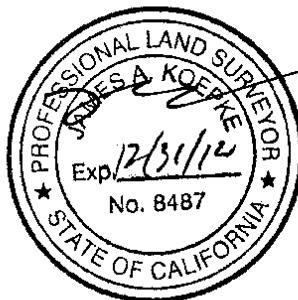

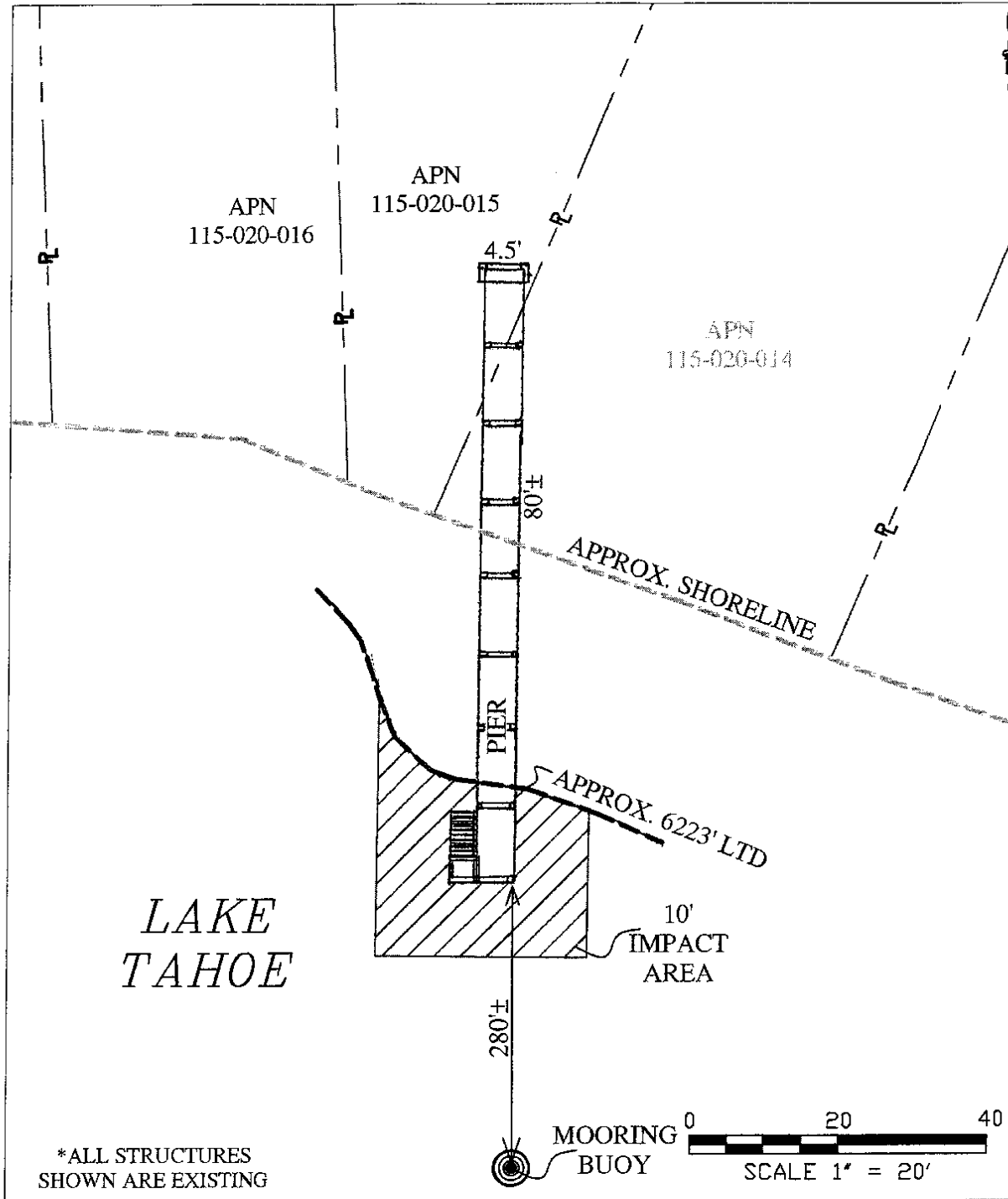

EXHIBIT A

Page 2 of 2

MJF 9/19/12

LAND DESCRIPTION PLAT
 PRC 5123.9 - NELSON
 PLACER COUNTY

CALIFORNIA STATE
 LANDS COMMISSION



NO SCALE

SITE

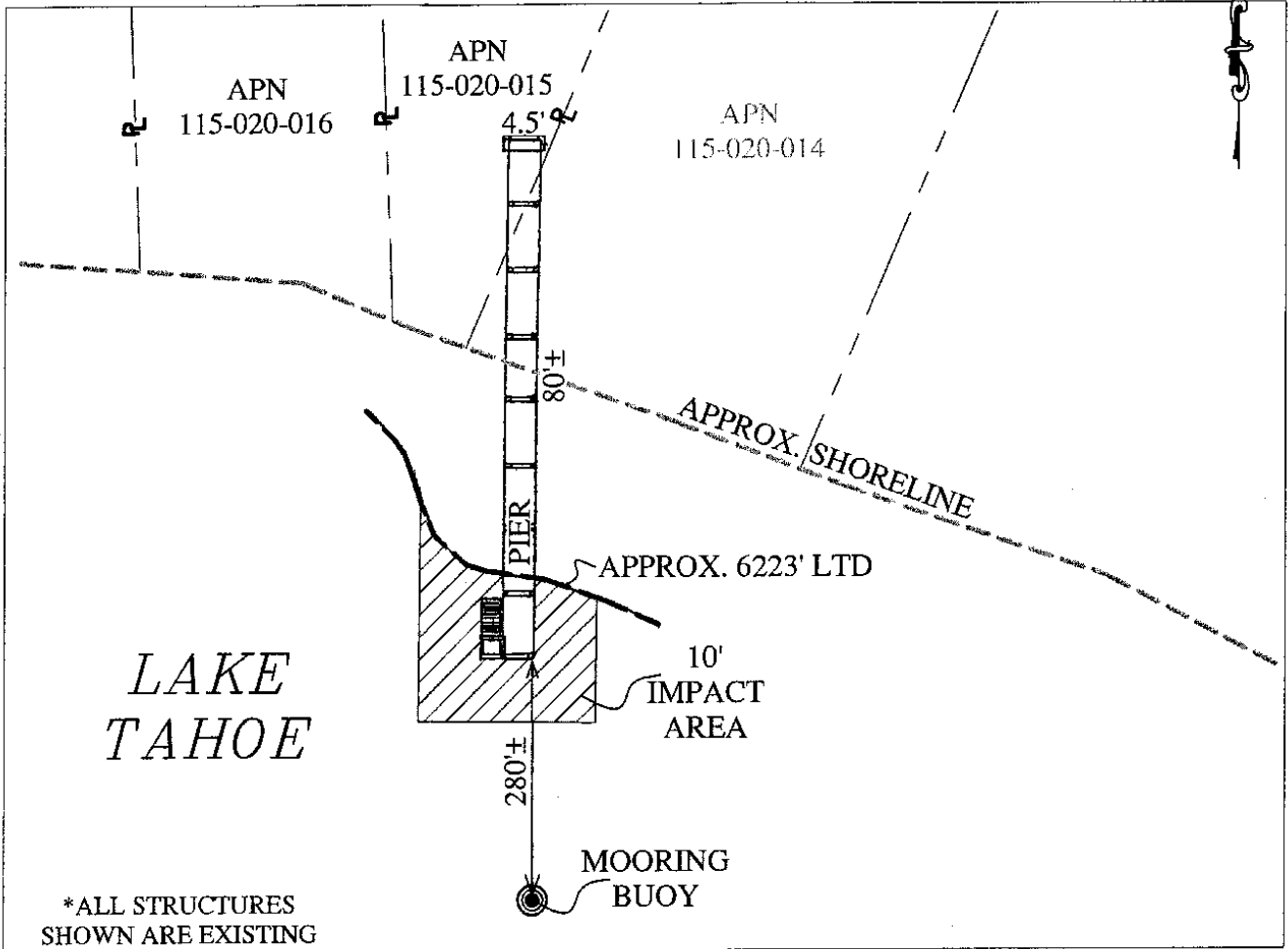

5256 North Lake Blvd, near Carnelian Bay

NO SCALE

LOCATION

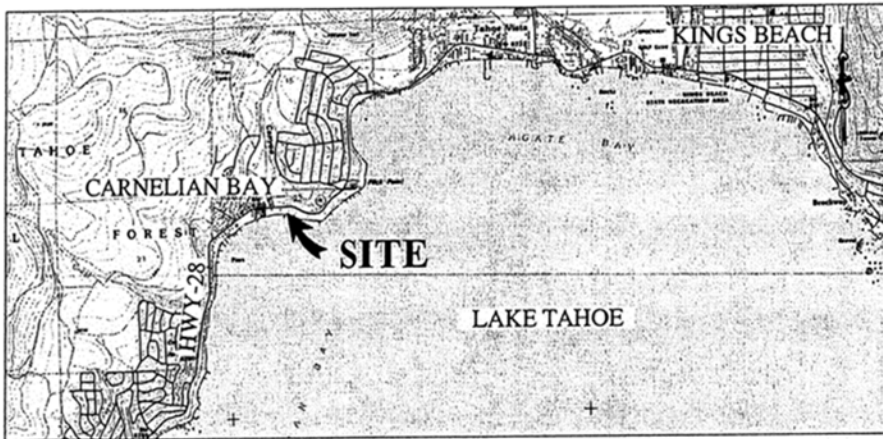

MAP SOURCE: USGS QUAD

This Exhibit is solely for purposes of generally defining the lease premises, is based on unverified information provided by the Lessee or other parties and is not intended to be, nor shall it be construed as, a waiver or limitation of any State interest in the subject or any other property.

Exhibit B

PRC 5123.9
 NELSON
 APN 115-020-015&016
 GENERAL LEASE -
 RECREATIONAL USE
 PLACER COUNTY

SITE

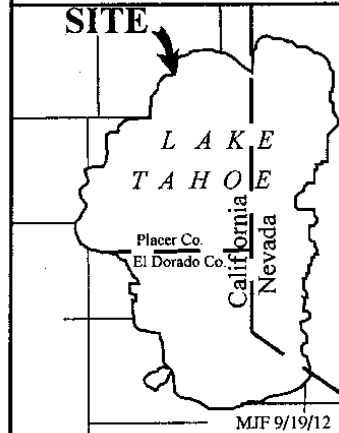

MJF 9/19/12