

**CALENDAR ITEM
C01**

A 4
S 1

05/24/12
PRC 8469.9
R. Barham

**TERMINATION OF A RECREATIONAL PIER LEASE AND ISSUANCE OF A
GENERAL LEASE – RECREATIONAL USE**

LESSEE:

Jason A. DiLullo

APPLICANTS:

Martin H. Loeffler and Sidsel S. Loeffler

AREA, LAND TYPE, AND LOCATION:

Sovereign land in Lake Tahoe, adjacent to 1490 North Lake Boulevard, near Tahoe City, Placer County.

AUTHORIZED USE:

Continued use and maintenance of an existing pier and two mooring buoys.

LEASE TERM:

10 years, beginning May 24, 2012.

CONSIDERATION:

No monetary consideration pursuant to Public Resources Code section 6503.5.

SPECIFIC LEASE PROVISIONS:

Insurance:

Liability insurance in the amount of no less than \$1,000,000.

Other:

The proposed lease contains a provision requiring the Applicant to obtain authorization from the Tahoe Regional Planning Agency (TRPA) for the mooring buoys within two years of the adoption of a Final Environmental Impact Statement (FEIS) for the Lake Tahoe Shorezone Ordinance Amendments and approval of the amended ordinances. This is a continuation of the process the Commission used from approximately 1995 to October 2008 when TRPA adopted an FEIS and Ordinance Amendments supported by the FEIS. In September 2010, the U.S. District Court invalidated the FEIS and nullified the Amendments. When additional information is available, Commission staff will advise the Commission on any suggested modifications to the process used by the Commission pending resolution of the TRPA FEIS and ordinance issues.

CALENDAR ITEM NO. **C01** (CONT'D)

OTHER PERTINENT INFORMATION:

1. Applicants own the upland adjoining the lease premises.
2. On August 19, 2003, the Commission authorized a Recreational Pier Lease with Jason A. DiLullo, for a pier and two mooring buoys. That lease will expire on April 30, 2013. On September 8, 2010, the upland property was transferred to Martin H. Loeffler and Sidsel S. Loeffler. Applicants are now applying for a new General Lease – Recreational Use.
3. On October 8, 2011, Chapter 585, Statutes of 2011 became law. The law became effective January 1, 2012. This new law repeals section 6503.5 of the Public Resources Code, which had allowed rent-free use of State-owned land by certain private parties for their recreational piers. It replaced the former section with a new section 6503.5 which provides that the State Lands Commission “shall charge rent for a private recreational pier constructed on state lands.” The law provides for two exceptions to the imposition of rent. Those exceptions are for:
 - A. A lease in effect on July 1, 2011 through the remaining term of that lease. If a lease in effect on July 1, 2011 expires or is otherwise terminated, any new lease will be subject to rent; and
 - B. A lease for which the lease application and application fees were submitted to the Commission prior to March 31, 2011.

Because the application was submitted to the Commission prior to March 31, 2011, the lease meets the statutory requirements for an exception to recently enacted changes to Section 6503.5 of the Public Resources Code for the term of this lease.

4. **Termination of Lease:** The staff recommends that the Commission find that the subject termination of lease does not have a potential for resulting in either a direct or a reasonably foreseeable indirect physical change in the environment, and is, therefore, not a project in accordance with the California Environmental Quality Act (CEQA).

Authority: Public Resources Code section 21065 and California Code of Regulations, Title 14, sections 15060 subdivision (c)(3) and 15378.

5. **Issuance of Lease:** Pursuant to the Commission’s delegation of authority and the State CEQA Guidelines (Cal. Code Regs., tit. 14, § 15061), the staff has determined that this activity is exempt from the requirements of CEQA as a categorically exempt project. The project is exempt under

CALENDAR ITEM NO. **C01** (CONT'D)

Class 1, Existing Facilities; California Code of Regulations, Title 2, section 2905, subdivision (a)(2).

Authority: Public Resources Code section 21084 and California Code of Regulations, Title 14, section 15300 and California Code of Regulations, Title 2, section 2905.

6. This activity involves lands identified as possessing significant environmental values pursuant to Public Resources Code section 6370 et seq., but such activity will not affect those significant lands. Based upon the staff's consultation with the persons nominating such lands and through the CEQA review process, it is the staff's opinion that the project, as proposed, is consistent with its use classification.

EXHIBITS:

- A. Land Description
- B. Site and Location Map

RECOMMENDED ACTION:

It is recommended that the Commission:

CEQA FINDING:

Termination of Lease: Find that the activity is not subject to the requirements of CEQA pursuant to California Code of Regulations, Title 14, section 15060, subdivision (c)(3) because the activity is not a project as defined by Public Resources Code section 21065 and California Code of Regulations, Title 14, section 15378.

Issuance of Lease: Find that the activity is exempt from the requirements of CEQA pursuant to California Code of Regulations, Title 14, section 15061 as a categorically exempt project, Class 1, Existing Facilities; California Code of Regulations, Title 2, section 2905, subdivision (a)(2).

SIGNIFICANT LANDS INVENTORY FINDING:

Find that this activity is consistent with the use classification designated by the Commission for the land pursuant to Public Resources Code section 6370 et seq.

AUTHORIZATION:

1. Authorize termination, effective May 24, 2012, of Lease No. PRC 8469.9, a Recreational Pier Lease, issued to Jason A. DiLullo.

CALENDAR ITEM NO. **C01** (CONT'D)

2. Authorize issuance of a General Lease – Recreational Use to Martin H. Loeffler and Sidsel S. Loeffler, beginning May 24, 2012, for a term of 10 years, for the continued use and maintenance of an existing pier and two mooring buoys described in Exhibit A and shown on Exhibit B (for reference purposes only) attached and by this reference made a part hereof; no monetary consideration pursuant to Public Resources Code section 6503.5; and liability insurance in the amount of no less than \$1,000,000.

EXHIBIT A

PRC 8469.9

LAND DESCRIPTION

Three (3) parcels of submerged land situate in the bed of Lake Tahoe, lying adjacent to Lot 5 of fractional Section 5, Township 15 North, Range 17 East, MDM., as shown on Official Government Township Plat approved September 25, 1906, County of Placer, State of California, and more particularly described as follows:

PARCEL 1 – PIER

All those lands underlying an existing pier lying adjacent to that parcel as described in that Grant Deed recorded September 8, 2010 in Document Number 2010-0070757-00 in Official Records of said County.

EXCEPTING THEREFROM any portion lying landward of elevation 6223 feet LTD on the shoreline of said Lake Tahoe.

PARCELS 2 & 3 – BUOYS

Two (2) circular parcels of land, each being 50 feet in diameter, underlying two (2) existing buoys lying adjacent to that parcel as described in said Grant Deed.

Accompanying plat is hereby made part of this description.

END OF DESCRIPTION

Prepared February 24, 2012 by the California State Lands Commission Boundary Unit.

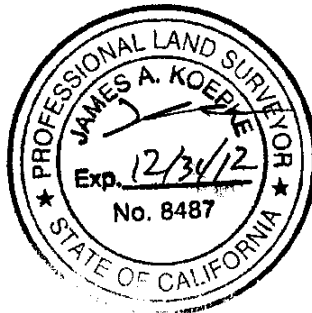

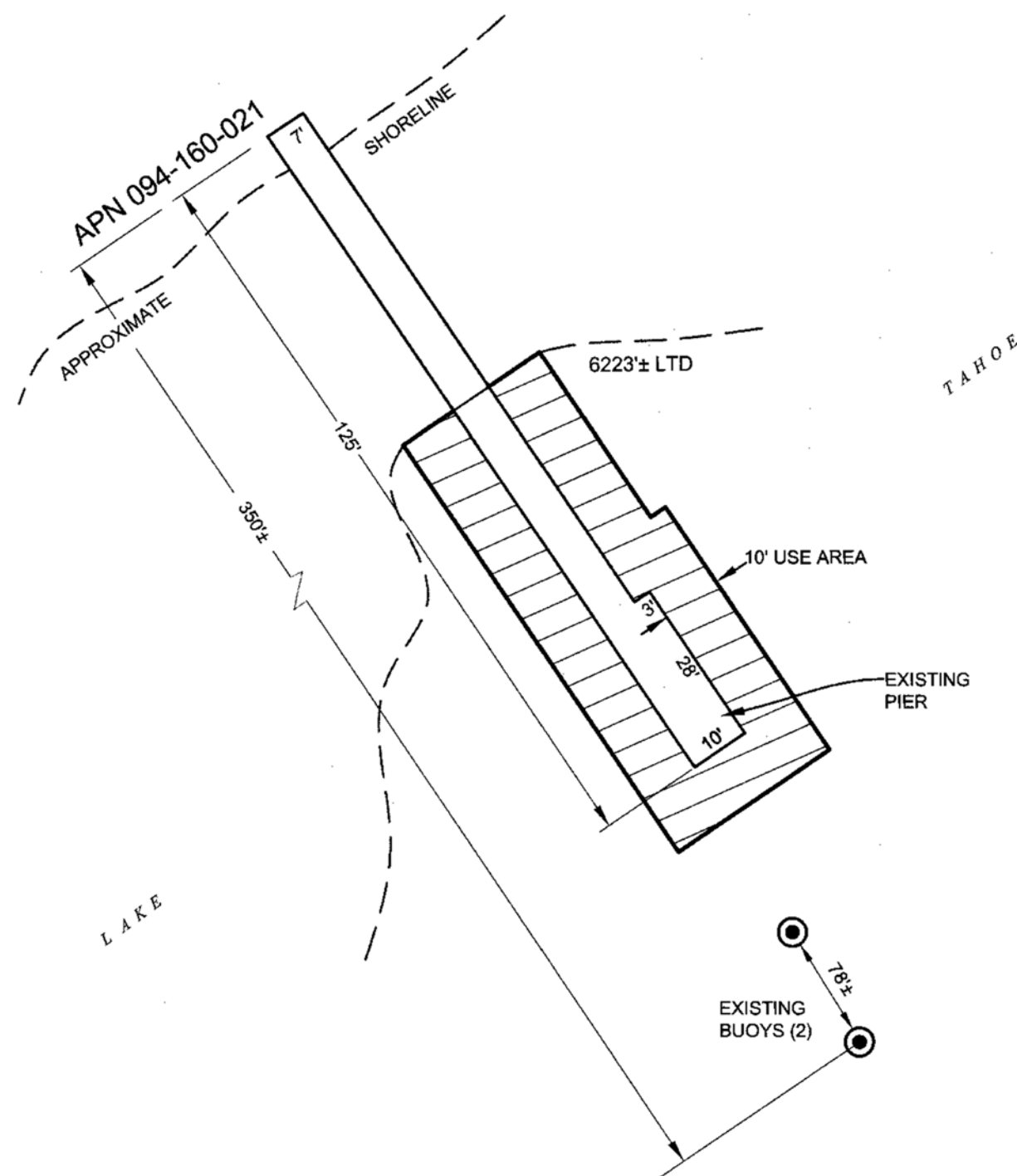
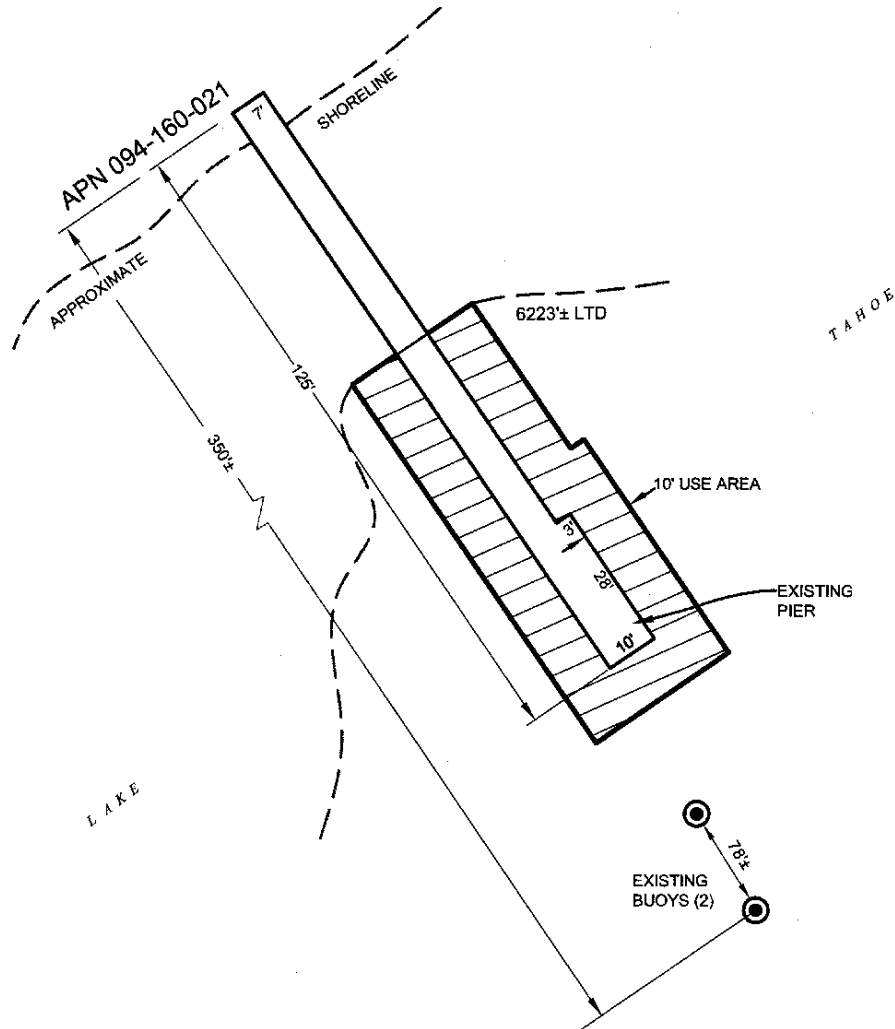

EXHIBIT A



NO SCALE

SITE



1490 NORTH LAKE BLVD., NEAR TAHOE CITY

NO SCALE

LOCATION

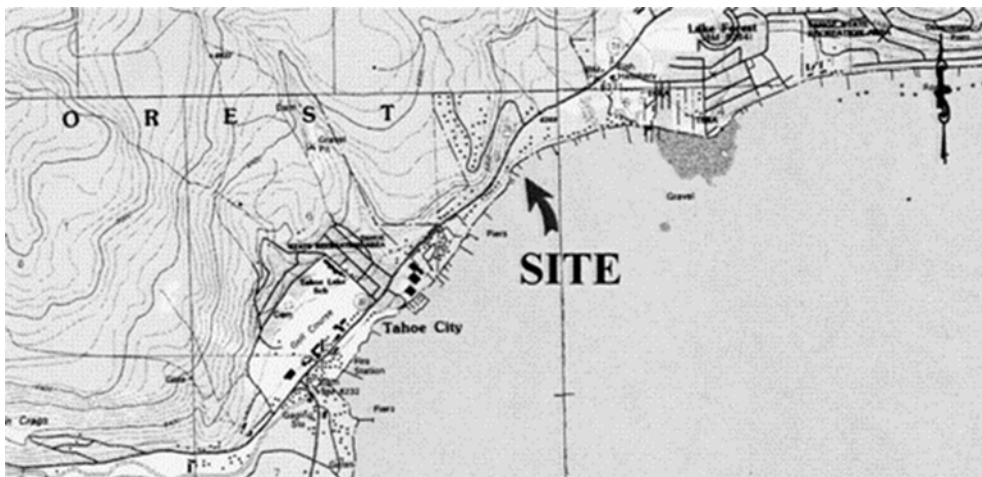

MAP SOURCE: USGS QUAD

Exhibit B

PRC 8469.9
 LOEFFLER, MARTIN & SIDSEL
 APN 094-160-021
 GENERAL LEASE -
 RECREATIONAL USE
 PLACER COUNTY

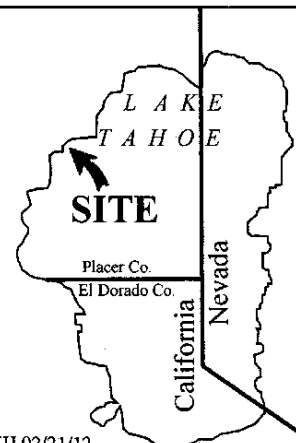

MJJ 02/21/12

This Exhibit is solely for purposes of generally defining the lease premises, is based on unverified information provided by the Lessee or other parties and is not intended to be, nor shall it be construed as, a waiver or limitation of any State interest in the subject or any other property.