

NO SCALE

SITE

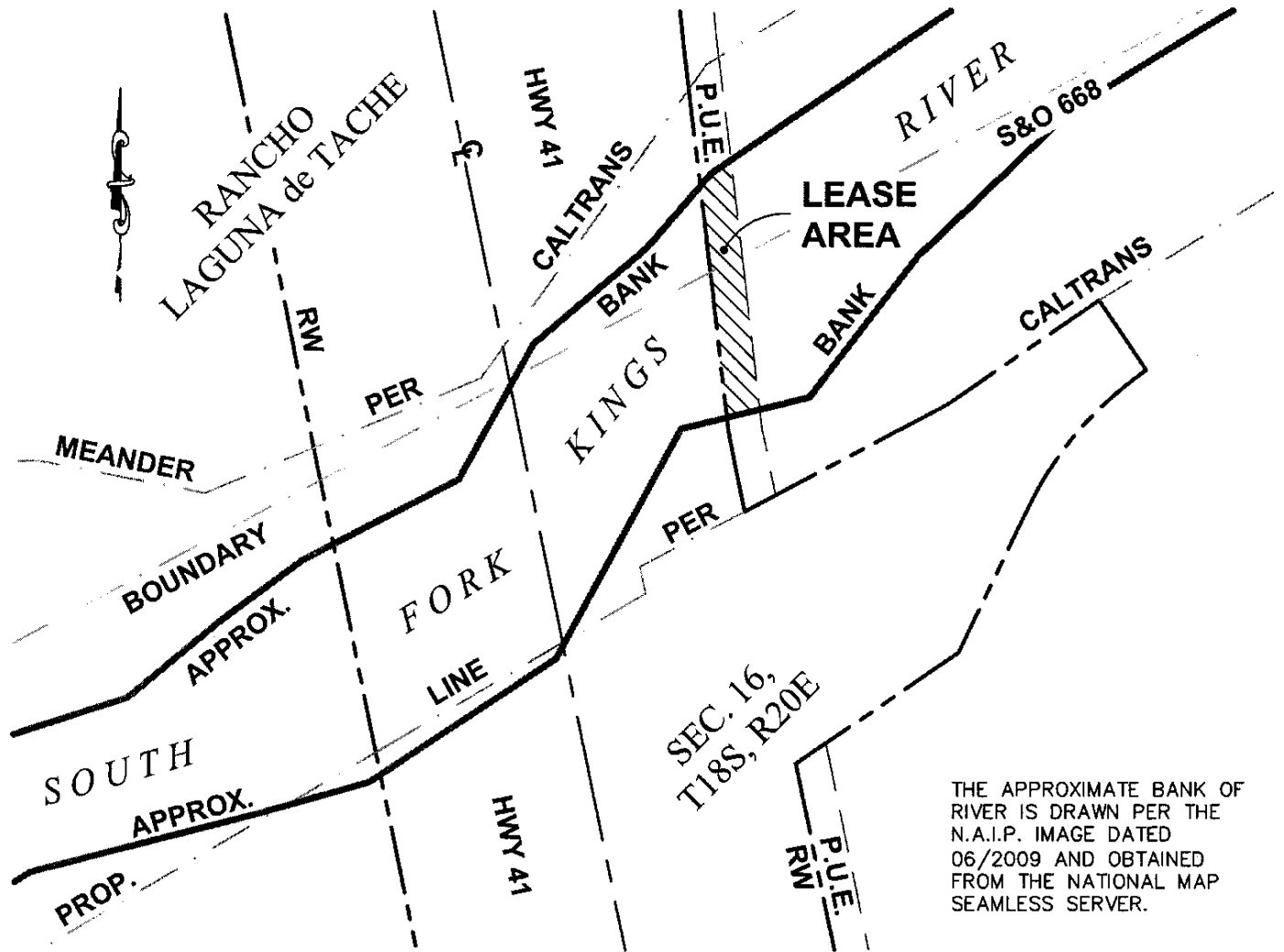

THE APPROXIMATE BANK OF RIVER IS DRAWN PER THE N.A.I.P. IMAGE DATED 06/2009 AND OBTAINED FROM THE NATIONAL MAP SEAMLESS SERVER.

Southern California Gas Company over South Fork Kings River

NO SCALE

LOCATION

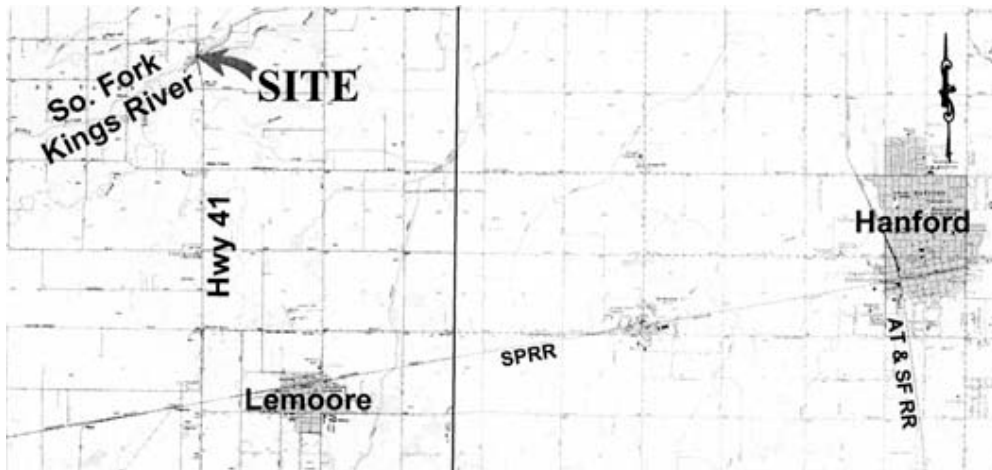

MAP SOURCE: USGS QUAD

Exhibit A

PRC 4989.1
SO. CALIFORNIA GAS CO.
GENERAL LEASE
RIGHT OF WAY USE
KINGS COUNTY



This Exhibit is solely for purposes of generally defining the lease premises, is based on unverified information provided by the Lessee or other parties and is not intended to be, nor shall it be construed as, a waiver or limitation of any State interest in the subject or any other property.