

**CALENDAR ITEM
C40**

A 22
S 10

04/06/10
WP 8454.9
N. Smith

GENERAL LEASE - PUBLIC AGENCY USE

APPLICANT:

Santa Clara Valley Water District
5750 Almaden Expressway
San Jose, CA 95118

AREA, LAND TYPE, AND LOCATION:

0.56 acre, more or less, of sovereign lands in the historic bed of Guadalupe River, city of San Jose, Santa Clara County.

AUTHORIZED USE:

Construction use, and maintenance of the Gold Street Educational Center, consisting of a parking lot with 10-12 parking stalls, decomposed granite trails, interpretive signage, a gazebo, a restroom, rope fencing, and landscaping with a mixture of native shrubs and trees.

LEASE TERM:

20 years, beginning April 6, 2010.

CONSIDERATION:

The public use and benefit with the State reserving the right at any time to set a monetary rent if the Commission finds such action to be in the State's best interest.

SPECIFIC LEASE PROVISIONS:

Insurance: Combined single limit coverage of not less than \$1,000,000, or equivalent staff approved self insurance program.

Bond: \$100,000 construction bond

Other: Lessee shall provide as-built engineered drawings of the improvements within 180 days of completion of the project.

CALENDAR ITEM NO. **C40** (CONT'D)

OTHER PERTINENT INFORMATION:

1. The Applicant has access to the uplands adjoining the lease premises, as the parcel is surrounded by city streets; however, prior to construction, the Applicant will be required to obtain approval from the city of San Jose for authorization to construct a portion of the parking area within the City's easement.
2. On April 7, 2003, the Commission authorized a General Lease – Public Agency Use PRC No. 8454.9, to the District for five years for a construction staging area in connection with a levee restoration project on the Guadalupe River. The lease expired on April 6, 2008
3. On July 8, 2003, the District's Board of Directors authorized planning for an educational center adjacent to the Guadalupe River as an enhancement to the Lower Guadalupe River Flood Protection Project. The purpose of the educational center is to highlight Alviso's history and close association with the Guadalupe River and South San Francisco Bay, and provide a link to recreational trails in the vicinity.
4. The proposed educational center would be located on a 0.56-acre parcel on Gold Street, adjacent to the Guadalupe River. The site would be developed with 10-12 parking stalls, decomposed granite trails, interpretive signage, a gazebo, a restroom, rope fencing, and landscaping with a mixture of native shrubs and trees.
5. A Mitigated Negative Declaration SCH#2009032058 was prepared by the Santa Clara Valley Water District and adopted on October 27, 2009 for this project. The California State Lands Commission's staff has reviewed this document.

A Mitigation Monitoring Program was adopted by the Santa Clara Valley Water District.
6. This activity involves lands identified as possessing significant environmental values pursuant to Public Resources Code sections 6370, et seq. Based upon the staff's consultation with the persons nominating such lands and through the CEQA review process, it is the staff's opinion that the project, as proposed, is consistent with its use classification.

APPROVALS OBTAINED:

Santa Clara Valley Water District

CALENDAR ITEM NO. **C40** (CONT'D)

FURTHER APPROVALS REQUIRED:

City of San Jose

EXHIBITS:

- A. Site and Location Map
- B. Land Description
- C. Mitigation Monitoring Program

PERMIT STREAMLINING ACT DEADLINE:

April 25, 2010

RECOMMENDED ACTION:

IT IS RECOMMENDED THAT THE COMMISSION:

CEQA FINDING:

Find that a Mitigated Negative Declaration SCH#2009032058 and a Mitigation Monitoring Program were prepared and adopted for this project by the Santa Clara Valley Water District and that the Commission has reviewed and considered the information contained therein.

Adopt the Mitigation Monitoring Program, as contained in Exhibit "C" attached hereto.

SIGNIFICANT LANDS INVENTORY FINDING:

Find that this activity is consistent with the use classification designated by the Commission for the land pursuant to Public Resources Code sections 6370, et seq.

AUTHORIZATION:

Authorize issuance of a General Lease – Public Agency Use to the Santa Clara Valley Water District beginning April 6, 2010, for a term of 20 years, for construction, use, and maintenance of the Gold Street Educational Center on State Lands shown on Exhibit A (for reference purposes only) and described as Exhibit B attached and by this reference made a part hereof; consideration being the public use and benefit with the State reserving the right at any time to set a monetary rent if the Commission finds such action to be in the State's best interest, and liability insurance for combined single limit coverage of no less than \$1,000,000 or an equivalent self-insurance program upon approval of Commission staff to satisfy insurance requirements; and construction bond in the amount of \$100,000.

NO SCALE

SITE

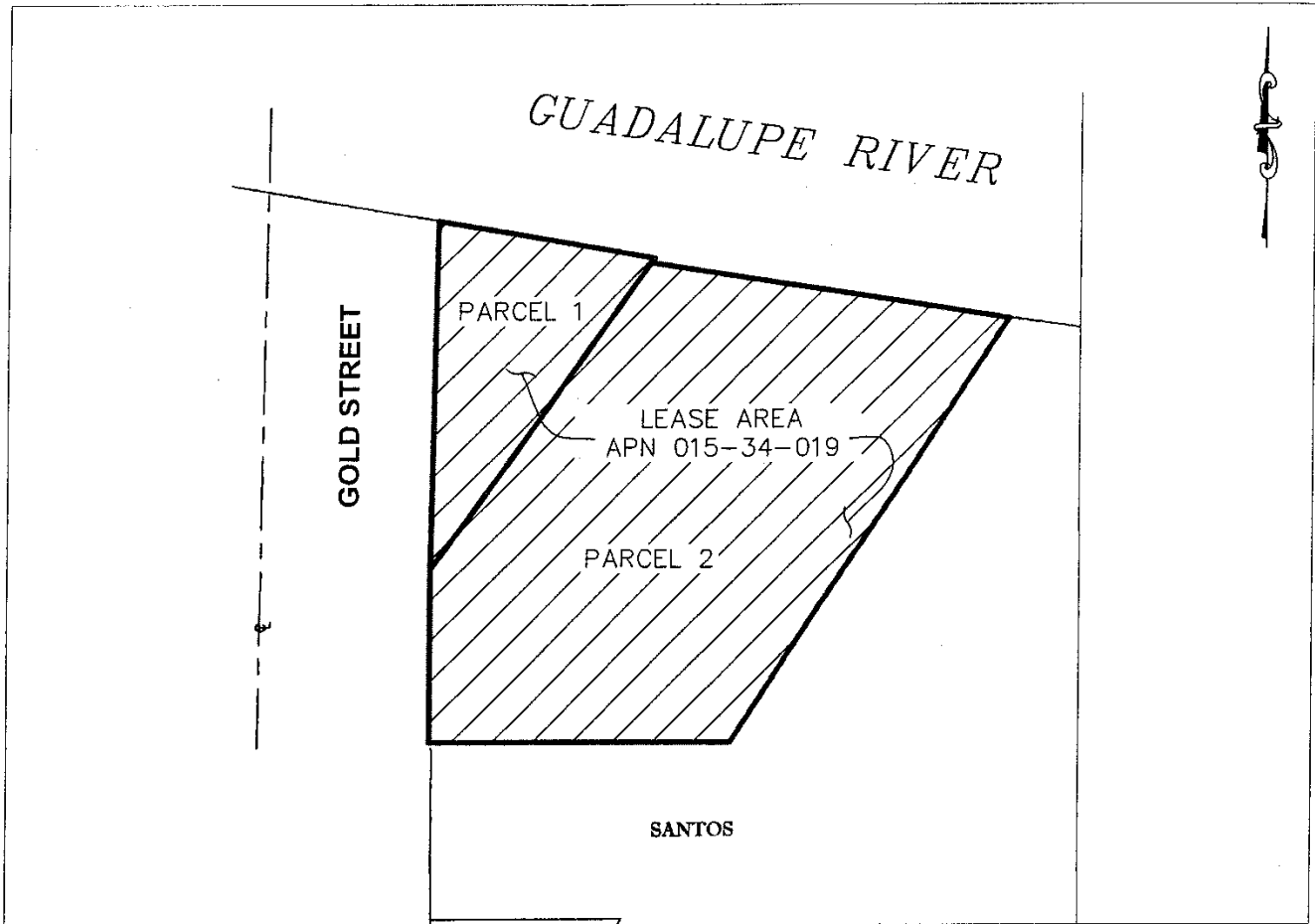

GOLD STREET / HISTORIC GUADALUPE RIVER, SAN JOSE

NO SCALE

LOCATION



MAP SOURCE: USGS QUAD

Exhibit A

PRC 8454
 SANTA CLARA VALLEY
 WATER DISTRICT
 APN 015-34-019
 GENERAL LEASE PUBLIC
 AGENCY USE
 SANTA CLARA COUNTY



This Exhibit is solely for purposes of generally defining the lease premises, is based on unverified information provided by the Lessee or other parties and is not intended to be, nor shall it be construed as, a waiver or limitation of any State interest in the subject or any other property.

EXHIBIT B

LAND DESCRIPTION

A parcel of land quitclaimed to the State by the Santa Clara County Flood Control District under Boundary Line Agreement 109 / Sovereign Land Location 48, land exchange and boundary agreement together with a portion of a Parcel of State owned sovereign land lying in the filled bed of the Guadalupe River, situate in Santa Clara County, State of California, as described in the document recorded in Book 8511, page 526, Official Records, County of Santa Clara, more particularly described as follows:

PARCEL 1

A parcel of Public Trust Land acquired pursuant to Boundary Line Agreement 109 described as Parcel "F" in Book 8511, page 526, Records of said County.

PARCEL 2

BEGINNING at the southwest corner of Parcel "1" of that certain Final Order of Condemnation recorded in Book 6929, page 520, Official Records in the office of the County Recorder of said County, from which a ¼ inch iron pipe, tagged L.S. 2693, bears S81°05'27"E 37.18 feet; thence from said point of beginning S33°W 175.97 feet to the northeast corner of Parcel "B" as described in said deed; thence along the northerly line of said Parcel "B" S89°59'09"W 105.04 feet to northwest corner of said Parcel "B", said point also lying on the easterly line of Parcel "A" as described in said deed; thence leaving the northerly line of said Parcel "B" along the easterly line of said Parcel "A" N00°00'51"W 60.18 feet to the north corner of said Parcel "A"; thence leaving the north corner of said Parcel "A" N35°35'E 131.48 feet; thence S81°05'27"E 125.91 feet to the point of beginning.

END OF DESCRIPTION

Written on 03/23/2010 by the California State Lands Commission Boundary Unit.

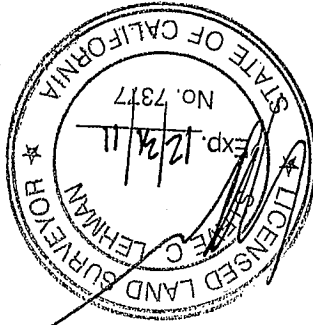

**GOLD STREET EDUCATIONAL CENTER
MITIGATION MONITORING AND REPORTING PROGRAM SUMMARY TABLE**

Measure Element #	Environmental Issue	Mitigation Measure	Timeframe for Implementation	Responsibility for Implementation	Responsibility for Oversight
AIR QUALITY					
BMP AQ-1	Dust Control Measure	Implement Bay Area Air Quality Management District (BAAQMD) control measures for construction emissions of PM ₁₀ . Current measures stipulated by the BAAQMD CEQA Guidelines include the following (BAAQMD 1999): <ol style="list-style-type: none"> 1. Active areas shall be watered at least twice per day unless soils are already sufficiently moist to avoid dust. The amount of water must be controlled to avoid runoff, yet dust control is achieved. 2. Trucks hauling soil, sand, and other loose materials shall be covered or shall maintain at least two feet of freeboard. 3. Unpaved access roads, parking areas and staging areas at construction sites shall be paved, watered three times daily, or non-toxic soil stabilizers shall be applied to control dust generation. 4. Paved site access roads, parking areas, and staging areas shall be swept daily (with vacuum-powered street sweepers). 5. Paved public streets shall be swept (with vacuum-powered street sweepers) if visible soil material is carried onto adjacent paved surfaces. 	Throughout all construction phases	Contractor	District
BIOLOGICAL RESOURCES					
BMP BIO-1	Migratory Bird Surveys	Migratory bird surveys will be performed prior to any project-related activity that could pose the potential to affect migratory birds. Inactive bird nests may be removed, with the exception of raptor nests. No birds, nests with eggs, or nests with hatchlings will be disturbed.	Prior to and throughout all construction phases	District	District

**GOLD STREET EDUCATIONAL CENTER
MITIGATION MONITORING AND REPORTING PROGRAM SUMMARY TABLE**

Measure Element #	Environmental Issue	Mitigation Measure	Timeframe for Implementation	Responsibility for Implementation	Responsibility for Oversight
BMP B10-2	Migratory Bird Nesting Prevention Vegetation Clearing	Vegetation can be cleared and maintained to prevent migratory bird nesting. All necessary vegetation clearing will be performed prior to the nesting season, if at all possible. No vegetation will be trimmed back unnecessarily, including trees and/or shrubs growing near the right of way, which overhang onto the work site.	Prior to construction	Contractor	District
BMP B10-3	Migratory Bird Nesting Exclusion Devices	Nesting exclusion devices may be installed to prevent potential establishment or occurrence of nests in areas where construction activities would occur. All nesting exclusion devices will be maintained throughout the nesting season, or until completion of work in an area makes the devices unnecessary. All exclusion devices will be removed and disposed of when work in the area is complete.	Prior to and throughout construction (as necessary)	District / Contractor	District
MM B10-1	Burrowing Owl surveys and buffer zones	Pre-construction surveys for burrowing owls will be conducted by a qualified ornithologist with local experience, prior to any soil-altering activity within the Project area. Pre-construction surveys will be conducted per CDFG guidelines (no more than 30 days prior to the start of soil moving activities), regardless of the time of year in which grading occurs. If no burrowing owls are found, then no further mitigation would be warranted. If breeding owls are located on or immediately adjacent to the site, a construction-free buffer zone around the active burrow will be established as determined by the ornithologist. Burrowing owls will not be evicted from the site during the breeding season. If owls are resident during the non-breeding season, a qualified ornithologist with local experience, in accordance with accepted biological protocol, will move the owls in consultation with CDFG.	Prior to construction	District	District

GOLD STREET EDUCATIONAL CENTER
MITIGATION MONITORING AND REPORTING PROGRAM SUMMARY TABLE

Measure Element #	Environmental Issue	Mitigation Measure	Timeframe for Implementation	Responsibility for Implementation	Responsibility for Oversight
MM B10-2	Nesting Bird Buffer Zones	In the event that an active nest of a protected bird species is discovered in the construction area during construction, or in adjacent areas considered to have the potential to be disturbed by construction, a protective buffer zone shall be established around the nest as recommended or approved by applicable resource agencies, or as follows: A 20-foot radius protective buffer zone shall be established around the nest of any non-raptor, ground-nesting bird, and a 50-foot radius protective buffer zone shall be established around nests in shrubs, trees, on structures, on equipment, etc., except for raptor nests. The protective buffer zone shall be 250 feet for hawks, owls (including burrowing owls), herons and egrets. Fencing shall be installed at the boundary of each new protective buffer zone. All protective buffer zones shall be maintained, and no entrance shall be allowed into protective buffer zones, until such time as the nest becomes inactive.	Throughout all construction phases	District	District
CULTURAL RESOURCES					
BMP Cult-1	Archaeological Finds	Work in areas where archaeological artifacts are found will be restricted or stopped until proper protocols are met. Work at the location of the find will halt immediately within 30 feet of the find. A Consulting Archaeologist will visit the discovery site as soon as practicable for identification and evaluation pursuant to Section 21083.2 of the Public Resources Code and Section 15126.4 of the California Code of Regulations. If the archaeologist determines that the artifact is not significant, construction may resume. If the archaeologist determines that the artifact is significant, the archaeologist will determine if the artifact can be avoided and, if so, will detail avoidance procedures. If the artifact cannot be avoided, the archaeologist will develop within 48 hours an Action Plan which will include provisions to minimize impacts and, if required, a Data Recovery Plan for recovery of artifacts in accordance with Public Resources Code Section 21083.2 and Section 15126.4 of the CEQA Guidelines.	Throughout construction (as necessary)	Contractor	District

**GOLD STREET EDUCATIONAL CENTER
MITIGATION MONITORING AND REPORTING PROGRAM SUMMARY TABLE**

Measure Element #	Environmental Issue	Mitigation Measure	Timeframe for Implementation	Responsibility for Implementation	Responsibility for Oversight
BMP Cult-2	Burial Finds	Work in areas where any burial site is found will be restricted or stopped until proper protocols are met. Upon discovering any burial site as evidenced by human skeletal remains, the County Coroner will be immediately notified. No further excavation or disturbance within 30 feet of the site or any nearby area reasonably suspected to overlie adjacent remains may be made except as authorized by the County Coroner, California Native American Heritage Commission, and/or the County Coordinator of Indian Affairs.	Throughout construction (as necessary)	Contractor	District
HAZARDS AND HAZARDOUS MATERIALS					
BMP HM-1	Vehicle and Equipment Cleaning	Vehicles will be washed only at the approved area in the corporation yard. No washing of vehicles will occur at job sites.	Throughout construction	Contractor	District
BMP HM-2	Vehicle and Equipment Fueling	<p>No fueling will be done in a waterway or immediate flood plain, unless equipment stationed in these locations is not readily relocated (i.e., pumps, generators).</p> <ol style="list-style-type: none"> For stationary equipment that must be fueled on-site, containment will be provided in such a manner that any accidental spill of fuel will not be able to enter the water or contaminate sediments that may come in contact with water. Any equipment that is readily moved out of the waterway will not be fueled in the waterway or immediate flood plain. All fueling done at the job site will provide containment to the degree that any spill will be unable to enter any waterway or damage riparian vegetation. 	Throughout construction	Contractor	District

**GOLD STREET EDUCATIONAL CENTER
MITIGATION MONITORING AND REPORTING PROGRAM SUMMARY TABLE**

Measure Element #	Environmental Issue	Mitigation Measure	Timeframe for Implementation	Responsibility for Implementation	Responsibility for Oversight
BMP HM-3	Vehicle and Equipment Maintenance	<p>No equipment servicing will be done in a stream channel or immediate flood plain, unless equipment stationed in these locations cannot be readily relocated (i.e., pumps, generators).</p> <ol style="list-style-type: none"> 1. Any equipment that can be readily moved out of the channel will not be serviced in the channel or immediate flood plain. 2. All servicing of equipment done at the job site will provide containment to the degree that any spill will be unable to enter any channel or damage stream vegetation. 3. If emergency repairs are required in the field, only those repairs necessary to move equipment to a more secure location will be done in a channel or flood plain. 4. If emergency repairs are required, containment will be provided equivalent to that done for fueling or servicing. 	Throughout construction	Contractor	District
BMP HM-4	Hazardous Materials Management	<p>Measures will be implemented to ensure that hazardous materials are properly handled and the quality of water resources is protected by all reasonable means.</p> <ol style="list-style-type: none"> 1. Prior to entering the work site, all field personnel will know how to respond when toxic materials are discovered. 2. The discharge of any hazardous or non-hazardous waste as defined in Division 2, Subdivision 1, Chapter 2 of the California Code of Regulations will be conducted in accordance with applicable State and federal regulations. 3. In the event of any hazardous material emergencies or spills, personnel will call the Chemical Emergencies/Spills Hotline at 1-800-510-5151. 	Throughout construction	Contractor	District

**GOLD STREET EDUCATIONAL CENTER
MITIGATION MONITORING AND REPORTING PROGRAM SUMMARY TABLE**

Measure Element #	Environmental Issue	Mitigation Measure	Timeframe for Implementation	Responsibility for Implementation	Responsibility for Oversight
BMP HM-5	Spill Prevention	Prevent the accidental release of chemicals, fuels, lubricants, and non-storm drainage water. 1. Field personnel will be appropriately trained in spill prevention, hazardous material control, and clean-up of accidental spills. 2. No fueling, repair, cleaning, maintenance, or vehicle washing will be performed in a creek channel or in areas at the top of a channel bank that may flow into a creek channel.	Throughout construction	Contractor	District
BMP HM-6	Spill Kit Location	Spill prevention kits appropriate to the hazard will always be in close proximity when using hazardous materials (e.g., crew trucks and other logical locations). 1. Prior to entering the work site, all field personnel will know the location of spill kits on crew trucks and at other locations within District facilities. 2. All field personnel will be advised of these locations and trained in their appropriate use.	Throughout construction	Contractor	District
BMP HM-7	Herbicide Use Requirements	All herbicide use will be consistent with approved product specifications. Applications will be made by, or under the direct supervision of, State Certified applicators under the direction of a licensed Pest Control Advisor.	Maintenance of site	District	District

**GOLD STREET EDUCATIONAL CENTER
MITIGATION MONITORING AND REPORTING PROGRAM SUMMARY TABLE**

Measure Element #	Environmental Issue	Mitigation Measure	Timeframe for Implementation	Responsibility for Implementation	Responsibility for Oversight
BMP HM-8	Types of Pest Control	<p>Pesticide products are to be used only after an assessment has been made regarding environmental, economical, and public health aspects of each of the alternatives. The following pesticides are used by the District:</p> <p>Herbicides could be used:</p> <ul style="list-style-type: none"> • To control algae, weeds and undesirable vegetation • To minimize fire hazards • To maintain compliance with State and Federal requirements <p>Insecticides could be used:</p> <ul style="list-style-type: none"> • Only after all other methods, such as prevention or natural nontoxic control methods, have proven ineffective • Where required, the lowest toxicity will be used in accordance with the label and the details of this policy 	Maintenance of site	District	District
BMP HM-9	Alternative Evaluation & Approval of Pest Control	<p>In all cases where some form of pest control is deemed necessary, a process of evaluating pest control methods will be used to include consideration of alternatives to pesticides. This process will evaluate the proposed use based on the following:</p> <ol style="list-style-type: none"> 1. Effectiveness 2. Public health aspects 3. Long and short term environmental impacts 4. Financial cost 5. Consistency with this policy 6. Consistency with the Board's policies <p>Restrictions on herbicide and rodenticide use will be based on limitations and suggestions in District Policy Ad-8.2 Pesticide Use.</p>	Maintenance of site	District	District

**GOLD STREET EDUCATIONAL CENTER
MITIGATION MONITORING AND REPORTING PROGRAM SUMMARY TABLE**

Measure Element #	Environmental Issue	Mitigation Measure	Timeframe for Implementation	Responsibility for Implementation	Responsibility for Oversight
BMP HM-10	Posting & Notification for Pesticide Use	<p>Posting of areas where pesticides are used will be performed in compliance with District Policy Ad-8.2 Pesticide Use as follows:</p> <ol style="list-style-type: none"> 1. Posting will be performed in compliance with the label requirements of the product being applied. 2. In addition, posting will be provided for any products applied in areas used by the public for recreational purposes, or those areas readily accessible to the public, regardless of whether the label requires such notification. In doing this, the District ensures that exposure risk is minimized further by adopting practices that go beyond the product label requirements. 3. These postings will notify staff and the general public of the date and time of application, the product's active ingredients, and common name, and the time of allowable re-entry into the treated area. 4. Signs will not be removed until after the end of the specified re-entry interval. 5. Right-to-know literature on the product will be made available to anyone in the area during the re-entry period. 6. A District staff contact phone number will be posted on the sign, including a pager number. 7. Notification of pesticide activities will be made as required by law. In addition, the District will maintain records of neighbors with specific needs relative to notification prior to treatment of an adjacent area to ensure such needs are met. 	Maintenance of site	District	District

**GOLD STREET EDUCATIONAL CENTER
MITIGATION MONITORING AND REPORTING PROGRAM SUMMARY TABLE**

Measure Element #	Environmental Issue	Mitigation Measure	Timeframe for Implementation	Responsibility for Implementation	Responsibility for Oversight
BMP HM-11	Pesticide Usage Requirements	<p>All projects that propose ongoing use of pesticides will be subject to the following:</p> <ol style="list-style-type: none"> 1. All pest control methods will be performed only after a written Pest Control Recommendation for use has been prepared by a licensed Pest Control Advisor in accordance with requirements of the California Food and Agricultural Code. 2. A Daily Pesticide Use Report will be completed for each pesticide application. 3. This report will be submitted with each daily work order and include: <ol style="list-style-type: none"> a. Pesticide common name and active ingredient b. Method of application c. Dilution rate, if applicable d. Total amount of product applied, plus the total amount of diluted material e. For outdoor applications, weather conditions, including temperature and wind speed f. Specific pests controlled with each application 	Maintenance of site	District	District

**GOLD STREET EDUCATIONAL CENTER
MITIGATION MONITORING AND REPORTING PROGRAM SUMMARY TABLE**

Measure Element #	Environmental Issue	Mitigation Measure	Timeframe for Implementation	Responsibility for Implementation	Responsibility for Oversight
BMP HM-12	Pesticide Use Reporting	<ol style="list-style-type: none"> 1. A Monthly Pesticide Use Report will be submitted by each Unit Manager who oversees pesticide use to the Reduced Risk Pest Management (RRPM) coordinators no later than the 7th of the month following the use. This use report will contain the total amounts of products used for pest control including common name and active ingredient. 2. A Monthly Summary of Pesticide Use Report (State of California form PR-ENF-060) will be submitted by the 10th of each month to the Santa Clara County Agricultural Commissioner by the Vegetation Management Unit Manager. 3. A Quarterly Pesticide Use Report summarizing the District's pest control efforts will be prepared by the RRPM coordinators and submitted to the CEO, the Countywide Watershed Programs Unit, and the Public Information Office: This report will include, but not be limited to, a description and cost summary of each alternative used, reports of non-compliance with regulatory requirements or this policy, and a total cost of the pest control program to date. 	Maintenance of site	District	District
BMP HM-13	Herbicide Use in Upland Areas	Application of pre emergence (residual) herbicides to upland areas will not be made within 72 hours of predicted significant rainfall. Predicted significant rainfall for the purposes of this BMP will be described as local rainfall greater than 0.5 inch in a 24-hour period with greater than a 50% probability of precipitation.	Maintenance of site	District	District

**GOLD STREET EDUCATIONAL CENTER
MITIGATION MONITORING AND REPORTING PROGRAM SUMMARY TABLE**

Measure Element #	Environmental Issue	Mitigation Measure	Timeframe for Implementation	Responsibility for Implementation	Responsibility for Oversight
MM-HM-1	Soil Management Plan	<p>A certified industrial hygienist shall prepare a Soil Management Plan and Health and Safety Plan prior to any field boring explorations, grading operations and other land excavation. The plans shall include protocols for collecting soil and ground water samples from borings for hazardous material testing; protocols for chemical analysis of collected samples; appropriate recommendations for remediation of any contaminated soils encountered during soil sample collection and construction; standards for site maintenance; dust control and erosion control; and standards for safety and training for workers involved with borings and excavation.</p> <p>The District shall ensure that the Soil Management Plan and Health and Safety Plan are implemented throughout the project.</p> <p>A Soil Management Plan would also be required for any future excavation on the site associated with the operation of the education center.</p>	<p>Developed prior to construction.</p> <p>Implemented throughout any ground disturbing activities.</p>	<p>District is responsible for developing plan prior to geotechnical investigations and implementing during investigation.</p> <p>Contractor responsible for implementing plan during construction.</p>	District
WATER QUALITY					
BMP WQ-1	Groundwater Management	<p>If high levels of groundwater in a work area is encountered, the water will be pumped out of the work site. If necessary to protect water quality, the water will be directed into specifically constructed infiltration basins, holding ponds, or areas with vegetation to remove sediment prior to the water re-entering a receiving water body. Water pumped into vegetated areas will be pumped in a manner that will not create erosion.</p>	Throughout construction	Contractor	District
BMP WQ-2	Site Maintenance and Cleanup	<p>The work site, areas adjacent to the work site, and access roads will be maintained in an orderly condition, free and clear from debris and discarded materials. Personnel will not sweep, grade, or flush surplus materials, rubbish, debris, or dust into storm drains or waterways. Upon completion of work, all building materials, debris, unused materials, concrete forms, and other construction-related materials will be removed from the work site.</p>	Throughout construction	Contractor	District

**GOLD STREET EDUCATIONAL CENTER
MITIGATION MONITORING AND REPORTING PROGRAM SUMMARY TABLE**

Measure Element #	Environmental Issue	Mitigation Measure	Timeframe for Implementation	Responsibility for Implementation	Responsibility for Oversight
BMP WQ-3	Water Pollution Control	<p>Oily, greasy, or sediment laden substances or other material that originate from the project operations and may degrade the quality of surface water or adversely affect aquatic life, fish, or wildlife will not be allowed to enter, or be placed where they may later enter, any waterway.</p> <p>The project will not increase the turbidity of any watercourse flowing past the construction site by taking all necessary precautions to limit the increase in turbidity as follows:</p> <ol style="list-style-type: none"> 1. where natural turbidity is between 0 and 50 Nephelometric Turbidity Units (NTU), increases will not exceed 5 percent; 2. where natural turbidity is greater than 50 NTU, increases will not exceed 10 percent; 	Throughout construction	Contractor	District
BMP WQ-4	Stormwater Pollution Prevention	<p>Suitable erosion control, sediment control, source control, treatment control, material management, and non-stormwater management BMPs will be implemented consistent with the latest edition of the California Stormwater Quality Association "Stormwater Best Management Practices Handbook," which is available at www.cabmphandbooks.com.</p>	Throughout construction	Contractor	District
BMP WQ-5	Sanitary/Septic Waste Management	<p>Temporary sanitary facilities will be located on jobs that last multiple days in compliance with California Division of Occupational Safety and Health (Cal/OSHA) regulation 8 CCR 1526. All temporary sanitary facilities will be placed outside of the creek channel and flood plain and removed when no longer necessary.</p>	Throughout construction	Contractor	District
BMP WQ-6	Well or Exploratory Boring Materials Management	<p>All materials or waters generated during exploratory boring construction, or other activities associated with exploratory borings, will be safely handled, properly managed, and disposed of according to all applicable federal, state, and local statutes. In no case will these materials and/or waters be allowed to enter, or potentially enter, on- or off-site storm sewers, dry wells, or waterways. Such materials/waters must not be allowed to move off the site.</p>	During geotechnical investigations	Contractor	District

**GOLD STREET EDUCATIONAL CENTER
MITIGATION MONITORING AND REPORTING PROGRAM SUMMARY TABLE**

Measure Element #	Environmental Issue	Mitigation Measure	Timeframe for Implementation	Responsibility for Implementation	Responsibility for Oversight
BMP WQ-7	Well or Exploratory Boring Contaminant Protection	<p>Any substances or materials that may degrade groundwater quality will not be allowed to enter any well or boring. Lubricants used on drill bits, drill pipe, or tremie pipe will not be comprised of oily or greasy substances or other materials that may degrade groundwater quality.</p> <p>Well openings or entrances will be sealed or secured in such a way as to prevent the introduction of contaminants.</p>	During geotechnical investigations	Contractor	District
BMP WQ-8	Exploratory Boring Destruction	<p>All borings should be backfilled within 24 hours of termination of testing. Borings will not be left in such a condition as to allow for the introduction of surface waters or foreign materials into them. Borings will be secured such that they do not endanger public health.</p> <p>All borings must be properly destroyed by backfilling with acceptable sealing materials. Acceptable sealing materials are:</p> <ol style="list-style-type: none"> 1. 27 sack neat cement (four 94-pound bags/55-gallon drum), 2. 10 sack cement sand grout, or 3. hydrated high solids 20 percent bentonite slurry. <p>No soil cuttings may be used for backfilling boreholes. No bentonite chips or pellets may be used to backfill borings.</p> <p>Free fall of sealing material will not be allowed if greater than 30 feet or if more than 3 feet of standing water exists in borehole. A tremie pipe must be used to place the cement sealing material if exploratory boring is over 30 feet deep or if more than 3 feet of standing water exists in borehole.</p> <p>Exploratory borings located in Geologic Setting Zone 4 (bedrock) may be backfilled with borehole cuttings from total depth of the boring up to a depth of 50 feet from the surface grade. The top 50 feet of the borehole must be backfilled with above described sealing materials.</p>	During geotechnical investigations	Contractor	District

**GOLD STREET EDUCATIONAL CENTER
MITIGATION MONITORING AND REPORTING PROGRAM SUMMARY TABLE**

Measure Element #	Environmental Issue	Mitigation Measure	Timeframe for Implementation	Responsibility for Implementation	Responsibility for Oversight
NOISE					
BMP NO-1	Residential Noise Management	<p>The District will implement practices that minimize disturbances to residential neighborhoods surrounding work sites.</p> <ol style="list-style-type: none"> 1. In general, work will be conducted during normal working hours. Extending weekday hours and working weekends may be necessary to complete the projects. 2. Internal combustion engines will be equipped with adequate mufflers. 3. Excessive idling of vehicles will be prohibited. 4. All construction equipment will be equipped with manufacturer's standard noise control devices. 5. The arrival and departure of trucks hauling material will be limited to the hours of construction. 	Throughout construction	Contractor	District
TRANSPORTATION / TRAFFIC					
BMP TR-1	Public Safety Measures	Fences, barriers, lights, flagging, guards, and signs will be installed as determined appropriate by the public agency having jurisdiction, to give adequate warning to the public of the construction and of any dangerous condition to be encountered as a result thereof.	Throughout construction	Contractor	District