

NO SCALE

SITE

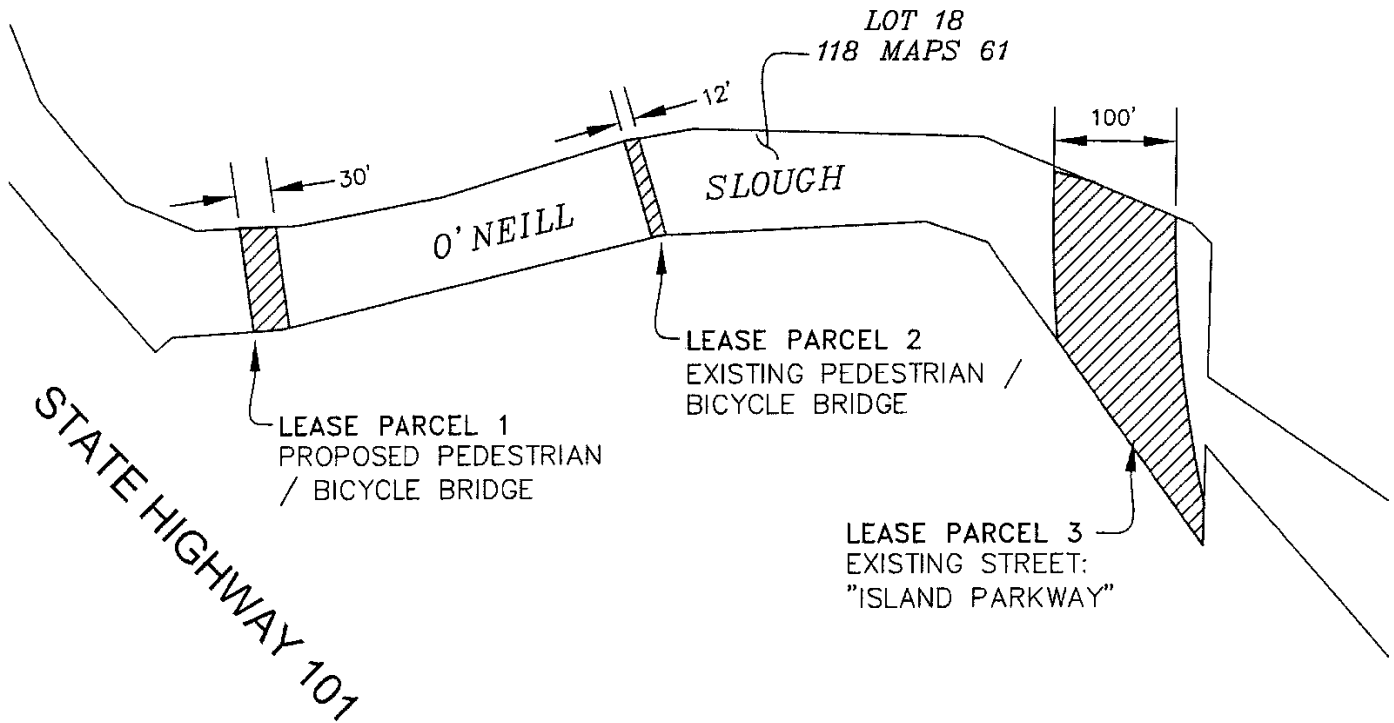

CITY OF BELMONT - PEDESTRIAN BRIDGES & ISLAND PARKWAY

NO SCALE

LOCATION



MAP SOURCE: USGS QUAD

Exhibit A

W 26340
 CITY OF BELMONT
 APN 040-360-440
 GENERAL LEASE -
 PUBLIC AGENCY USE
 SAN MATEO COUNTY



This Exhibit is solely for purposes of generally defining the lease premises, is based on unverified information provided by the Lessee or other parties and is not intended to be, nor shall it be construed as, a waiver or limitation of any State interest in the subject or any other property.