

CALENDAR ITEM
C32

A) 5, 9

S) 6

08/19/03
PRC 5720 WP 5720.1
T. Lipscomb

GENERAL LEASE - RECREATIONAL USE

APPLICANT:

Darlene A. Brock (Sole Trustee of The Trust of William L. and Darlene A. Brock)

AREA, LAND TYPE, AND LOCATION:

.09 acres, more or less, of sovereign lands in the Sacramento River, near the city of Sacramento, Sacramento County.

AUTHORIZED USE:

Continued use and maintenance of an existing floating boat dock and walkway.

LEASE TERM:

Ten years, beginning August 5, 2001.

CONSIDERATION:

\$260 per year; with the State reserving the right to fix a different rent periodically during the lease term, as provided in the lease.

SPECIFIC LEASE PROVISIONS:

Liability insurance with coverage of no less than \$500,000 Combined Single Limit.

OTHER PERTINENT INFORMATION:

1. On July 6, 1995, the Commission authorized a General Lease - Recreational Use with Darlene A. Brock (Sole Trustee of the Trust of William L. and Darlene A. Brock). That lease expired on August 5, 2001. Darlene A. Brock is now applying for a new General Lease - Recreational Use. Applicant does not qualify for a rent-free Recreational Pier Lease because a single-family residence is not located on the upland.

CALENDAR ITEM NO. **C32** (CONT'D)

2. Pursuant to the Commission's delegation of authority and the State CEQA Guidelines (Title 14, California Code of Regulations, section 15061), the staff has determined that this activity is exempt from the requirements of the CEQA as a categorically exempt project. The project is exempt under Class 1, Existing Facilities; Title 2, California Code of Regulations, section 2905 (a)(2).

Authority: Public Resources Code section 21084 and Title 14, California Code of Regulations, section 15300 and Title 2, California Code of Regulations, section 2905.

3. This activity involves lands identified as possessing significant environmental values pursuant to Public Resources Code sections 6370, et seq. Based upon the staff's consultation with the persons nominating such lands and through the CEQA review process, it is the staff's opinion that the project, as proposed, is consistent with its use classification.

EXHIBIT:

- A. Site and Location Map

PERMIT STREAMLINING ACT DEADLINE:

N/A

RECOMMENDED ACTION:

IT IS RECOMMENDED THAT THE COMMISSION:

CEQA FINDING:

FIND THAT THE ACTIVITY IS EXEMPT FROM THE REQUIREMENTS OF THE CEQA PURSUANT TO TITLE 14, CALIFORNIA CODE OF REGULATIONS, SECTION 15061 AS A CATEGORICALLY EXEMPT PROJECT, CLASS 1, EXISTING FACILITIES; TITLE 2, CALIFORNIA CODE OF REGULATIONS, SECTION 2905 (a)(2).

SIGNIFICANT LANDS INVENTORY FINDING:

FIND THAT THIS ACTIVITY IS CONSISTENT WITH THE USE CLASSIFICATION DESIGNATED BY THE COMMISSION FOR THE LAND PURSUANT TO PUBLIC RESOURCES CODE SECTIONS 6370, ET SEQ.

CALENDAR ITEM NO. C32 (CONT'D)

AUTHORIZATION:

AUTHORIZE ISSUANCE TO DARLENE A. BROCK (SOLE TRUSTEE OF THE TRUST OF WILLIAM L. AND DARLENE A. BROCK) OF A GENERAL LEASE - RECREATIONAL USE, BEGINNING AUGUST 5, 2001, FOR A TERM OF TEN YEARS, FOR CONTINUED USE AND MAINTENANCE OF AN EXISTING FLOATING BOAT DOCK AND WALKWAY ON THE LAND SHOWN ON EXHIBIT A ATTACHED AND BY THIS REFERENCE MADE A PART HEREOF; ANNUAL RENT IN THE AMOUNT OF \$260 PER YEAR, WITH THE STATE RESERVING THE RIGHT TO FIX A DIFFERENT RENT PERIODICALLY DURING THE LEASE TERM, AS PROVIDED IN THE LEASE; LIABILITY INSURANCE WITH COMBINED SINGLE LIMIT COVERAGE OF NO LESS THAN \$500,000.

Site Plan and Location Map

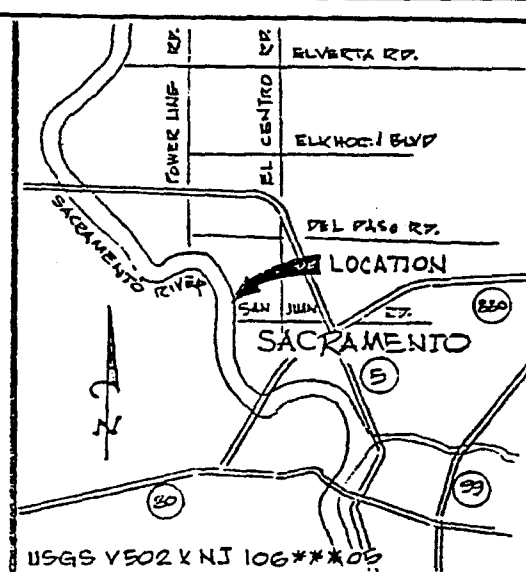

VICINITY MAP?

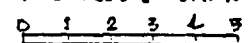

1) PILING WILL BE A MINIMUM OF 3' ABOVE THE FLOOD PLAIN ELEVATION.

2) THREE SINGLE PILING
AND ONE 2-PILE
DOLPHIN ARE PROPOSED

3) USGS-M.S.L. DATUM USED
FOR ALL ELEVATIONS.

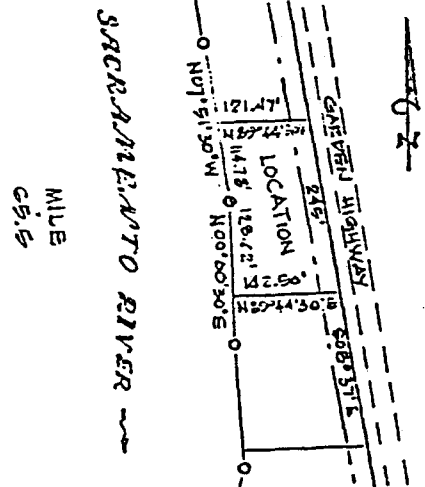

SCALE : 1" = 230'

APPLICATION BY:
DARLENE A. BROCK

Scale: 1" = 50'

DATE: 22 JULY 1982
SHEET: 1 OF 1

Section 3
Exhibit A
WP 5720