

MINUTE ITEM

This Calendar Item No. C38 was approved as Minute Item No. 38 by the California State Lands Commission by a vote of 3 to 0 at its 4-9-02 meeting.

CALENDAR ITEM

C38

A 4

04/09/02

S 1

PRC 7939.1

B. Young

CONTINUATION OF RENT

LESSEE:

Brockway Springs of Tahoe Property Owners Association
P.O. Box 276
Kings Beach, CA 96143

AREA, LAND TYPE, AND LOCATION:

0.08 acres, more or less, of sovereign lands in Lake Tahoe, Brockway, Placer County.

AUTHORIZED USE:

Continued use and maintenance of 26 mooring buoys and two marker buoys as shown on the attached Exhibit A.

LEASE TERM:

Ten years, beginning February 12, 1997.

CONSIDERATION:

This lease provides that Lessor may modify the rent periodically during the lease term for the 26 mooring buoys and two marker buoys. Pursuant to this provision, staff has conducted a review of the rent under this lease, and recommends that the rent be continued at \$2,468 per year, effective February 12, 2002.

EXHIBIT:

A. Site and Location Map

RECOMMENDED ACTION:

IT IS RECOMMENDED THAT THE COMMISSION:

CEQA FINDING:

FIND THAT THE ACTIVITY IS NOT SUBJECT TO THE REQUIREMENTS OF THE CEQA PURSUANT TO TITLE 14, CALIFORNIA CODE OF REGULATIONS, SECTION 15060(c)(3)

CALENDAR PAGE	000214
MINUTE PAGE	000820

CALENDAR ITEM NO. C38 (CONT'D)

BECAUSE THE ACTIVITY IS NOT A PROJECT AS DEFINED BY
PUBLIC RESOURCES CODE SECTION 21065 AND TITLE 14,
CALIFORNIA CODE OF REGULATIONS, SECTION 15378.

AUTHORIZATION:

APPROVE THE CONTINUATION OF RENT FOR LEASE NO.
PRC 7939.1 AT \$2,468 PER YEAR, EFFECTIVE FEBRUARY 12, 2002.

CALENDAR PAGE	000215
MINUTE PAGE	000821

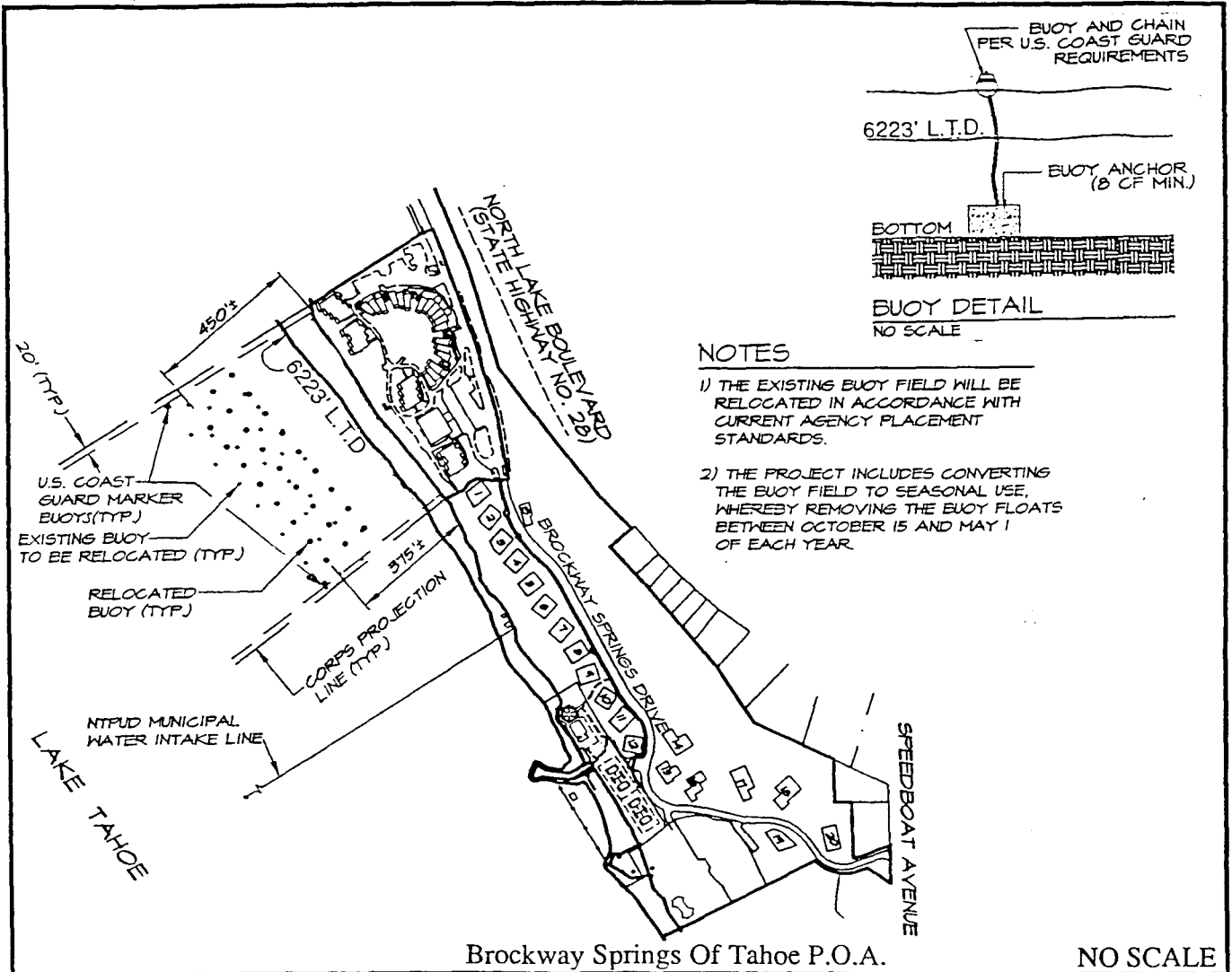

- NOTES**
- 1) THE EXISTING BUOY FIELD WILL BE RELOCATED IN ACCORDANCE WITH CURRENT AGENCY PLACEMENT STANDARDS.
 - 2) THE PROJECT INCLUDES CONVERTING THE BUOY FIELD TO SEASONAL USE, WHEREBY REMOVING THE BUOY FLOATS BETWEEN OCTOBER 15 AND MAY 1 OF EACH YEAR.

Brockway Springs Of Tahoe P.O.A. NO SCALE

LOCATION MAP

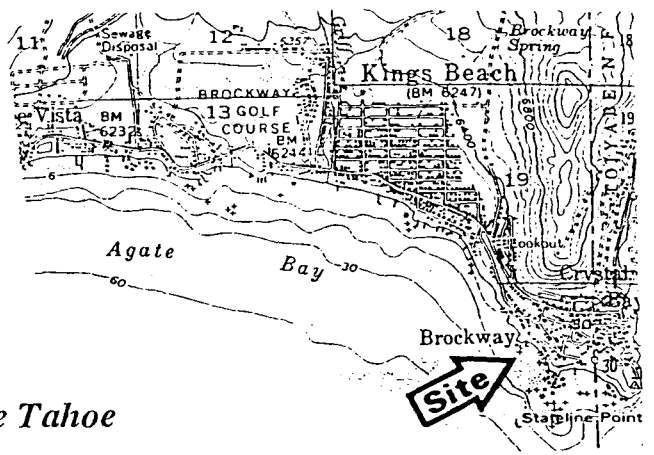

Lake Tahoe

NO SCALE

EXHIBIT A

PRC 7939.1
 APNs 90-380-039&90-390-05
 Lake Tahoe
 Placer County

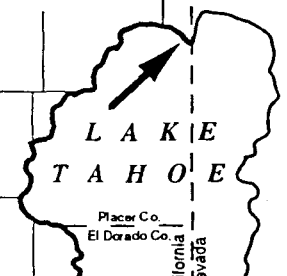

This exhibit is solely for purposes of generally defining the lease premises, is based on unverified information provided by lessee or other parties, and is not intended to be, nor shall it be construed to as a waiver or limitation of any state interest in the subject or any other property.

CALENDAR PAGE 090216
 MINUTE PAGE 090216