

MINUTE ITEM

This Calendar Item No. C07 was approved as Minute Item No. 07 by the California State Lands Commission by a vote of 3 to 0 at its 4-9-02 meeting.

**CALENDAR ITEM
C07**

A 4
S 1

04/09/02
W 21434
B. Dugal
PRC 8380.9

RECREATIONAL PIER LEASE

APPLICANTS:

Duncan Hallberg Schlicht Trust established December 14, 1993 and
Dudley Gustav Schlicht Trust established December 14, 1993

AREA, LAND TYPE, AND LOCATION:

Sovereign lands in Lake Tahoe, located near Tahoe City, Placer County.

PROPOSED AUTHORIZED USE:

The retention of two existing mooring buoys not previously authorized by the Commission as shown on the attached Exhibit A.

LEASE TERM:

Ten years, beginning April 1, 2002.

CONSIDERATION:

No monetary consideration pursuant to Public Resources Code section 6503.5.

SPECIFIC LEASE PROVISIONS:

Insurance:

Liability insurance in the amount of no less than \$300,000.

Other:

This lease is conditioned on the Applicants obtaining authorization from the Tahoe Regional Planning Agency (TRPA) for the mooring buoys within two years after the adoption of the Lake Tahoe Shorezone Amendments-Draft Environmental Impact Statement (EIS) and approval of the ordinances based on the EIS.

OTHER PERTINENT INFORMATION:

- 1. Applicants own the uplands.

CALENDAR PAGE 000041
MINUTE PAGE 000046

CALENDAR ITEM NO. C07 (CONT'D)

2. The Applicants have applied for a Recreational Pier Lease for the retention of two existing mooring buoys.
3. Applicants qualify for a Recreational Pier Lease because they are natural persons who have improved the littoral lands with, and use the uplands for, single-family dwelling.
4. Pursuant to the Commission's delegation of authority and the State CEQA Guidelines (Title 14, California Code of Regulations, section 15061), the staff has determined that this activity is exempt from the requirements of the CEQA as a categorically exempt project. The project is exempt under Class 3, New Construction of Small Structures; Title 2, California Code of Regulations, section 2905 (c)(3).

Authority: Public Resources Code section 21084 and Title 14, California Code of Regulations, section 15300 and Title 2, California Code of Regulations, section 2905.

5. This activity involves lands identified as possessing significant environmental values pursuant to Public Resources Code sections 6370, et seq. Based upon the staff's consultation with the persons nominating such lands and through the CEQA review process, it is the staff's opinion that the project, as proposed, is consistent with its use classification.

EXHIBIT:

- A. Location and Site Map.

PERMIT STREAMLINING ACT DEADLINE:

N/A

RECOMMENDED ACTION:

IT IS RECOMMENDED THAT THE COMMISSION:

CEQA FINDING:

FIND THAT THE ACTIVITY IS EXEMPT FROM THE REQUIREMENTS OF THE CEQA PURSUANT TO TITLE 14, CALIFORNIA CODE OF REGULATIONS, SECTION 15061 AS A CATEGORICALLY EXEMPT PROJECT, CLASS 3; NEW CONSTRUCTION OF SMALL STRUCTURES; TITLE 2, CALIFORNIA CODE OF REGULATIONS, SECTION 2905 (c)(3).

CALENDAR PAGE	000042
MINUTE PAGE	0000647

CALENDAR ITEM NO. C07 (CONT'D)

SIGNIFICANT LANDS INVENTORY FINDING:

FIND THAT THIS ACTIVITY IS CONSISTENT WITH THE USE CLASSIFICATION DESIGNATED BY THE COMMISSION FOR THE LAND PURSUANT TO PUBLIC RESOURCES CODE SECTIONS 6370, ET SEQ.

AUTHORIZATION:

AUTHORIZE THE ISSUANCE TO DUNCAN HALLBERG SCHLICHT TRUST ESTABLISHED DECEMBER 14, 1993, AND DUDLEY GUSTAV SCHLICHT TRUST ESTABLISHED DECEMBER 14, 1993, OF A TEN-YEAR RECREATIONAL PIER LEASE, BEGINNING APRIL 1, 2002, FOR THE RETENTION OF TWO EXISTING MOORING BUOYS ON THE LAND SHOWN ON EXHIBIT A ATTACHED AND BY THIS REFERENCE MADE A PART HEREOF; NO MONETARY CONSIDERATION PURSUANT TO PUBLIC RESOURCES CODE SECTION 6503.5; LIABILITY INSURANCE IN THE AMOUNT OF NO LESS THAN \$300,000.

CALENDAR PAGE	006043
MINUTE PAGE	0000648

NO SCALE

SITE MAP

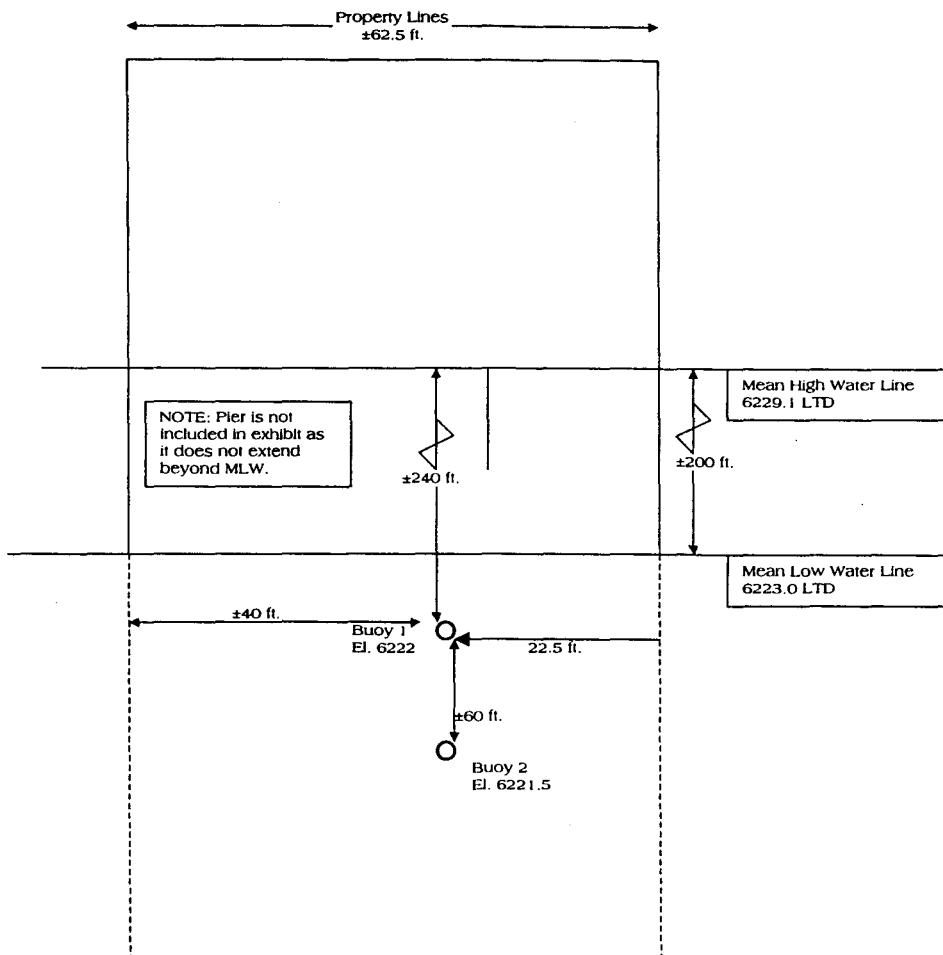

160 SIERRA TERRACE RD
APN 094-150-019

NO SCALE

LOCATION MAP

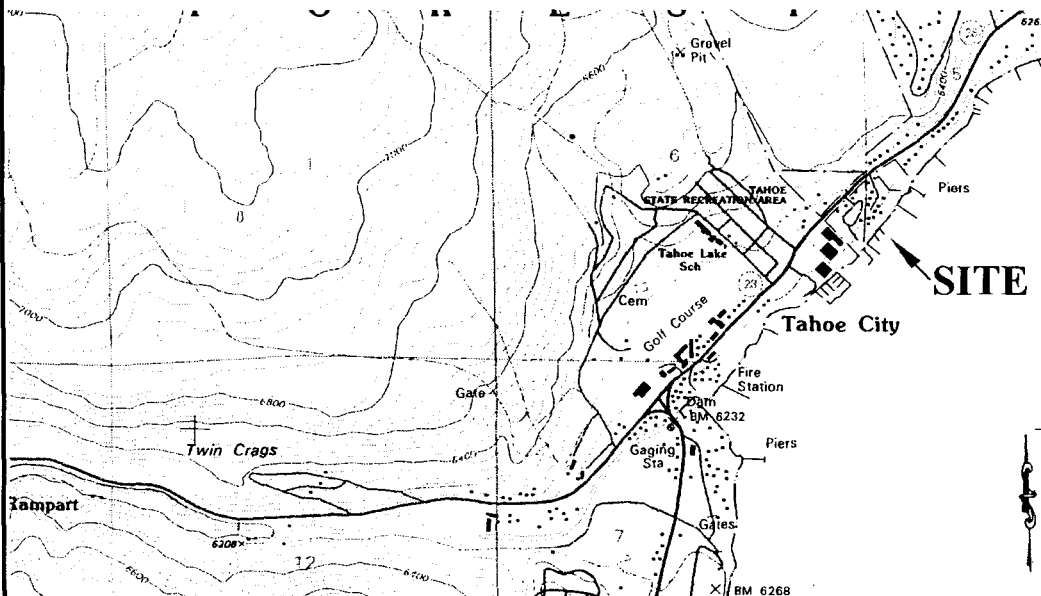
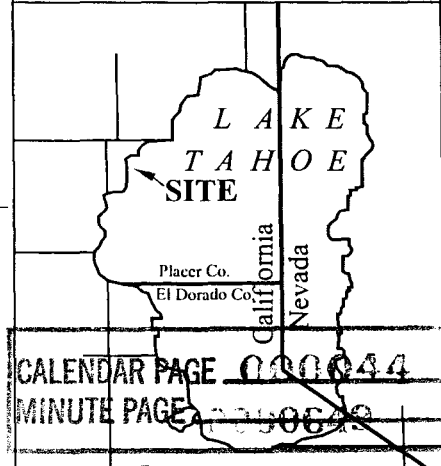

Exhibit A

W21434
D&D SCHLICHT
RPL COVERING
TWO MOORING BUOYS
PLACER COUNTY



This Exhibit is solely for purposes of generally defining the lease premises, is based on unverified information provided by the Lessee or other parties and is not intended to be, nor shall it be construed as, a waiver or limitation of any state interest in the subject or any other property.

CALENDAR PAGE 000044
MINUTE PAGE 000044

JAK