

MINUTE ITEM

This Calendar Item No. C21 was approved as Minute Item No. 21 by the California State Lands Commission by a vote of 3 to 0 at its 4-20-00 meeting.

**CALENDAR ITEM
C21**

A 2, 8, 10

S 4, 5, 6

April 20, 2000

W 25559

D. Jones

PRC 8157.9

PERMIT FOR TELEPHONE RIGHT OF WAY

LESSEE:

Worldwide Fiber Networks, Inc.
11719 NE - 95th Street
Vancouver, Washington 98682

AREA, LAND TYPE, AND LOCATION:

Sovereign lands located in the Sacramento River in the cities of Sacramento and West Sacramento, Yolo and Sacramento counties; the Sacramento River near the town of Knights Landing, Yolo County; the Sacramento River in the city of Redding, Shasta County; the Sacramento River, in the city of Tehama, Tehama County; and in the Fall River near the town of Fall River Mills, Shasta County.

AUTHORIZED USE:

The installation, operation, maintenance, and use of the following:

Sacramento River, cities of Sacramento and West Sacramento: A 12-inch steel casing, with 16 high density polyethylene (HDPE) innerducts, one of which will contain one fiber optic cable with approximately 184 fibers.

Sacramento River near Knights Landing: An 8-inch steel casing, with six HDPE innerducts, one of which will contain one fiber optic cable with approximately 184 fibers.

Sacramento River in the city of Redding: A 10-inch steel casing, with 15 HDPE innerducts, one of which will contain one fiber optic cable with approximately 184 fibers.

CALENDAR PAGE	0000220
MINUTE PAGE	0007911

CALENDAR ITEM NO. C21 (CONTD)

Sacramento River, in the city of Tehama: An 8-inch steel casing, with five HDPE innerducts, one of which will contain one fiber optic cable with approximately 184 fibers.

Fall River, Shasta County: A 12-inch steel casing, with 17 HDPE innerducts, one of which contains one fiber optic cable with approximately 184 fibers.

LEASE TERM:

Continuous use plus one year, commencing April 20, 2000.

CONSIDERATION:

No monetary consideration shall be charged for the placement, use and maintenance of fiber optic cables or other similar transmission devices placed by those qualifying under the scope of Section 7901 of the Public Utilities Code.

OTHER PERTINENT INFORMATION:

1. Applicant has the right to use the uplands adjoining the lease premises.
2. Worldwide Fiber Networks, Inc., is proposing to construct a fiber optic cable system from the Oregon border near Tulelake to Sacramento, California. The purpose of the project is to increase the capacity and speed of long distance voice and data transmission service both within the the state of California and between California and the national/international fiber optic network. Except for the Sacramento River crossing in the city of Redding, all of the system will be installed through directional boring underneath each of the sovereign waterways. The Sacramento River crossing in the city of Redding will be attached to the Deschutes Road bridge.
3. Pursuant to California Public Utilities Code Section 7901 (PUC §7901), telephone corporations may construct and operate lines and equipment along and upon any public road, highway or the navigable waters of the State, without payment of compensation, provided the lines and facilities do not interfere with the public use. Applicant has provided staff with a Certificate of Public Convenience and Necessity (CPCN) issued by the California Public Utilities Commission (CPUC) authorizing Applicant to operate as a facilities-based carrier of intrastate telecommunications services offered by communications common carriers in California. Applicant has also been authorized to provide interstate and international telecommunications service in California as a common carrier.

CALENDAR ITEM NO. C21 (CONT'D)

4. A Mitigated Negative Declaration was prepared and adopted for this project by the California Public Utilities Commission. The California State Lands Commission's staff has reviewed such document.

A Mitigation Monitoring Program was adopted by the California Public Utilities Commission.

5. This activity involves lands identified as possessing significant environmental values pursuant to Public Resources Code sections 6370, et seq. Based upon the staff's consultation with the persons nominating such lands and through the CEQA review process, it is the staff's opinion that the project, as proposed, is consistent with its use classification.

APPROVALS OBTAINED:

U. S. Army Corps of Engineers, The Reclamation Board, California Department of Transportation, city of Sacramento, city of West Sacramento, Yolo County, Shasta County, Tehama County.

EXHIBITS:

A-1 through	
A-5	Site Maps
B-1 through	
B-5	Lease Descriptions
C-1 through	
C-5	Location Maps

PERMIT STREAMLINING ACT DEADLINE:

June 6, 2000.

RECOMMENDED ACTION:

IT IS RECOMMENDED THAT THE COMMISSION:

CEQA FINDING:

FIND THAT A MITIGATED NEGATIVE DECLARATION AND A MITIGATION MONITORING PROGRAM WERE PREPARED AND ADOPTED FOR THIS PROJECT BY CALIFORNIA PUBLIC UTILITIES COMMISSION AND THAT THE COMMISSION HAS REVIEWED AND CONSIDERED THE INFORMATION CONTAINED THEREIN.

CALENDAR ITEM NO. C21 (CONT'D)

ADOPT THE MITIGATION MONITORING PROGRAM, AS CONTAINED ON FILE IN THE OFFICES OF THE CALIFORNIA STATE LANDS COMMISSION.

SIGNIFICANT LANDS INVENTORY FINDING:

FIND THAT THIS ACTIVITY IS CONSISTENT WITH THE USE CLASSIFICATION DESIGNATED BY THE COMMISSION FOR THE LAND PURSUANT TO PUBLIC RESOURCES CODE SECTIONS 6370, ET SEQ.

AUTHORIZATION:

AUTHORIZE ISSUANCE TO WORLDWIDE FIBER NETWORKS, INC., OF A PERMIT FOR TELEPHONE RIGHT OF WAY, FOR A TERM OF CONTINUOUS USE PLUS ONE YEAR BEGINNING APRIL 20, 2000, FOR THE INSTALLATION, OPERATION, MAINTENANCE, AND USE OF THE FOLLOWING:

SACRAMENTO RIVER, CITIES OF SACRAMENTO AND WEST SACRAMENTO: A 12-INCH STEEL CASING, WITH 16 HIGH DENSITY POLYETHYLENE (HDPE) INNERDUCTS, ONE OF WHICH WILL CONTAIN ONE FIBER OPTIC CABLE, WITH APPROXIMATELY 184 FIBERS;

SACRAMENTO RIVER NEAR KNIGHTS LANDING: AN 8-INCH STEEL CASING, WITH SIX HDPE INNERDUCTS, ONE OF WHICH WILL CONTAIN ONE FIBER OPTIC CABLE WITH APPROXIMATELY 184 FIBERS;

SACRAMENTO RIVER IN THE CITY OF REDDING: A 10-INCH STEEL CASING, WITH 15 HDPE INNERDUCTS, ONE OF WHICH WILL CONTAIN ONE FIBER OPTIC CABLE WITH APPROXIMATELY 184 FIBERS;

SACRAMENTO RIVER, IN THE CITY OF TEHAMA: A 9-INCH STEEL CASING, WITH FIVE HDPE INNERDUCTS, ONE OF WHICH WILL CONTAIN ONE FIBER OPTIC CABLE WITH APPROXIMATELY 184 FIBERS;

CALENDAR ITEM NO. C21 (CONT'D)

FALL RIVER, SHASTA COUNTY: A 12-INCH STEEL CASING, WITH 17 HDPE INNERDUCTS, ONE OF WHICH CONTAINS ONE FIBER OPTIC CABLE WITH APPROXIMATELY 184 FIBERS;

ON THE LAND DESCRIBED AND SHOWN ON EXHIBITS A-1 THROUGH A-5 AND B-1 THROUGH B-5 ATTACHED AND BY THIS REFERENCE MADE A PART HEREOF; CONSIDERATION: EXEMPT PURSUANT TO SECTION 7901 OF THE PUBLIC UTILITIES CODE.

NOTES

- 1.) FIELD SURVEY WAS CONDUCTED ON 4-19-99.
- 2.) THIS DRAWING IS INTENDED TO BE A PERMIT APPLICATION DRAWING ONLY.

CASING DETAIL

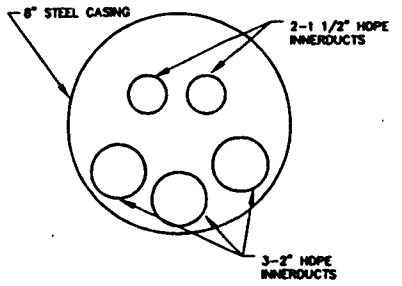

BENCHMARK

CITY OF SACRAMENTO #297-B3F EL.=28.845 1929 DATUM

BASIS OF BEARINGS

CENTERLINE OF E STREET BETWEEN 3rd STREET AND 2nd STREET IN CITY OF WEST SACRAMENTO AS BEING S81° 31' 55"E, PER MONUMENTS FOUND BASED ON RECORD OF SURVEY FILED IN BOOK 13 OF MAPS AND SURVEY PAGE 61 YOLO COUNTY RECORDS.

LEGAL DESCRIPTION

A STRIP OF LAND IN THE CITIES OF SACRAMENTO AND WEST SACRAMENTO, CALIFORNIA. THE CENTERLINE BEING DESCRIBED AS FOLLOWS: BEGINNING AT POINT ON THE ORDINARY HIGH WATER MARK ON THE WEST BANK OF THE SACRAMENTO RIVER WHICH BEARS N80° 58' 35"E, 244.83 FEET FROM THE CENTERLINE INTERSECTION OF 2nd STREET AND "E" STREET IN THE CITY OF WEST SACRAMENTO, CALIFORNIA; SAID CENTERLINE INTERSECTION BEING MARKED BY A SPIKE WITH A PUNCH MARK SET IN CONCRETE THENCE FROM SAID POINT OF BEGINNING S71° 05' 09"E APPROXIMATELY 600 FEET TO THE ORDINARY HIGH WATER MARK IN THE EAST BANK OF THE SACRAMENTO RIVER.

EXCEPTING THEREFROM ANY PORTION OF SAID STRIP LYING LANDWARD OF THE ORDINARY HIGH WATER MARK.

THE SIDELINES OF SAID STRIP SHALL BE SHORTENED OR LENGTHENED AS REQUIRED TO INTERSECT SAID ADOPTED HIGH WATER LINE.

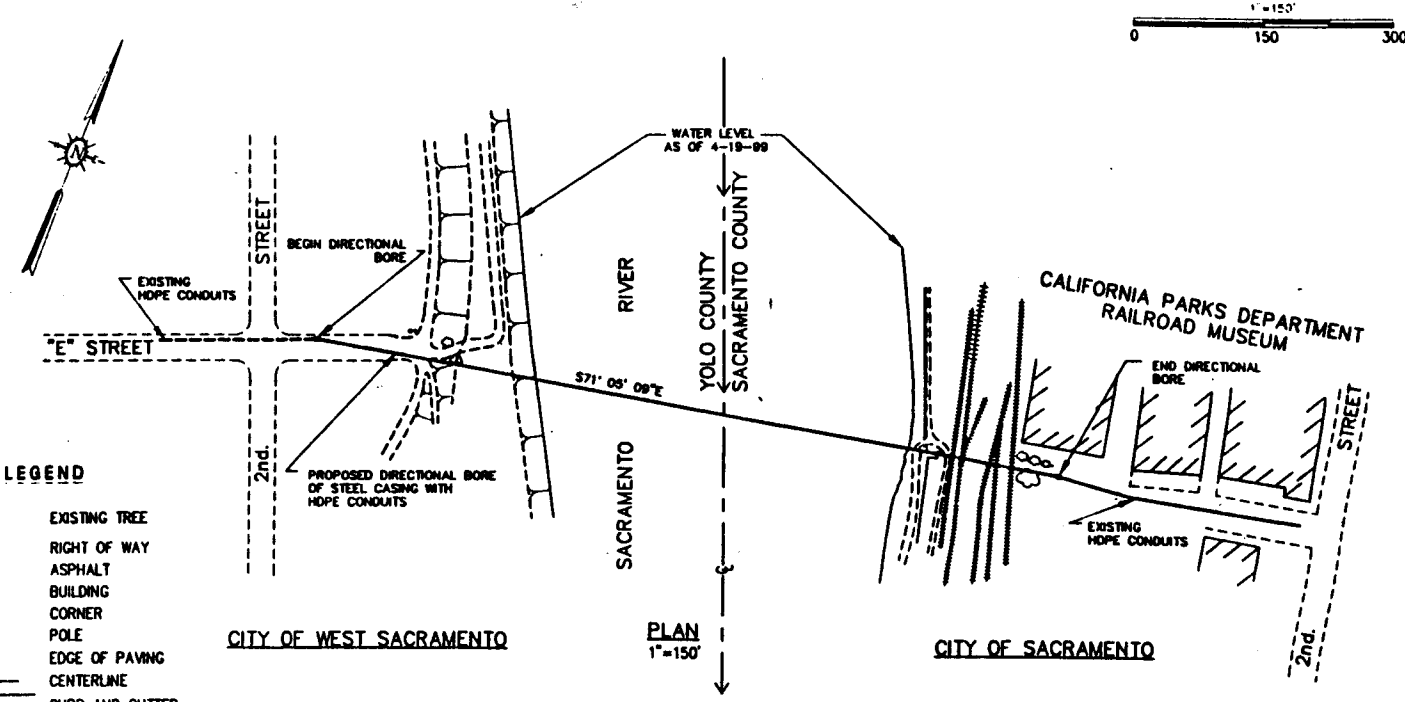

LEGEND

- EXISTING TREE
- R/W RIGHT OF WAY
- AC ASPHALT
- BLDG. BUILDING
- COR. CORNER
- POLE
- E.P. EDGE OF PAVING
- CENTERLINE
- CURB AND GUTTER
- ▬ BUILDINGS

PLAN
1"=150'

NOTE: MINIMUM VERTICAL CLEARANCE BORE TO GROUND PROFILE MINIMUM 40' ALL LOCATIONS

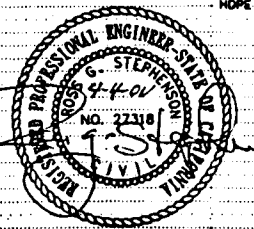
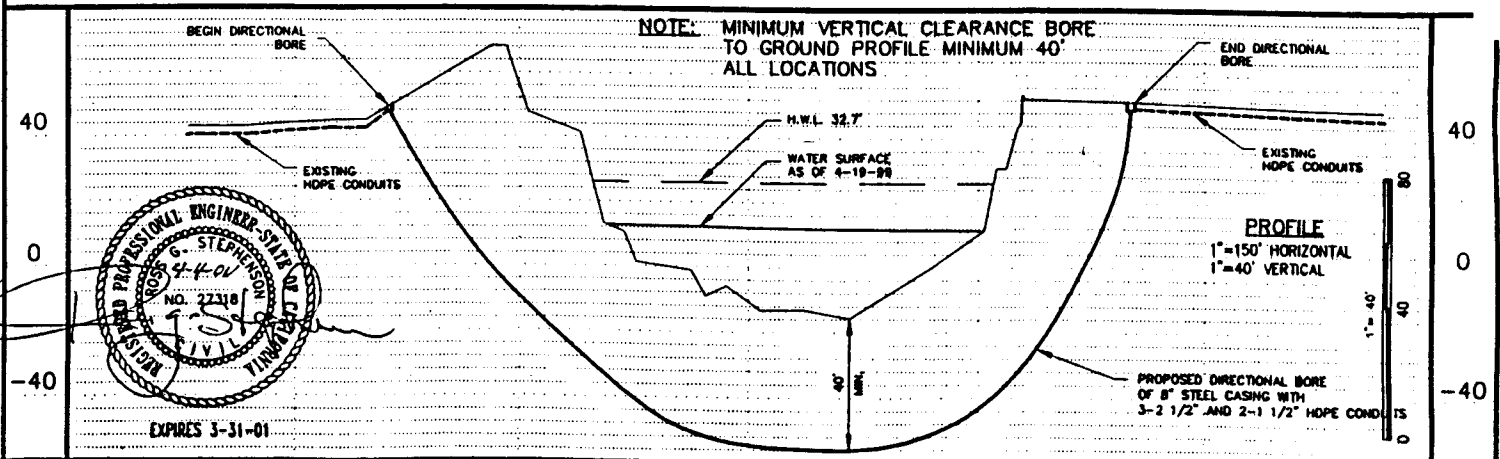

Ros G. Stephenson
Assoc. Engineer
and Surveying
0010225
0011916

SURVEY FOR CAL LANDS PERMIT ACROSS THE SACRAMENTO RIVER AT CITIES OF SACRAMENTO AND WEST SACRAMENTO, CALIFORNIA

REV.	DESCRIPTION	DATE
1	PLAN SCALE CHG	5-5-99
2	H.W.L. 32.7	7-26-99
3	CHANGE TO 40' MIN	11-9-99

CUST. JOB NO:	DWG. NAME SITE 1
DESIGNED BY: PCS	SCALE: N.T.S.
DRAWN BY: SH	DATE: 4/26/99
CHECKED BY: PCS	JOB NO: 18-99

RCSA JOB # 18-99
DWG. OF 1

NOTES

- 1.) FIELD SURVEY WAS CONDUCTED ON 5-7-99.
- 2.) THIS DRAWING IS INTENDED TO BE A PERMIT APPLICATION DRAWING ONLY.

CASING DETAIL

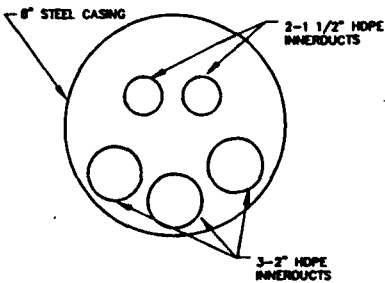

BENCHMARK

REBAR IN CONCRETE, 69' RT. STA. 18+10 OF TEHAMA COUNTY BRIDGE PLANS AT THE SACRAMENTO RIVER, PROJECT NO. ES-4-2, SHEET 4 OF 10 EL. = 210.78

BASIS OF BEARINGS

CENTERLINE OF 2nd STREET BETWEEN "C" STREET AND "D" STREET IN CITY OF TEHAMA AS BEING N7° 15' 13"W PER MONUMENTS FOUND BASED ON A MAP FILED IN BOOK 1 OF PARCEL MAPS AT PAGE 63, TEHAMA COUNTY RECORDS.

LEGAL DESCRIPTION

A STRIP OF LAND 11' IN WIDTH SITUATE IN RANCHO SAUCOS AND RANCHO RIO DE LOS MOLINOS, CITY OF TEHAMA, CALIFORNIA, THE CENTERLINE BEING DESCRIBED AS FOLLOWS:
 COMMENCING AT A POINT ON THE ORDINARY HIGH WATER MARK ON THE WEST BANK OF THE SACRAMENTO RIVER WHICH BEARS N72° 50' 46"E 395.51 FEET FROM THE CENTERLINE INTERSECTION OF 2nd STREET AND "C" STREET IN THE CITY OF TEHAMA, CALIFORNIA; SAID CENTERLINE INTERSECTION BEING MARKED BY A NAIL SET IN THE ASPHALT; THENCE FROM SAID POINT OF COMMENCEMENT N76° 10' 07" E, TO THE TRUE POINT OF BEGINNING OF SAID STRIP AT THE ORDINARY LOW WATER MARK ON THE WEST BANK OF THE SACRAMENTO RIVER; THENCE N76° 10' 07"E, APPROXIMATELY 500 FEET TO THE ORDINARY LOW WATER MARK ON THE EAST BANK OF THE SACRAMENTO RIVER.
 EXCEPTING THEREFROM ANY PORTION OF SAID STRIP LYING LANDWARD OF THE ORDINARY LOW WATER MARK.
 THE SIDELINES OF SAID STRIP SHALL BE SHORTENED OR LENGTHENED AS REQUIRED TO INTERSECT SAID ORDINARY LOW WATER MARK.

TEHAMA COUNTY, CALIFORNIA

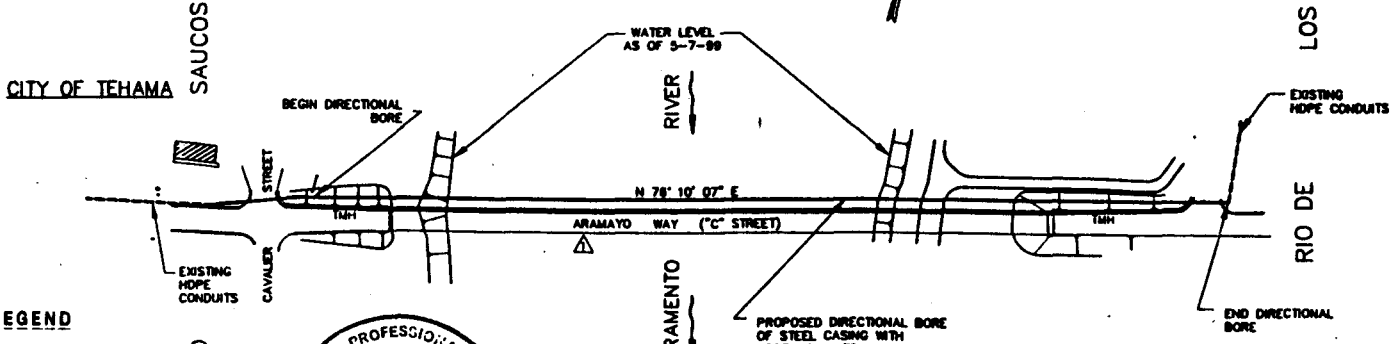
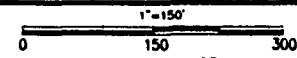

LEGEND

- EXISTING TREE
- RIGHT OF WAY
- ASPHALT
- BUILDING
- CORNER
- POLE
- EDGE OF PAVING
- CENTERLINE
- CURB AND GUTTER
- BUILDINGS

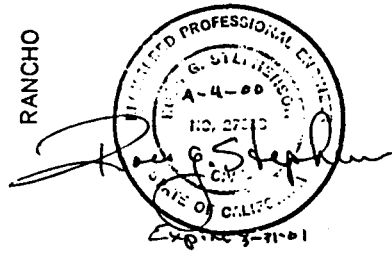

PLAN
1"=150'

NOTE:
DIRECTIONAL BORE TO BE PLACED 20' NORTHERLY AND PARALLEL WITH BRIDGE STRUCTURE. AVOID CONFLICT WITH ABUTMENTS, PIERS AND FOOTINGS.

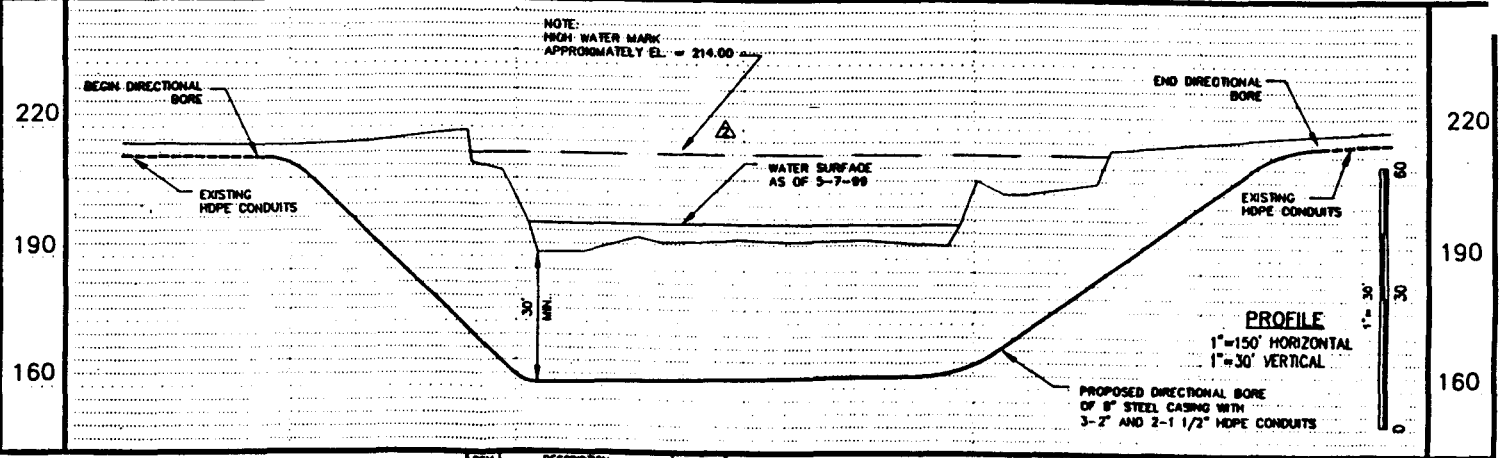

Ross Stephenson Associates, Inc.
 Engineering and Surveying
 1115 S. 1st St., Suite 100
 Chico, CA 95926
 (530) 891-9111
 FAX (530) 891-9112

**SURVEY FOR CAL LANDS PERMIT
 ACROSS THE SACRAMENTO RIVER
 AT THE CITY OF
 TEHAMA, CALIFORNIA**

REV.	DESCRIPTION	DATE
1	ADD STREET NAME	5-13-99
2	H.W.L. & NOTE	7-28-99
3	Revised Legal	9-20-99

CUST. JOB NO.	DWG. NAME	RCSA JOB # 10-99
DESIGNED BY:	SCALE	
DRWN BY:	N.T.S.	
CHECKED BY:	DATE	
	JOB NO.	

DWG. OF 1

NOTES

- 1.) FIELD SURVEY WAS CONDUCTED ON 5-7-99.
- 2.) THIS DRAWING IS INTENDED TO BE A PERMIT APPLICATION DRAWING ONLY.

CASING DETAIL

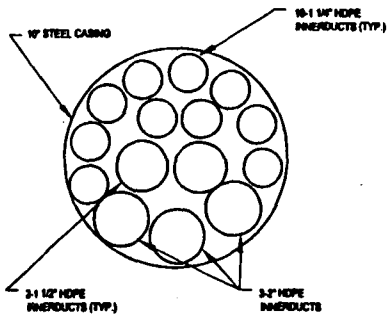

BENCHMARK

SHASTA COUNTY DEPARTMENT OF PUBLIC WORKS
B.M. - 3C ELEVATION = 389.37

BASIS OF BEARINGS

THE CENTERLINE OF THE DESCHUTES ROAD BRIDGE OVER THE SACRAMENTO RIVER AS BEING N05°45' 45\"/>

LEGAL DESCRIPTION

A STRIP OF LAND 42.58 FEET IN WIDTH IN RANCHO SAN BUENAVENTURA AND IN SECTION 7, TOWNSHIP 30 NORTH, RANGE 3 WEST, M.D.M. IN THE UNINCORPORATED TERRITORY OF SHASTA COUNTY, CALIFORNIA, THE CENTERLINE OF WHICH IS DESCRIBED AS FOLLOWS:

COMMENCING AT A POINT ON THE CENTERLINE OF DESCHUTES ROAD SAID POINT BEING THE END OF CURVE AT STATION 119+03.12 AS SHOWN ON THE CONSTRUCTION PLANS FOR THE SACRAMENTO RIVER BRIDGE AT DESCHUTES ROAD, SHASTA COUNTY PROJECT NO. S-1073141 AS FILED IN THE SHASTA COUNTY DEPARTMENT OF PUBLIC WORKS RECORDS; THENCE N05°45' 45\"/>

EXCEPTING THEREFROM ANY PORTION OF SAID STRIP LYING LANDWARD OF THE ORDINARY LOW WATER MARK.

THE SIDELINE OF THE ABOVE DESCRIBED STRIP TO BE SHORTENED OR LENGTHENED AS REQUIRED TO START AND END AT THE ORDINARY LOW WATER MARK.

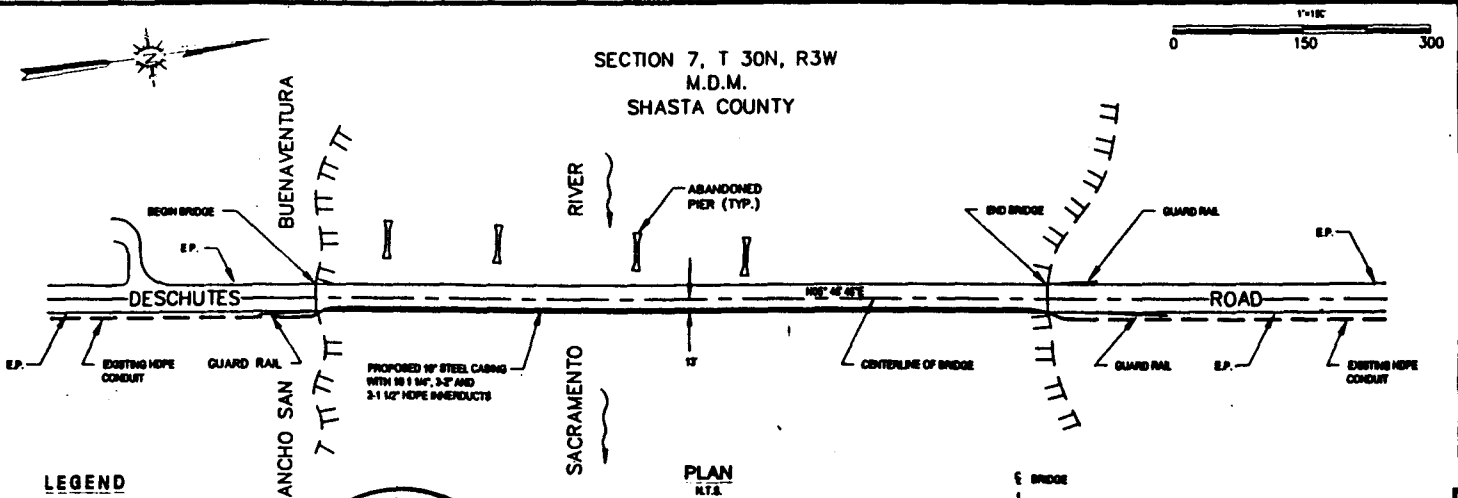

LEGEND

- ◊ EXISTING TREE
- R/W RIGHT OF WAY
- AC ASPHALT
- BLDG. BUILDING
- COR. CORNER
- POLE
- E.P. EDGE OF PAVING
- CENTERLINE
- CURB AND GUTTER
- ▤ BUILDINGS

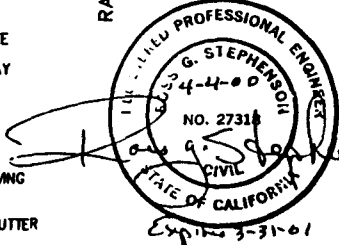

PLAN
N.T.S.

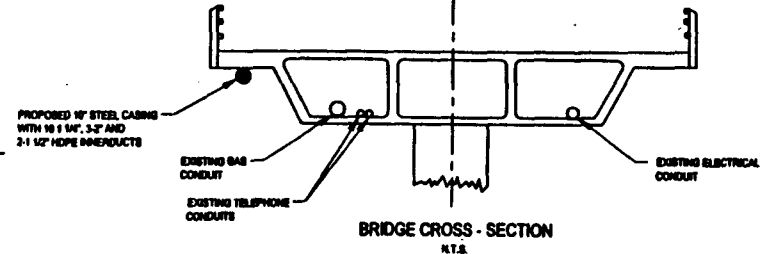

BRIDGE CROSS - SECTION
N.T.S.

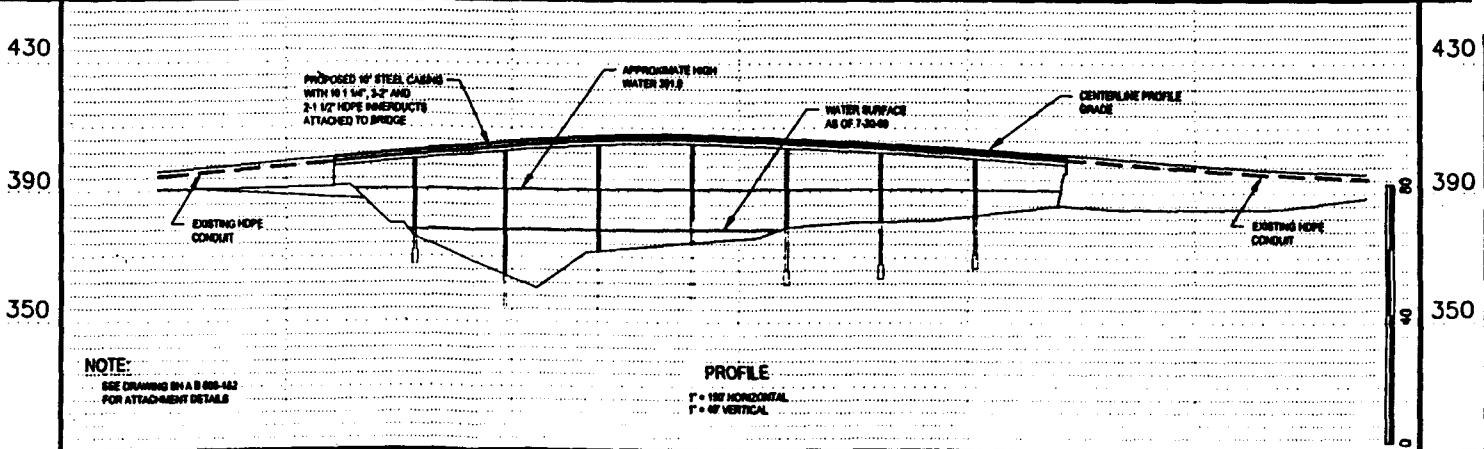

NOTE:
SEE DRAWING IN A 8 888-142 FOR ATTACHMENT DETAILS

PROFILE
1\"/>

G. Stephenson
Professional Engineer
Civil Engineering
1000 Main Street, Suite 100
Marysville, CA 95901
Phone: 707-754-1119
Fax: 707-754-1120

**SURVEY FOR CAL LANDS PERMIT
ACROSS THE SACRAMENTO RIVER
AT DESCHUTES ROAD, SHASTA
COUNTY, CALIFORNIA**

REV.	DESCRIPTION	DATE
1	Revised Legal Notes	5/22/99

CUST. JOB NO.	DWG. NAME
	SITE 4
DESIGNED BY:	SCALE
RCS	N.T.S.
DRAWN BY:	DATE
LH	5/12/99
CHECKED BY:	JOB NO.
RCS	16-99

RCSA JOB # 16-99
DWG.
1 OF 1

NOTES

- 1.) FIELD SURVEY WAS CONDUCTED ON 05-01-99.
- 2.) THIS DRAWING IS INTENDED TO BE A PERMIT APPLICATION DRAWING ONLY.

CASING DETAIL

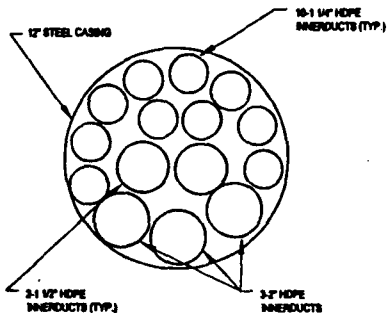

BENCHMARK

SHASTA COUNTY DEPARTMENT OF PUBLIC WORKS
B.M.X-197 ELEVATION=3313.776

BASIS OF BEARINGS

THE SOUTH LINE OF SECTION 29, T 38N, R. 4E MDM,
AS BEING N89°38' 30"W.

LEGAL DESCRIPTION

A STRIP OF LAND ELEVEN FEET (11') IN WIDTH SITUATE IN SECTION 29, TOWNSHIP 38 NORTH, RANGE 4 EAST, M.D.M., IN THE UNINCORPORATED TERRITORY OF SHASTA COUNTY, CALIFORNIA, THE CENTERLINE OF WHICH IS DESCRIBED AS FOLLOWS:

COMMENCING AT A POINT WHICH LIES N61°25' 33"E, 3787.72 FEET, FROM THE SOUTH WEST CORNER OF SAID SECTION 29; THENCE N10° 02' 24"W, TO THE TRUE POINT OF BEGINNING ON THE ORDINARY LOW WATER MARK ON THE SOUTH BANK OF FALL RIVER; THENCE N10° 02' 24"W, APPROXIMATELY 150 FEET TO THE ORDINARY LOW WATER MARK ON THE NORTH BANK OF FALL RIVER.

EXCEPTION THE BEYOND ANY PORTION OF SAID LYING LANDWARD OF THE ORDINARY LOW WATER MARK.

THE SIDELINES OF SAID STRIP SHALL BE SHORTENED OR LENGTHEN AS REQUIRED TO INTERSECT SAID ORDINARY LOW WATER MARKS.

REGISTERED PROFESSIONAL ENGINEER
ROSS G. STEPHENSON
ASSOCIATES, INC.
ENGINEERING AND SURVEYING

**SURVEY FOR CAL LANDS PERMIT
ACROSS THE FALL RIVER IN
SHASTA COUNTY, CALIFORNIA**

SECTION 29, T 38N, R4E
M.D.M.
SHASTA COUNTY

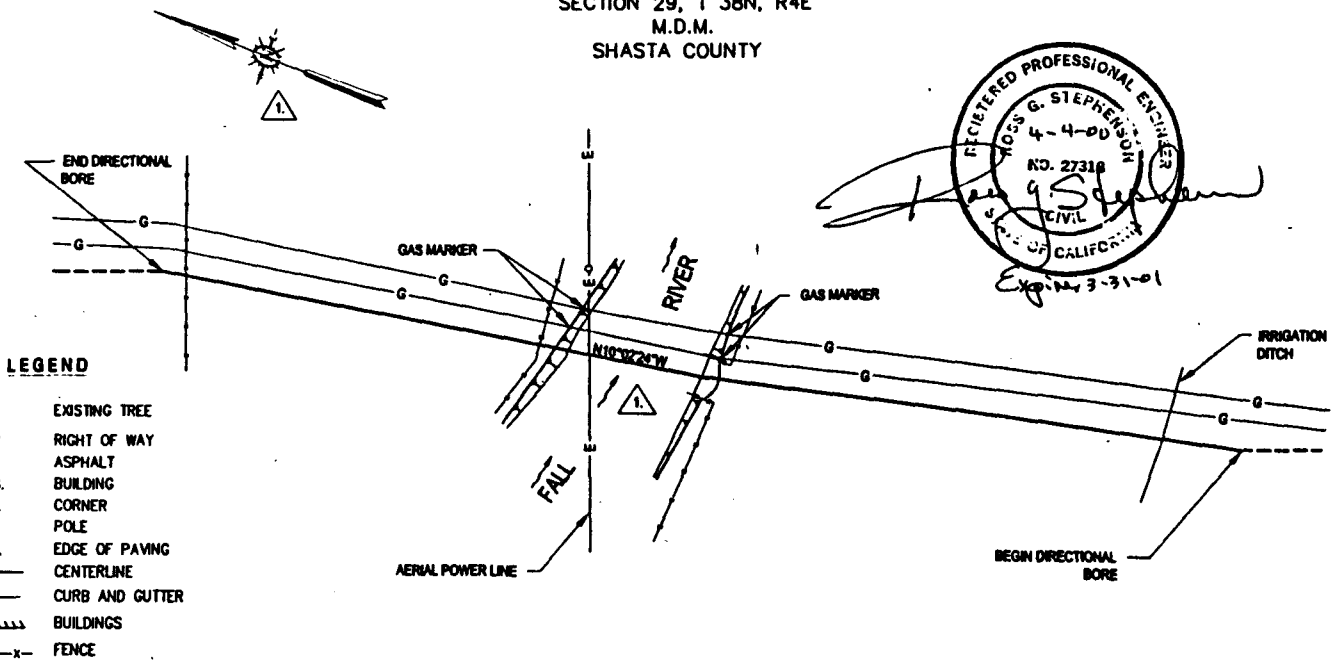
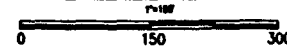

LEGEND

- EXISTING TREE
- R/W RIGHT OF WAY
- AC ASPHALT
- BLDG. BUILDING
- COR. CORNER
- POLE
- E.P. EDGE OF PAVING
- CENTERLINE
- CURB AND GUTTER
- BUILDINGS
- FENCE

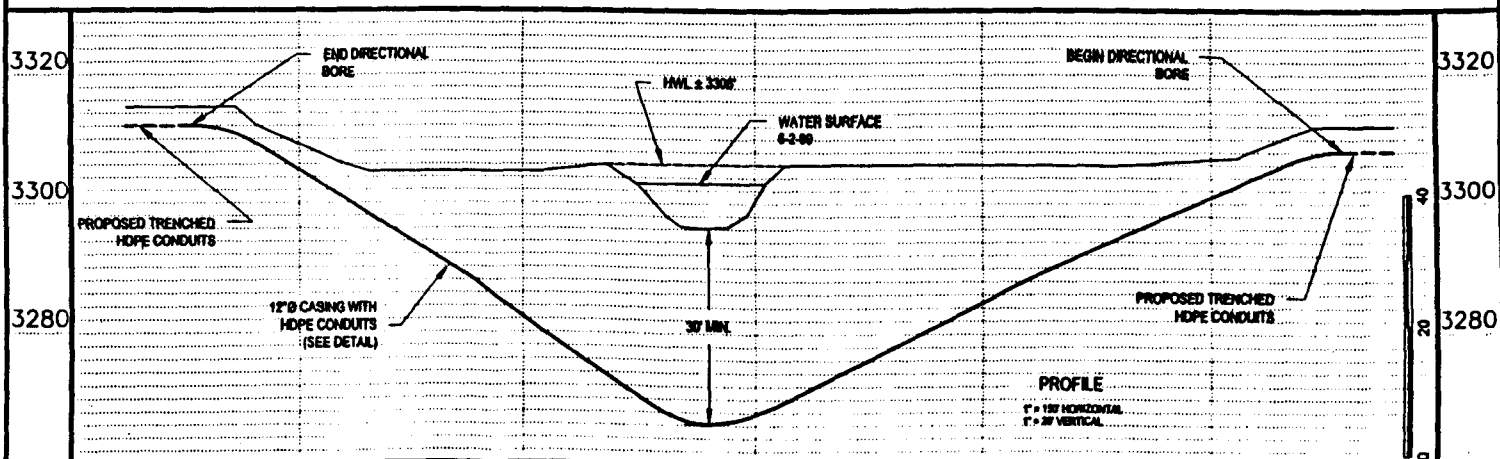

REV	DESCRIPTION	DATE	CUST. JOB NO.	DWG. NAME	RCSA JOB #
1	ROTATED NORTH ARROW & ADDED BEARING	7-26-99	16-99	SITE 5	
2	Revised Legal Description	9-2-00			

DESIGNED BY: RGS	SCALE: N.T.S.
DRAWN BY: LH	DATE: 06/04/99
CHECKED BY: RGS	JOB NO. 16-99

EXHIBIT A-5

H:\JOBS\2000\01-00\SITE5.dwg Tue Apr 04 15:36:48 2000

PAGE 001 OF 023

DWG.
1 OF 1

Legal Description

A strip of land eleven feet (11') in width situate in the City of Sacramento and the City of West Sacramento, California, the centerlines being described as follows:

Beginning at a point on the ordinary high water mark on the West bank of the Sacramento River which bears S 80° 58' 35" E, 244.83 feet from the Centerline Intersection of 2nd Street and "E" Street in the City of West Sacramento, California, said centerline intersection being marked by a spike with a punch mark set in concrete; thence from said Point of Beginning, S 71° 05' 09" E, approximately 600 feet to the ordinary high water mark on the East Bank of the Sacramento River.

The sidelines of the above described strip to be shortened or lengthened as required to start and end at the ordinary high water mark.

Excepting therefrom any portion of said strip lying landward of the ordinary high water mark.

Basis of Bearing

The centerline of "E" Street between 3rd Street and 2nd Street in the City of West Sacramento as being S 81° 31' 55" E, per monuments found based on Record of Survey filed in Book 13 of Maps and Surveys at Page 61, Yolo County Records.

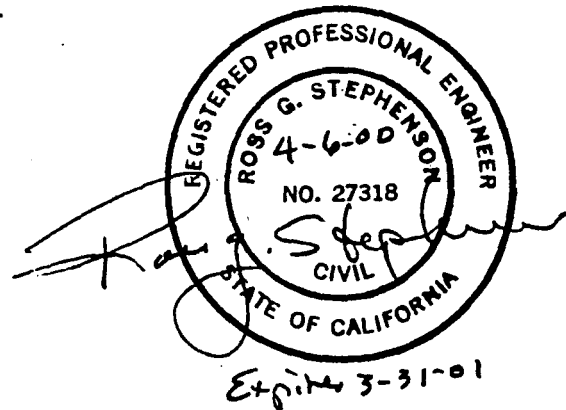

CALENDAR PAGE	0000230
MINUTE PAGE	0007921

EXHIBIT B-2

RGSA Job No. 01-00

Legal Description

A strip of land eleven feet (11') in width situate in Section 14, Township 11 North, Range 2 East, M.D.B. & M. in Yolo County and Sutter County, California the centerline of which is described as follows:

Commencing at a point on the ordinary high water mark on the North bank of the Sacramento River (Sutter County), which bears N 75° 56' 53" W, 1140.51 feet from the California Reclamation Board Survey Point NR-14 A, said point being a scribed "X" in concrete bridge abutment; thence from said point of commencement S 11° 00' 34" E, to the True Point of Beginning of said strip at the ordinary low water mark on the North bank of the Sacramento River; thence S 11° 00' 34" E approximately 400 feet to the ordinary low water mark on the South bank (Yolo County) of the Sacramento River.

The sidelines of the above described strip to be shortened or lengthened as required to start and end at the ordinary low water mark.

Excepting therefrom any portion of said strip lying landward of the ordinary low water mark.

Basis of Bearings

Being N 21° 20' 00" E between centerline monuments at 2nd Street and Railroad Street and Front Street and Railroad Street. California Coordinate System of 1927 Zone 2. Knights Landing, CA.

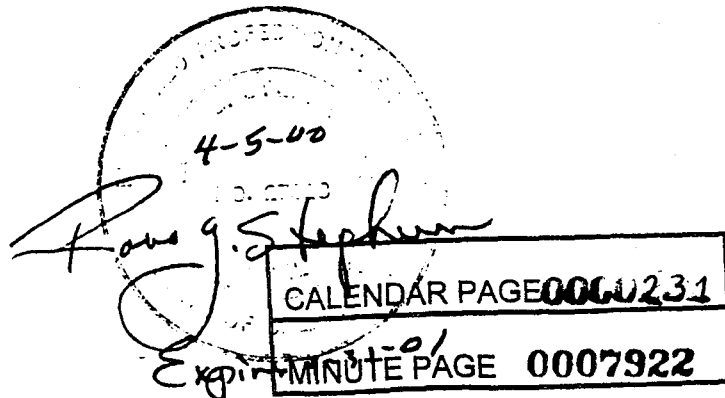

EXHIBIT B-3

RGSA Job No. 01-00

Legal Description

A strip of land eleven feet (11') in width situate in Rancho Saucos and Rancho Rio de Los Molinos, City of Tehama, California, the centerline of which is described as follows:

Commencing at a point on the ordinary high water mark on the West bank of the Sacramento River which bears N 72° 50' 46" E, 395.51 feet from the Centerline Intersection of 2nd Street and "C" Street in the City of Tehama, California; said Centerline Intersection being marked by a nail set in asphalt; thence from said Point of Commencement N76° 10' 07"E, to the True Point of Beginning of said strip at the ordinary low water mark on the West bank of the Sacramento River; thence, N76° 10' 07"E, approximately 500 feet to the ordinary low water mark on the East bank of the Sacramento River.

The sidelines of the above described strip to be shortened or lengthened as required to start and end at the ordinary low water mark.

Excepting therefrom any portion of said strip lying landward of the ordinary low water mark.

Basis of Bearing

The centerline of 2nd Street between "C" Street and "D" Street in City of Tehama as being N 7° 15' 13" W, per monuments found based on the map filed in Book 1 of Parcel Maps at Page 63, Tehama County Records.

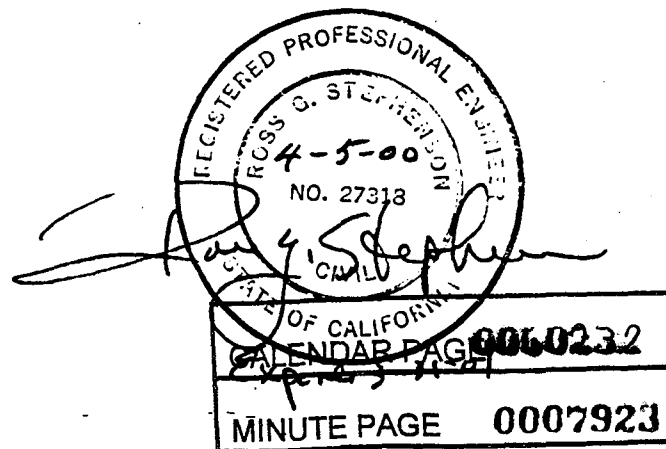

EXHIBIT B-4

01-00

Legal Description

A strip of land 42.58 feet in width situate in Rancho San Buenaventura and in Section 7, Township 30 North, Range 3 West, M.D.M. in the unincorporated territory of Shasta County, California the centerline of which is described as follows:

Commencing at a point on the centerline of Deschutes Road said point being the end of curve at Station 110 + 03.12 as shown on the construction plans for the Sacramento River Bridge at Deschutes Road, Shasta County Project Number S - 1073141 as filed in the Shasta County Department of Public Works Records; thence N 05° 45' 45" E along said centerline to the ordinary low water mark on the South bank of the Sacramento River and the True Point of beginning of said strip of land; thence continuing N 05° 45' 45" E, approximately 430 feet to the ordinary low water mark on the North bank of the Sacramento River and the terminus of said strip of land.

The sidelines of the above described strip to be shortened or lengthened as required to start and end at the ordinary low water mark.

Excepting therefrom any portion of said strip lying landward of the ordinary low water mark.

Basis of Bearing

The centerline of the Deschutes Road Bridge over the Sacramento River as being N 05° 45' 45" E.

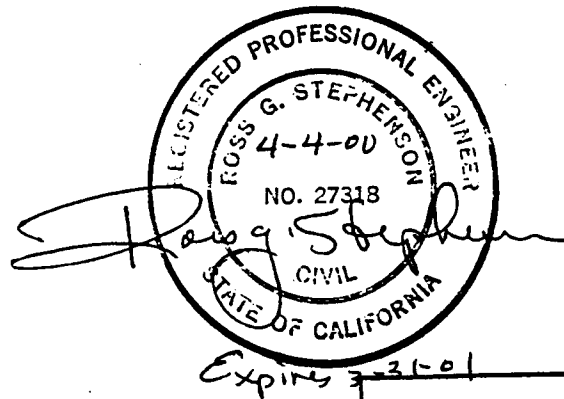

CALENDAR PAGE **0000233**

MINUTE PAGE **0007924**

EXHIBIT B-5

RGSA Job No. 01-00

Legal Description

A strip of land eleven feet (11') in width situate in Section 29, Township 38 North, Range 4 East, M.D.M., in the unincorporated territory of Shasta County, California, the centerline of which is described as follows:

Commencing at a point which lies N 61° 25' 33" E, 3,767.72 feet from the Southwest corner of said Section 29; thence N 10° 02' 24" W, to the True Point of Beginning on the ordinary low water mark on the South Bank of Fall River; thence N 10° 02' 24" W, approximately 150 feet to the ordinary low water mark on the North bank of Fall River.

The sidelines of the above described strip of land to be shortened or lengthened as required to start and end at the ordinary low water mark.

Excepting therefrom any portion of said strip lying landward of the ordinary low water mark.

Basis of Bearing

The south line of Section 29, T 38 N, R 4 E, M.D.M. as being N 89° 38' 30" W.

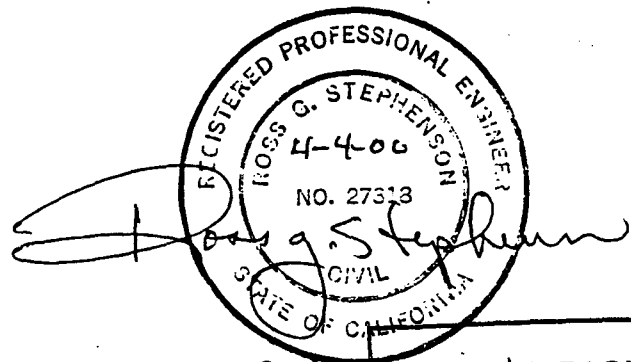

Expires **6/30/2000** **GABENDAR PAGE 0000234**

MINUTE PAGE 0007925

NO SCALE

LOCATION MAP

Sacramento River

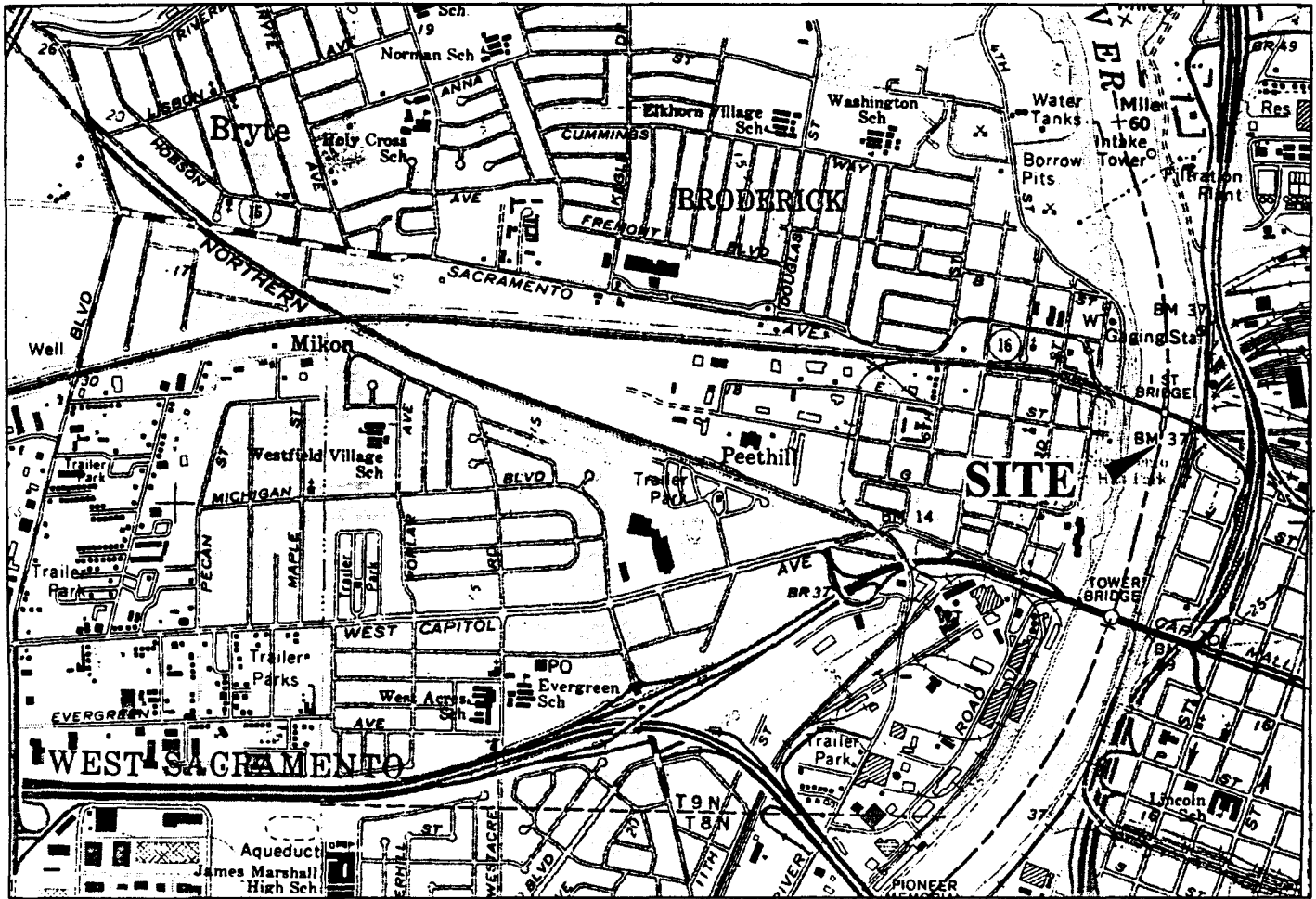

CITY OF WEST SACRAMENTO AND CITY OF SACRAMENTO

NO SCALE

CALIFORNIA MAP



EXHIBIT C-1

W 25559

WORLDWIDE
FIBER NETWORK

Sacramento River
CALENDAR PAGE 000235

SACRAMENTO CO
MINUTE PAGE 0007926
YOLO COUNTY

This Exhibit is solely for purposes of generally defining the lease premises, and is not intended to be, nor shall it be construed as, a waiver of limitation of any state interest in the subject or any other property.

NO SCALE

LOCATION MAP

Sacramento River

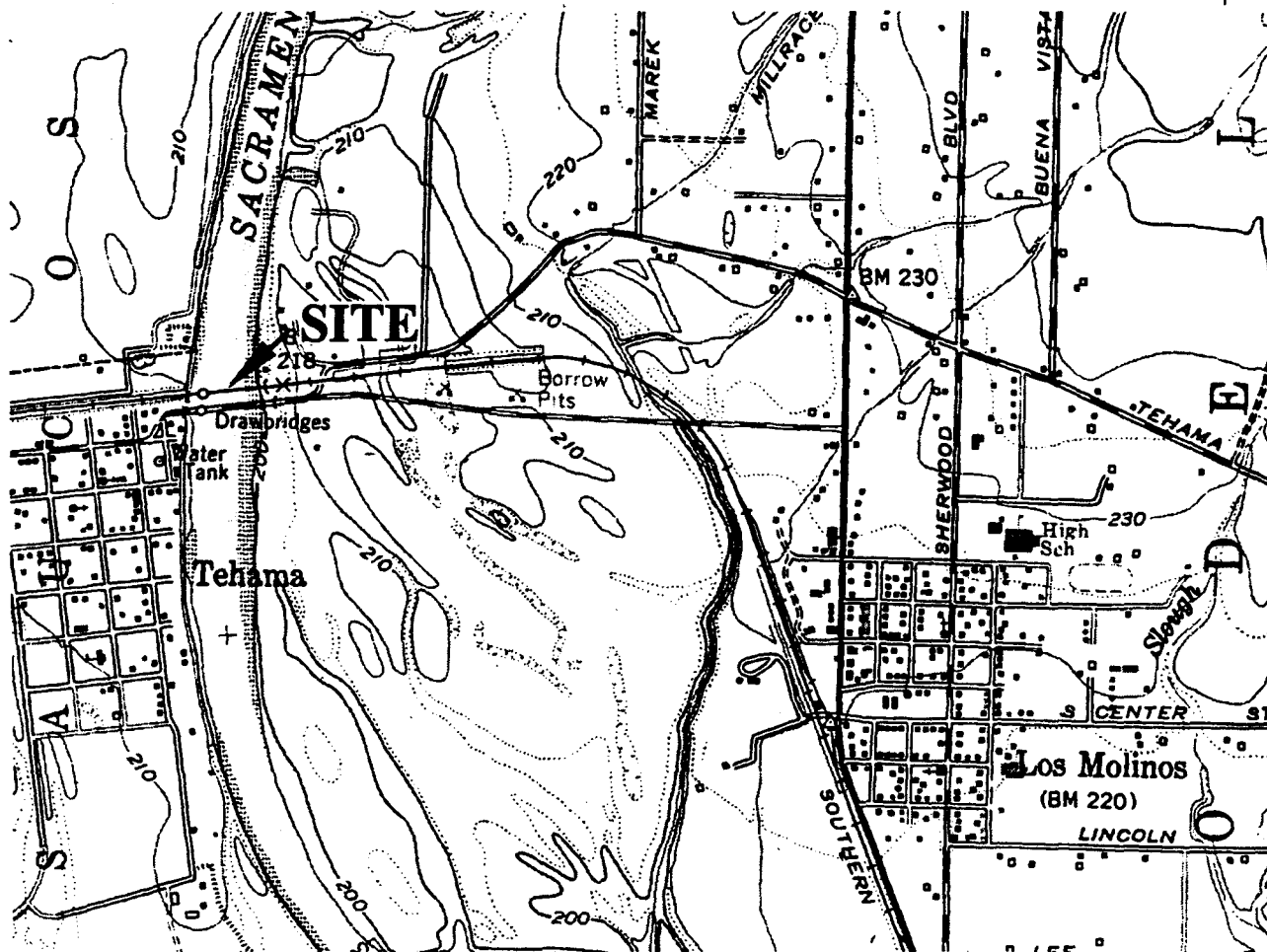

CITY OF TEHAMA

NO SCALE

CALIFORNIA MAP



EXHIBIT C-3

W 25559

WORLDWIDE
FIBER NETWORK

Sacramento River 0000237
CALENDAR PAGE

TEHAMA COUNTY 0007928
MINUTE PAGE

This Exhibit is solely for purposes of generally defining the lease premises, and is not intended to be, nor shall it be construed as, a waiver of limitation of any state interest in the subject or any other property.

NO SCALE

LOCATION MAP

Sacramento River

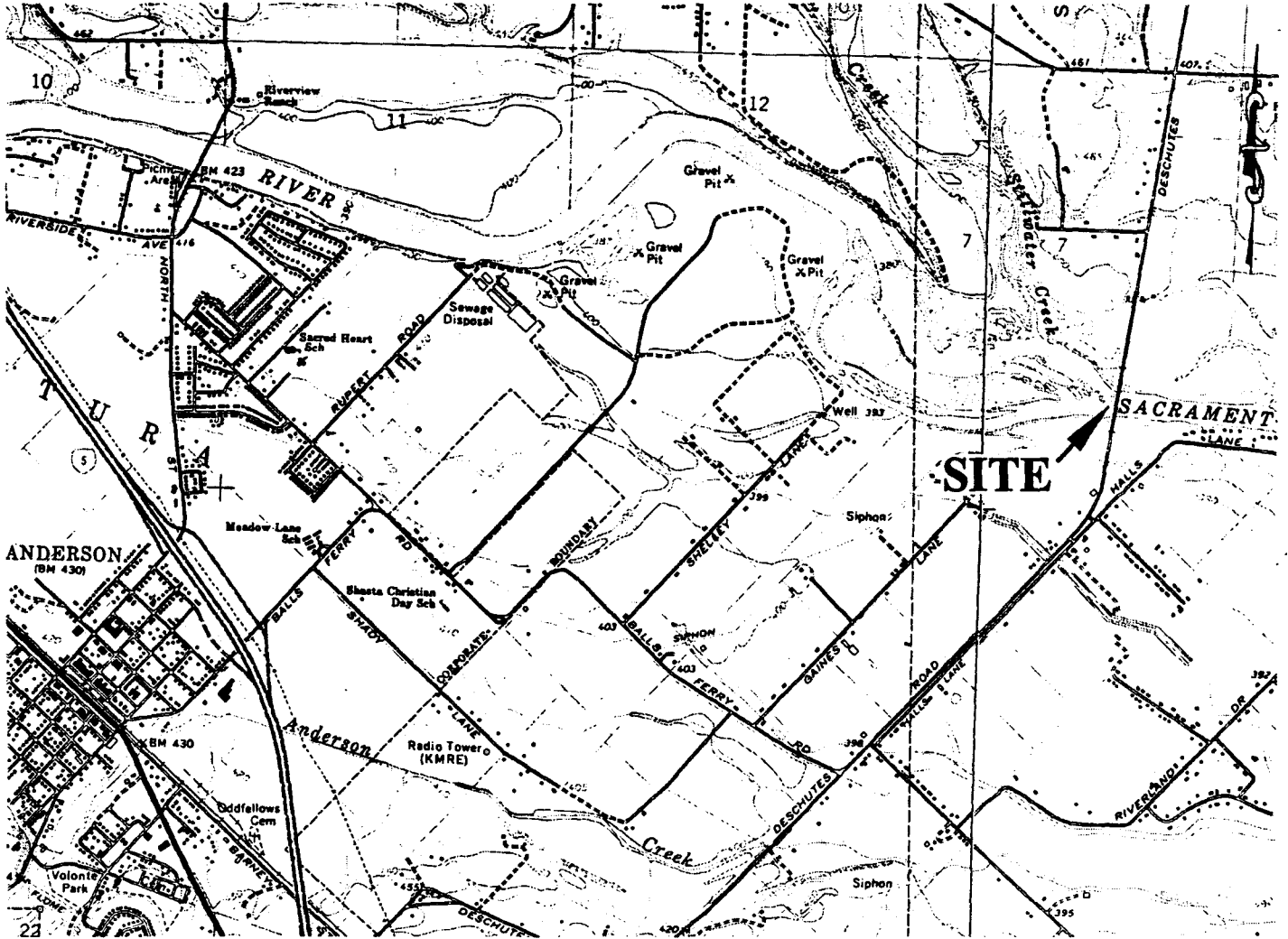

ANDERSON VICINITY

NO SCALE

CALIFORNIA MAP



EXHIBIT C-4

W 25559

WORLDWIDE FIBER NETWORK

Sacramento River
CALENDAR PAGE 0000238

MINUTE PAGE 0007329
SHASTA COUNTY

This Exhibit is solely for purposes of generally defining the lease premises, and is not intended to be, nor shall it be construed as, a waiver of limitation of any state interest in the subject or any other property.

NO SCALE

LOCATION MAP

Fall River

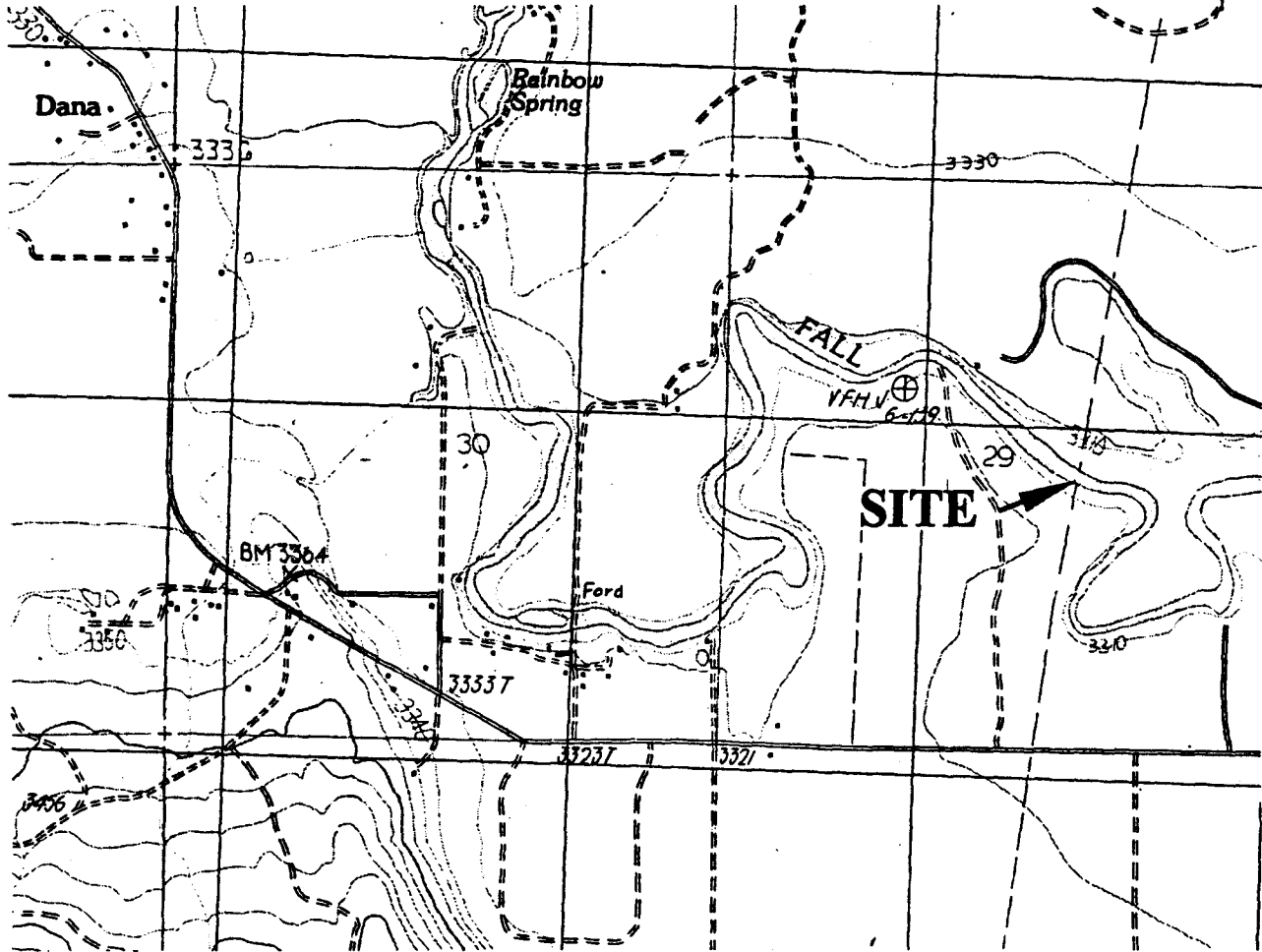

FALL RIVER VALLEY

NO SCALE

CALIFORNIA MAP



EXHIBIT C-5

W 25559

WORLDWIDE FIBER NETWORK

Fall River
CALENDAR PAGE 0000239

MINUTE PAGE 0007930
SHASTA COUNTY

This Exhibit is solely for purposes of generally defining the lease premises, and is not intended to be, nor shall it be construed as, a waiver of limitation of any state interest in the subject or any other property.