

MINUTE ITEM

This Calendar Item No. C16 was approved as
Minute Item No. 116 by the California State Lands
Commission by a vote of 3 to 0 at its
2/8/00 meeting.

**CALENDAR ITEM
C16**

A 2
S 1

02/08/00
PRC 4510.1
J. Ludlow

REVISION OF RENT

LESSEE:

Pacificorp
825 NE Multnomah Street
Portland, OR 97232-2135

AREA, LAND TYPE, AND LOCATION:

0.548 acre parcel, more or less, of tide and submerged lands in the bed of the
Klamath River, near Crescent City, Del Norte County.

AUTHORIZED USE:

Overhead 12.5 kV line across the Klamath River, Section 10 and 15, T13N, R1E,
HBM, Del Norte County.

LEASE TERM:

Ten years, beginning May 20, 1995.

CONSIDERATION:

This lease provides that Lessor may modify the rent periodically during the lease
term. Pursuant to this provision, staff has conducted a review of the rent under
this lease, and recommends that the rent be revised from \$144 per year to \$100
per year, effective May 20, 2000.

EXHIBIT:

A. Site and Location Map

RECOMMENDED ACTION:

IT IS RECOMMENDED THAT THE COMMISSION:

CEQA FINDING:

FIND THAT THE ACTIVITY IS EXEMPT FROM THE REQUIREMENTS
OF THE CEQA PURSUANT TO TITLE 14, CALIFORNIA CODE OF
REGULATIONS, SECTION 15061 BECAUSE THE ACTIVITY IS NOT A

CALENDAR PAGE	0000182
MINUTE PAGE	0007467

CALENDAR ITEM NO. C16 (CONT'D)

PROJECT AS DEFINED BY PUBLIC RESOURCES CODE SECTION
21065 AND TITLE 14, CALIFORNIA CODE OF REGULATIONS,
SECTION 15378.

AUTHORIZATION:

APPROVE THE REVISION OF RENT FOR LEASE NO. PRC 4510.1
FROM \$144 PER YEAR TO \$100 PER YEAR, EFFECTIVE
MAY 20, 2000.

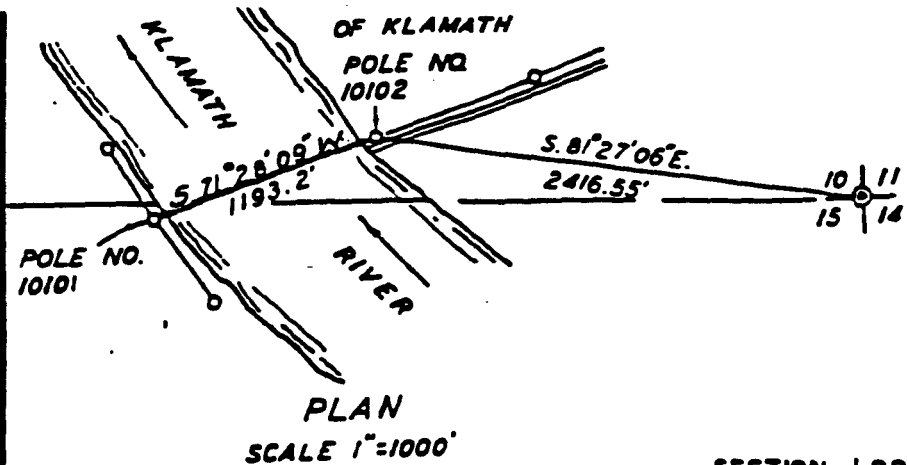

PLAN
SCALE 1"=1000'

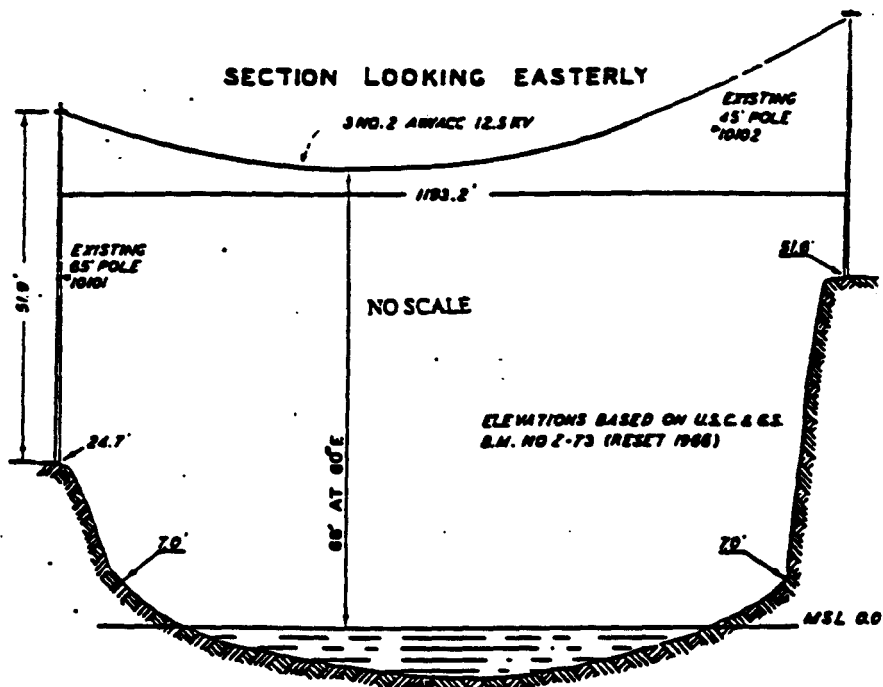

APPLICATION BY
PACIFIC POWER & LIGHT COMPANY
PORTLAND OREGON
FOR EXISTING
OVERHEAD WIRE CROSSING
OVER
KLAMATH RIVER
DEL NORTE COUNTY, CALIF.

LOCATION MAP

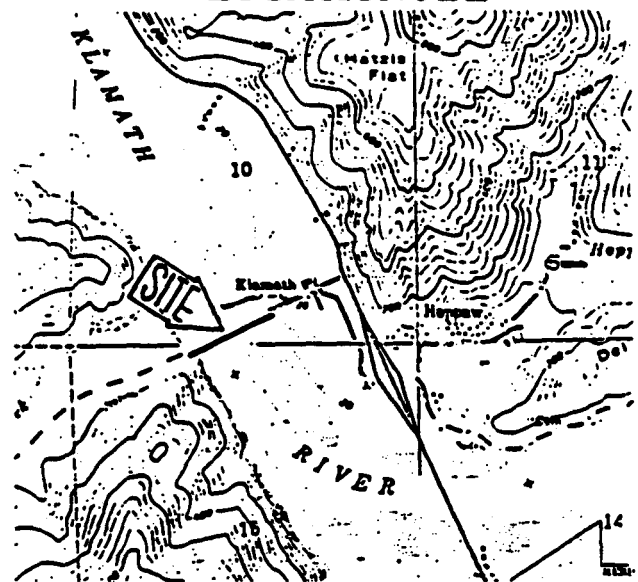

NO SCALE

EXHIBIT "A"
PRC 4510.1
S 10 & 15, T13N, R1E, HM
Powerline R/W
Klamath River
DEL NORTE COUNTY



This Exhibit is solely for purposes of generally defining the lease premises, and is not intended to be, nor shall it be construed as, a waiver or limitation of any State interest in the subject or any other property.