

MINUTE ITEM  
This Calendar Item No. C06  
was approved as Minute Item  
No. 06 by the State Lands  
Commission by a vote of 3  
to 0 at its 4-13-99  
meeting.

CALENDAR ITEM  
**C06**

A 5  
S 6

04/13/99  
PRC 5726 WP 5726.9  
L. Burks

**RECREATIONAL PIER LEASE**

**APPLICANTS:**

Karen Patrick and William W. Jackson,  
as Co-Trustees of the Jana L. Jackson Revocable Trust dated March 4, 1994  
2211 Garden Highway  
Sacramento, California 95833

**AREA, LAND TYPE, AND LOCATION:**

Sovereign lands in the Sacramento River, adjacent to the Garden Highway  
(APN 274-0260-024), near the city of Sacramento, Sacramento County.

**AUTHORIZED USE**

Continued use and maintenance of an existing 6 foot by 60 foot dock (Dock A)  
and 16 foot by 20 foot dock (Dock B).

**LEASE TERM:**

Ten years, beginning March 1, 1998.

**CONSIDERATION:**

No monetary consideration pursuant to Public Resources Code section 6503.5.

**SPECIFIC LEASE PROVISIONS:**

Liability insurance with coverage of no less than \$300,000.

**OTHER PERTINENT INFORMATION:**

1. Pursuant to the Commission's delegation of authority and the State CEQA Guidelines (Title 14, California Code of Regulations, section 15061), the staff has determined that this activity is exempt from the requirements of the CEQA as a categorically exempt project. The project is exempt under Class 1, Existing Facilities; Title 2, California Code of Regulations, section 2905 (a)(2).

Authority: Public Resources Code section 21084 and Title 14, California Code of Regulations, section 15300 and Title 2, California Code of Regulations, section 2905.

CALENDAR ITEM NO. C06 (CONT'D)

2. This activity involves lands identified as possessing significant environmental values pursuant to Public Resources Code sections 6370, et seq. Based upon the staff's consultation with the persons nominating such lands and through the CEQA review process, it is the staff's opinion that the project, as proposed, is consistent with its use classification.

**EXHIBITS:**

- A. Site Plan
- B. Location Map

**PERMIT STREAMLINING ACT DEADLINE:**

N/A

**RECOMMENDED ACTION:**

IT IS RECOMMENDED THAT THE COMMISSION:

**CEQA FINDING:**

FIND THAT THE ACTIVITY IS EXEMPT FROM THE REQUIREMENTS OF THE CEQA PURSUANT TO TITLE 14, CALIFORNIA CODE OF REGULATIONS, SECTION 15061 AS A CATEGORICALLY EXEMPT PROJECT, CLASS 1, EXISTING FACILITIES; TITLE 2, CALIFORNIA CODE OF REGULATIONS, SECTION 2905 (a)(2).

**SIGNIFICANT LANDS INVENTORY FINDING:**

FIND THAT THIS ACTIVITY IS CONSISTENT WITH THE USE CLASSIFICATION DESIGNATED BY THE COMMISSION FOR THE LAND PURSUANT TO PUBLIC RESOURCES CODE SECTIONS 6370, ET SEQ.

CALENDAR ITEM NO. C06 (CONT'D)

**AUTHORIZATION:**

AUTHORIZE ISSUANCE TO KAREN PATRICK AND WILLIAM W. JACKSON AS CO-TRUSTEES OF THE JANA L. JACKSON REVOCABLE TRUST DATED MARCH 4, 1994, OF A TEN-YEAR RECREATIONAL PIER LEASE, BEGINNING MARCH 1, 1998, FOR CONTINUED USE AND MAINTENANCE OF TWO EXISTING DOCKS ON THE LAND SHOWN ON EXHIBIT A ATTACHED AND BY THIS REFERENCE MADE A PART HEREOF; NO MONETARY CONSIDERATION PURSUANT TO PUBLIC RESOURCES CODE SECTION 6503.5; LIABILITY INSURANCE WITH COVERAGE OF NO LESS THAN \$300,000.

Area to be leased lies directly beneath dock and walkway, plus a necessary use area 10 feet in width around the entire dock and walkway. Excepting therefrom any portion lying above the ordinary high water mark.

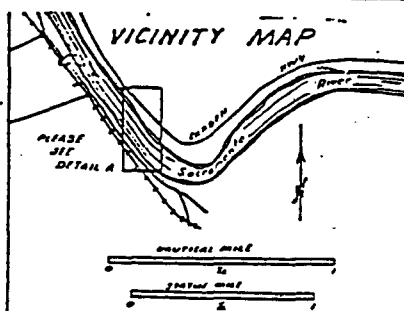

TRACED FROM NAUTICAL CHART 115-5C, PAGE 1 - SACRAMENTO AND SAN JOAQUIN RIVERS, CALIFORNIA. DEPARTMENT OF COMMERCE - ENVIRONMENTAL SCIENCE SERVICE ADMINISTRATION COAST AND GEODETIC SURVEY CORRECTED THRU NM 33, JUNE 8, 1968.

**DOCK A**

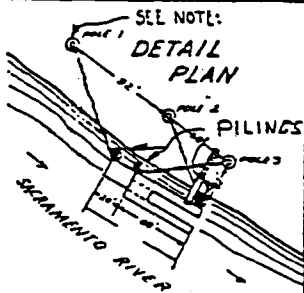
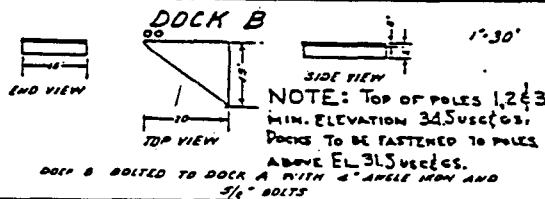
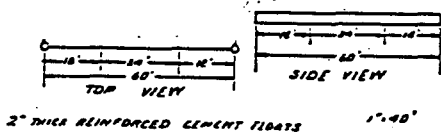

POLES ARE 35' HIGH, 15" IN DIAMETER AT BUTT END AND 6" IN DIAMETER AT TOP. THEY ARE SET 8' IN THE LEADING WITH 6" SQUARE CEMENT BASES - 6" OF THESE BASES IS ABOVE THE GROUND. THE 1" CHAINS ARE TIED FORWARD AND AFT AND AS A SPRING LINE. THEY ARE SECURED 6' ABOVE THE GROUND.

**SIDE ELEVATION**

ALL SOUNDINGS TAKEN AT 11:00 AM. OCTOBER 12, 1969.

(Looking downstream.)  
MAX. EXTENSION INTO WATERWAY 32'

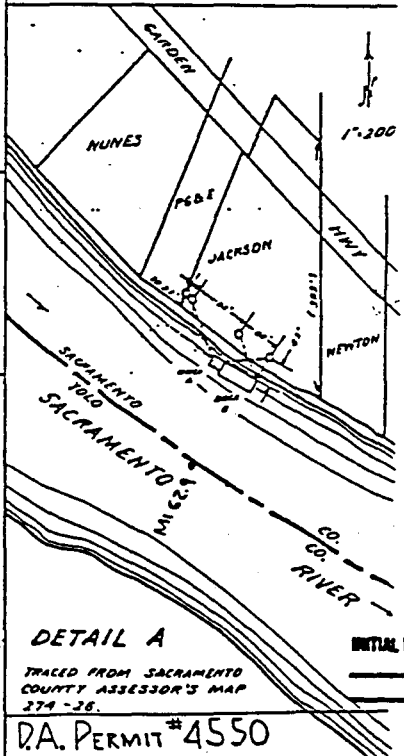
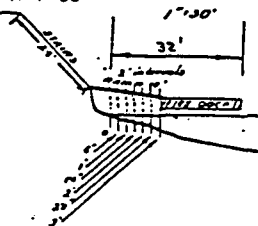

**DETAIL A**

TRACED FROM SACRAMENTO COUNTY ASSESSOR'S MAP 274-26.

D.A. PERMIT #4550

SACRAMENTO RIVER, LEFT BANK AT 62.9 RIVER MILES. APPLICATION BY WILLIAM JACKSON

This exhibit is solely for purposes of generally defining the area to be leased, and is not intended to be, nor shall it be construed as, a waiver or limitation of any State interest in the subject or other property.

**Exhibit A**

WP 5726 000027  
CALENDAR PAGE 26

MINUTE PAGE C05080

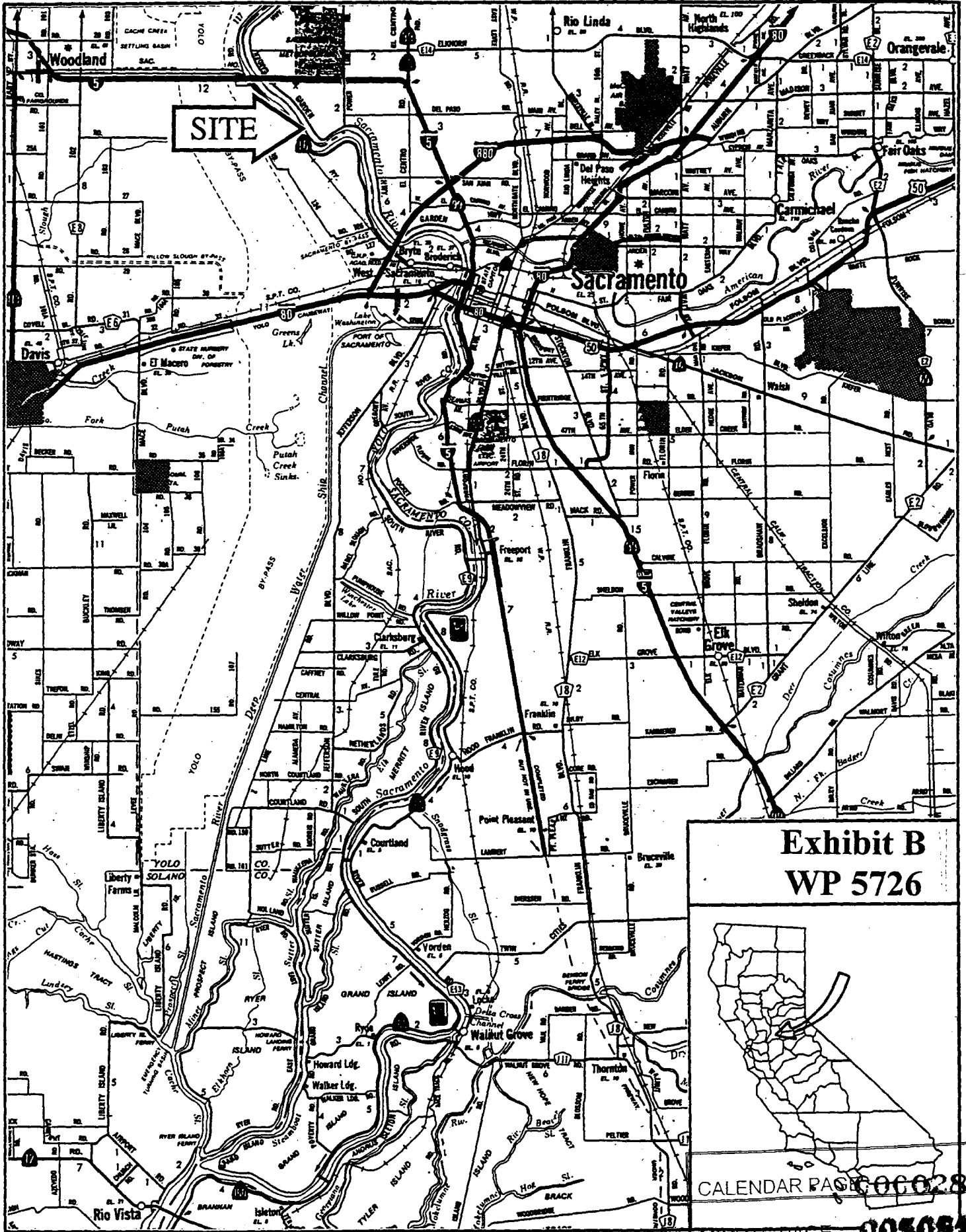

**SITE**

**Exhibit B  
WP 5726**



CALENDAR PAGE 06028

MINUTE PAGE 005081