

CALENDAR ITEM

C24

MINUTE ITEM  
This Calendar Item No. C24  
was approved as Minute Item  
No. 24 by the State Lands  
Commission by a vote of 3  
to 0 at its 5/26/94  
meeting.

A 8  
S 4

05/26/94  
W 23896  
Jones  
PRC 7769

GENERAL LEASE - RECREATIONAL AND  
PROTECTIVE STRUCTURE USE

APPLICANT:

Jack A. Lininger  
17412 Grand Island Road  
Walnut Grove, California 95690

LOCATION:

Tide and submerged land in the Sacramento River at Long  
Island, Sacramento County.

EXHIBITS:

A. Site Map. B. Location Map.

AB 884:

N/A

RECOMMENDED ACTION:

IT IS RECOMMENDED THAT THE COMMISSION:

CEQA

FINDING:

FIND THAT THE BANK PROTECTION IS EXEMPT FROM THE  
REQUIREMENTS OF THE CEQA PURSUANT TO 14 CAL. CODE REGS.  
15304 AS A CATEGORICALLY EXEMPT PROJECT, CLASS 4, MINOR  
ALTERATION TO LAND; AND FIND THAT THE FLOATING BOAT DOCK,  
DOLPHINS AND RAMP ARE EXEMPT FROM THE REQUIREMENTS OF THE  
CEQA PURSUANT TO 14 CAL. CODE REGS. 2905 (C)(1), CLASS 3,  
NEW CONSTRUCTION OF SMALL STRUCTURES.

SIGNIFICANT LANDS

INVENTORY FINDING:

FIND THAT THIS ACTIVITY IS CONSISTENT WITH THE USE  
CLASSIFICATION DESIGNATED FOR THE LAND PURSUANT TO  
P.R.C. 6370, ET SEQ.

CALENDAR PAGE	118
MINUTE PAGE	1972

**AUTHORIZATION:**

AUTHORIZE ISSUANCE TO JACK A. LININGER OF A TEN-YEAR GENERAL LEASE - RECREATIONAL AND PROTECTIVE STRUCTURE USE, BEGINNING MARCH 1, 1994, IN CONSIDERATION OF THE PUBLIC USE AND BENEFIT FOR THE BANK PROTECTION, WITH THE STATE RESERVING THE RIGHT AT ANY TIME TO SET A MONETARY RENTAL IF THE COMMISSION FINDS SUCH ACTION TO BE IN THE STATE'S BEST INTEREST; AND WITH THE FLOATING BOAT DOCK, RAMP AND DOLPHINS QUALIFYING FOR RENT FREE STATUS PURSUANT TO SECTION 6503.5 OF THE P.R.C.; PROVISION OF PUBLIC LIABILITY INSURANCE FOR COMBINED SINGLE LIMIT COVERAGE \$500,000; FOR A 8 FT. X 24 FT. FLOATING BOAT DOCK WITH THREE (3) 4-INCH STEEL-PILE DOLPHINS, A 2 FT. X 21 FT. STEEL TRUSS RAMP, AND MAINTENANCE OF BANK PROTECTION; ON THE LAND DESCRIBED ON EXHIBIT "A" ATTACHED AND BY REFERENCE MADE A PART HEREOF.

This Land description is solely for purposes of generally defining the lease premises, and is not intended to be, nor shall it be construed as, a waiver or limitation of any State interest in the subject or any other property.

## SACRAMENTO RIVER

RT. BANK - MI. 16.64

FLOOD

EBB

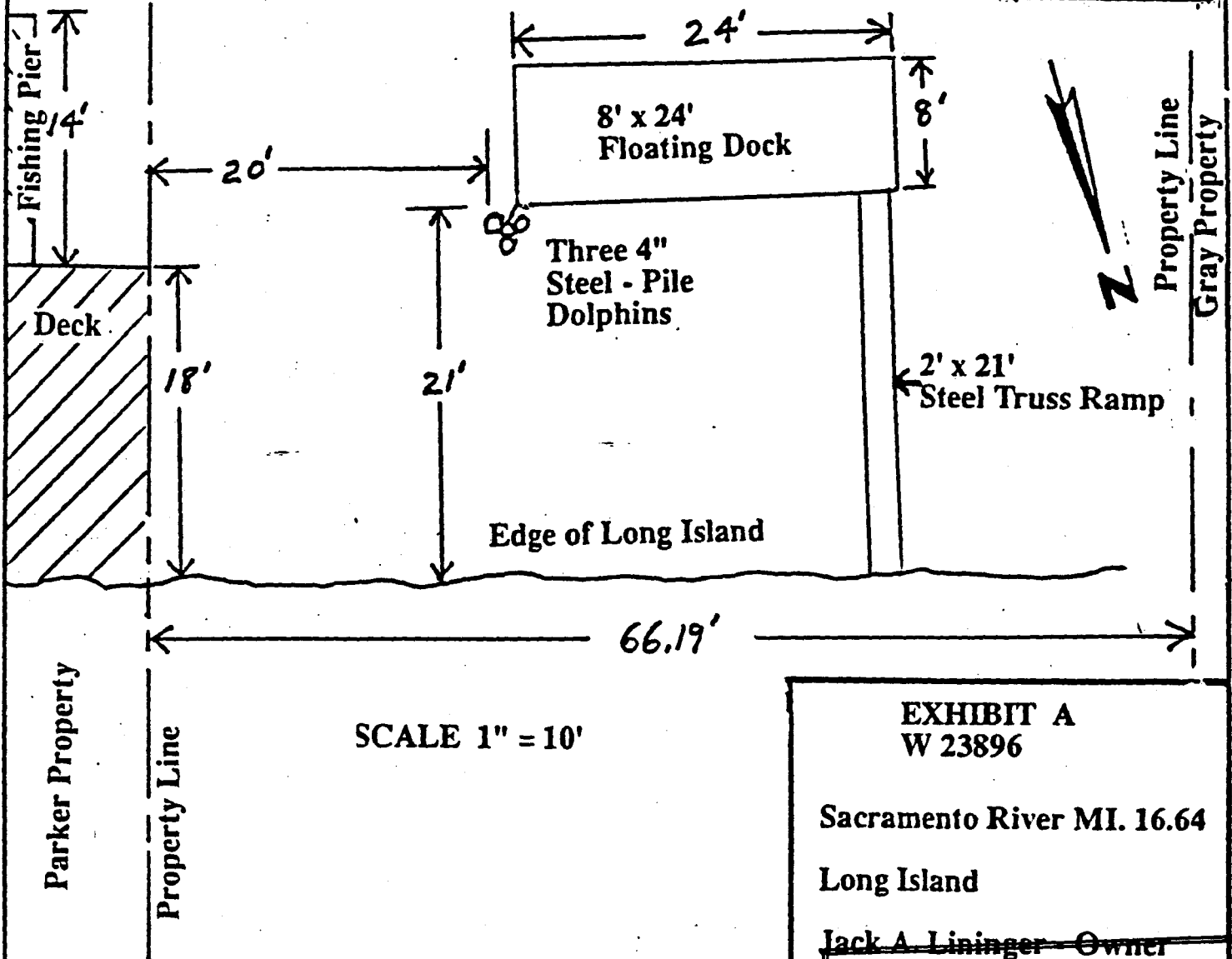
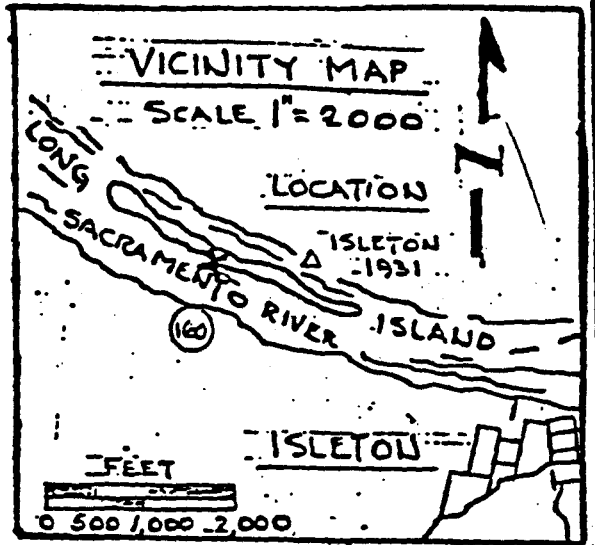

EXHIBIT A  
W 23896

Sacramento River MI. 16.64

Long Island

Jack A. Lininger - Owner

CALENDAR PAGE 120

Sacramento County

MINUTE PAGE 1974

A.P.N. 142-150-03

