

CALENDAR ITEM

C21

MINUTE ITEM
This Calendar Item No. C21
was approved as Minute Item
No. 21 by the State Lands
Commission by a vote of 3
to 0 at its 5/26/94
meeting.

A 5

05/26/94

S 6

WP 6101

Jones

PRC 6101

GENERAL LEASE - RECREATIONAL USE

APPLICANT:

Gary N. Knight and
Dorothy L. Knight
1420 Jonas Avenue
Sacramento, California 95864

LOCATION:

Tide and submerged land in the Sacramento River, Sutter
County.

EXHIBITS:

A. Site Map. B. Location Map.

AB 884:

N/A

RECOMMENDED

ACTION:

IT IS RECOMMENDED THAT THE COMMISSION:

CEQA

FINDING:

FIND THAT THE ACTIVITY IS EXEMPT FROM THE REQUIREMENTS OF THE
CEQA PURSUANT TO 14 CAL. CODE REGS. 15061 AS A CATEGORICALLY
EXEMPT PROJECT, CLASS 1, EXISTING FACILITIES, 2 CAL. CODE
REGS. 2905(A)(2).

SIGNIFICANT LANDS

INVENTORY FINDING:

FIND THAT THIS ACTIVITY IS CONSISTENT WITH THE USE
CLASSIFICATION DESIGNATED FOR THE LAND PURSUANT TO P.R.C.
6370, ET SEQ.

AUTHORIZATION:

AUTHORIZE ISSUANCE TO GARY N. AND DOROTHY L. KNIGHT OF A
FIFTEEN (15) YEAR GENERAL LEASE - RECREATIONAL USE BEGINNING
OCTOBER 1, 1991; IN CONSIDERATION OF \$89.50, WITH THE STATE
RESERVING THE RIGHT TO FIX A DIFFERENT RENTAL ON EACH FIFTH
ANNIVERSARY OF THE LEASE; PROVISION OF PUBLIC LIABILITY
INSURANCE FOR COMBINED SINGLE LIMIT COVERAGE OF \$500,000; FOR
AN 8 FT. X 18 FT. FLOATING DOCK AND A 4 FT. X 36 FT. WALKWAY,
WITH A CABLE ANCHORING DEVICE; ON THE LAND DESCRIBED ON
EXHIBIT "A" ATTACHED AND BY REFERENCE MADE A PART HEREOF.

CALENDAR PAGE 108

MINUTE PAGE

1962

Area to be leased lies directly beneath dock and walkway, plus a necessary use area 10 feet in width around the entire dock and walkway. Excepting therefrom any portion lying above the ordinary high water mark.

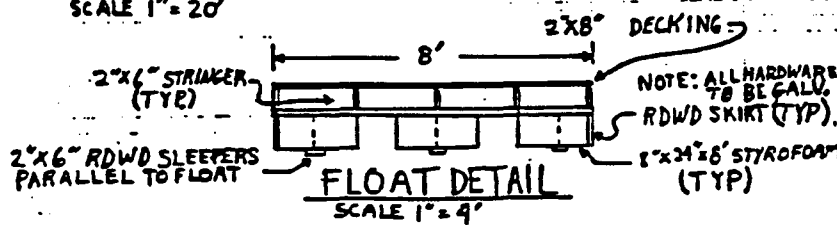
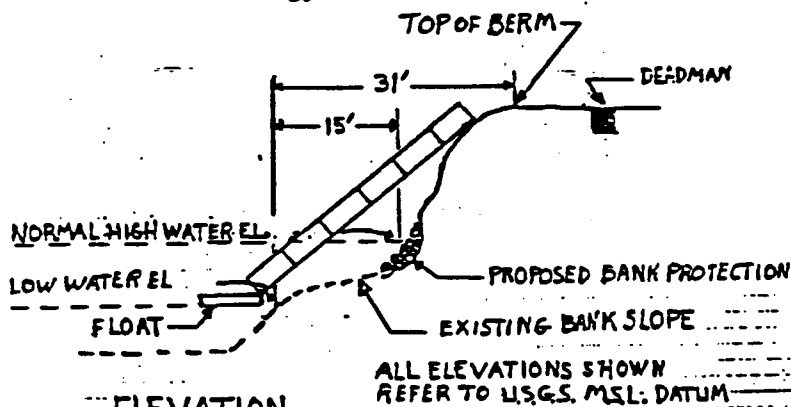
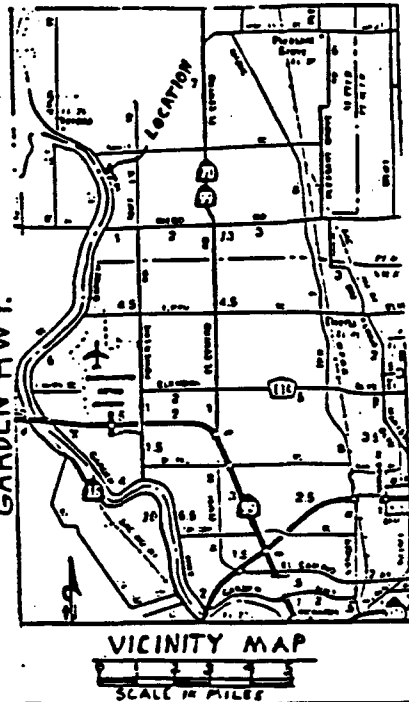
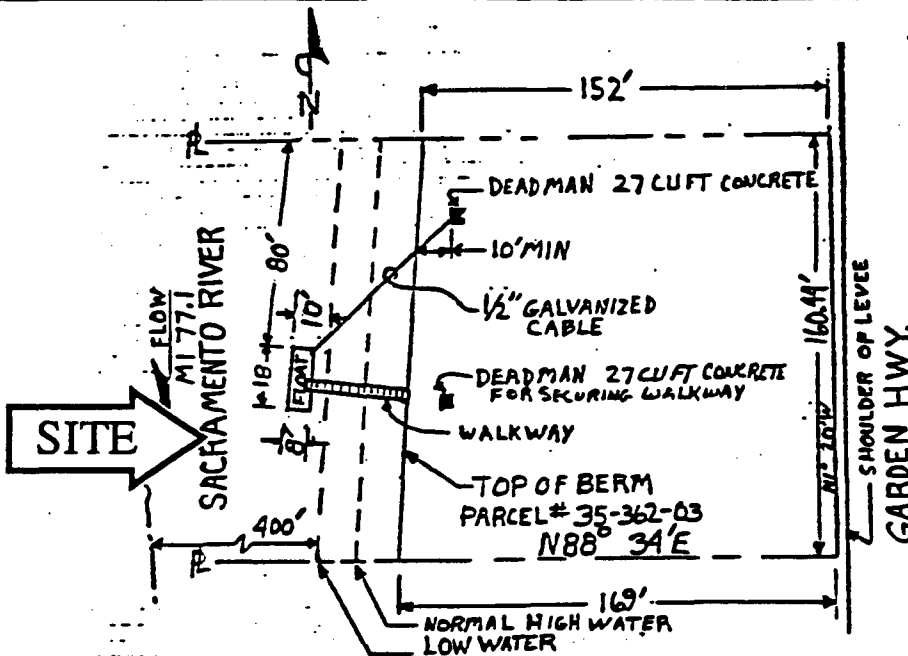

PROPOSED FLOAT

LOCATION:
ASSESSORS' PARCEL NO
35-362-03
SLITTER CO., CAL
APPLICATION BY:
GARY KNIGHT
1420 JONAS AVE
SAC, CAL 95825
DATE: 4 AUG 1981
SHEET: 2 OF 2.

This exhibit is solely for purposes of generally defining the lease premises, and is not intended to be, nor shall it be construed as, a waiver or limitation of State interest in the subject or any other property.

