

MINUTE ITEM
This Calendar Item No. 32
was submitted for information
only, no action thereon
being necessary.

INFORMATIONAL
CALENDAR ITEM

C32

A 57, 58

04/28/93

W 16008

W 10425

S 29

Gaal

**MONITORING FOR POSSIBLE SUBSIDENCE AND SEISMIC HAZARDS,
LONG BEACH UNIT, WILMINGTON OIL FIELD,
LOS ANGELES COUNTY**

The City of Long Beach conducts surveys twice each year, in May and November, for the purpose of monitoring changes in ground elevation of the Long Beach tidelands and adjacent areas. The Commission's staff reviews and interprets the benchmark elevation data from these semi-annual surveys.

Ground elevation survey data for the 27 1/2 year period, May 1965 to November 1992, substantiate that no subsidence of the land surface has occurred as a result of operations in the Long Beach Unit. The results of the next regular elevation survey, to be conducted in May 1993, will be reported to the Commission after the data have been received and analyzed by the Commission staff.

Additionally, a network of seven seismic monitoring stations are being operated for the Long Beach Unit under contract with the Geophysical Laboratory of the University of Southern California at a budgeted cost of \$145,000 for the current fiscal year. No seismic event originated within the Long Beach Unit during the review period May 1992 to November 1992. The Commission's staff will continue to advise the Commission of any change in seismic activity in the vicinity of the Long Beach Unit.

AB 884:
N/A.

EXHIBIT:
A. Location Map

CALENDAR PAGE	303
MINUTE PAGE	645

MAP OF THE WILMINGTON OIL FIELD AND LONG BEACH AREA,
LOS ANGELES COUNTY, CALIFORNIA

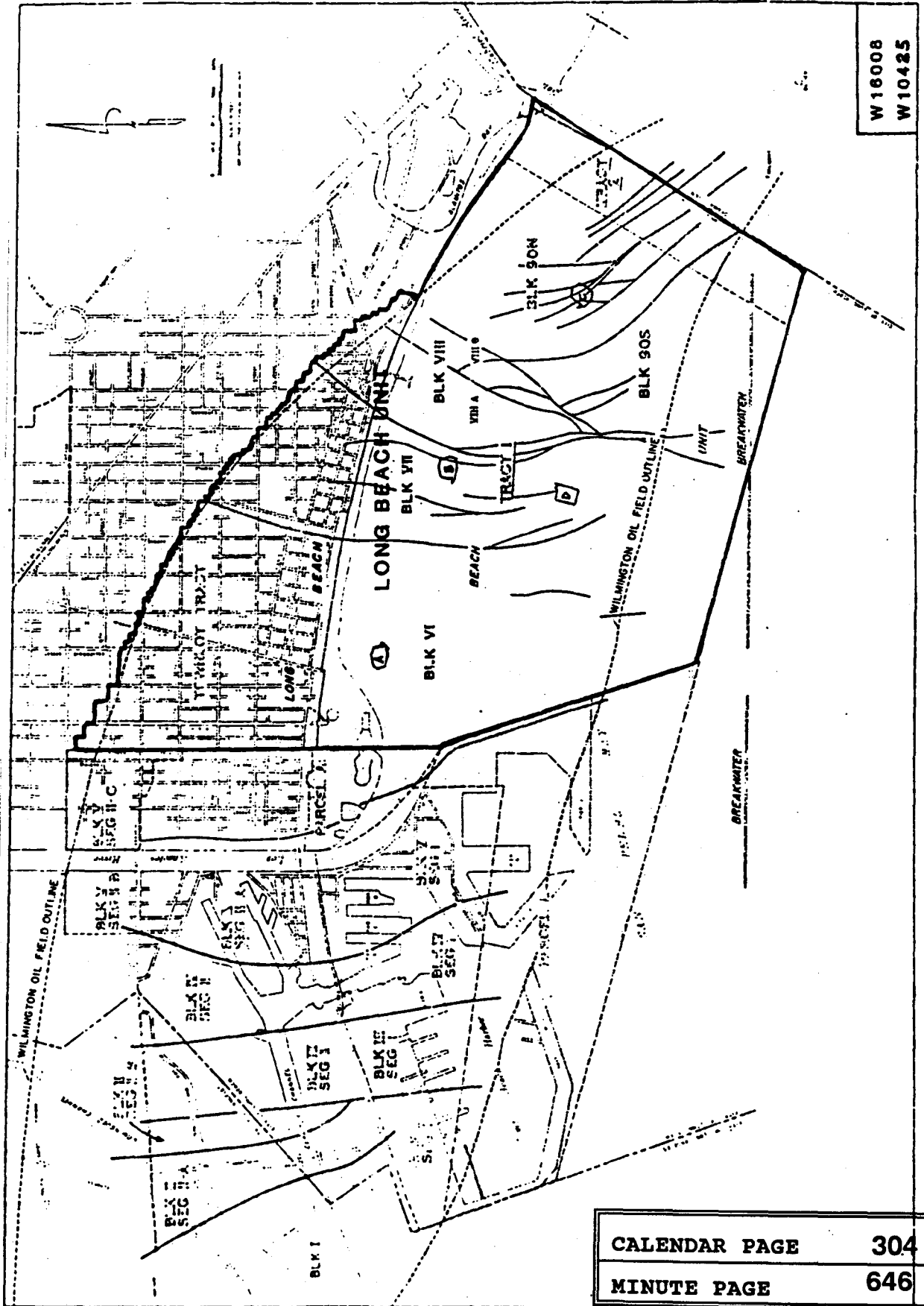

W 16008
W 10425

CALENDAR PAGE	304
MINUTE PAGE	646