

**MINUTE ITEM**

This Calendar Item No. C03  
was approved as Minute Item  
No. C03 by the State Lands  
Commission by a vote of 2  
to 0 at its 3/16/91  
meeting.

**CALENDAR ITEM**

**C 0 3**

A 7

S 1

03/06/91  
WP 3887 PRC 3887  
Gordon

**GENERAL PERMIT - RECREATIONAL USE**

**APPLICANT:**

Lake Tahoe Park Association, Trustee  
c/o Richard Wilson  
P. O. Box 5771  
Tahoe City, California 95730

**AREA, TYPE LAND AND LOCATION:**

A 0.057-acre parcel, a 0.048-acre parcel, a 0.225-acre  
parcel, and forty-five 0.029-acre circular parcels, each  
40 feet in diameter, composing 1.298 acres, together  
totalling 1.628 acres of submerged land located in Lake  
Tahoe near Sunnyside, Placer County.

**LAND USE:**

Maintenance of two existing piers, a swim line and swim  
area, and forty-five existing mooring buoys, respectively,  
utilized for noncommercial, multiple-use, recreational  
boating and swimming.

**TERMS OF PROPOSED PERMIT:**

**Initial period:**

Five (5) years beginning September 29, 1988.

**Public liability insurance:**

Combined single limit coverage of \$1,000,000.

**Special:**

1. The permit is conditioned on permittee's  
conformance with the Tahoe Regional Planning Agency's  
Shorezone Ordinance.

CALENDAR ITEM NO. C 0 3 (CONT'D)

2. The permit restricts any residential use of the facilities.
3. The permit requires refuse containers for the disposal of vessel-generated trash.
4. The permit conforms to the Lyon/Fogerty decision.
5. The permit is conditioned on the seasonal use of the swim line and swim area for a four-month period beginning June 1st and ending September 30th of each year.
6. The permit is conditioned on permittee's retention of the public trust area and the Rorippa habitat area in its natural condition.

**CONSIDERATION:**

\$607.06 from September 29, 1988 through September 28, 1989 and \$684.74 per annum, thereafter; plus P.R.C. 6503.5; with the State reserving the right to fix a different rental on each fifth anniversary of the permit.

**OTHER CONSIDERATION:**

\$273.52 for the term July 1, 1987 through September 28, 1988, as to the swim line and swim area.

**BASIS FOR CONSIDERATION:**

Pursuant to 2 Cal. Code Regs. 2003.

**APPLICANT STATUS:**

Applicant is owner of upland.

**PREREQUISITE CONDITIONS, FEES AND EXPENSES:**

Filing fee has been received.

**STATUTORY AND OTHER REFERENCES:**

A. P.R.C.: Div. 6, Parts 1 and 2; Div. 13.

B. Cal. Code Regs.: Title 3, Div. 3; Title 14, Div. 6.

AB 884:

07/28/91

CALENDAR ITEM NO. C 0 3 (CONT'D)

**OTHER PERTINENT INFORMATION:**

1. Applicant is a homeowners association. The subject facilities are utilized by its homeowner members, tenants, and guests. Because the membership currently includes 9.739 percent of non-natural persons as members, Applicant does not fully meet the criteria of P.R.C. 6503.5 for rent-free status. Therefore, the rental, which is for boat-mooring purposes, is the result of a proration according to this percentage. This is an application to replace Applicant's permit for the pier, which expired September 28, 1988, and to bring the buoys, swim line, and swim area under permit to the Commission.
2. Pursuant to the Commission's delegation of authority and the State CEQA Guidelines (14 Cal. Code Regs. 15025), the staff has prepared a Proposed Negative Declaration identified as EIR ND 472, State Clearinghouse No. 89050834. Such Proposed Negative Declaration was prepared and circulated for public review pursuant to the provisions of CEQA.

Based upon the Initial Study, the Proposed Negative Declaration, and the comments received in response thereto, there is no substantial evidence that the project will have a significant effect on the environment. (14 Cal. Code Regs. 15074(b))

3. In order to determine the potential trust uses in the area of the activity, the staff contacted representatives of the following agencies: Tahoe Regional Planning Agency, California Department of Fish and Game, Placer County, and the Tahoe Conservancy. None of these agencies expressed a concern that the activity would have a significant effect on trust uses in the area. The agencies did not identify any trust needs which were not being met by existing facilities in the area. Identified trust uses in this area would include swimming, boating, walking along the beach, and views of the lake.

CALENDAR ITEM NO. C 0 3 (CONT'D)

4. Staff physically inspected the site for purposes of evaluating the impact of the activity on the Public Trust.
5. This activity involves lands identified as possessing significant environmental values pursuant to P.R.C. 6370, et seq. Based upon the staff's consultation with the persons nominating such lands and through the CEQA review process, it is the staff's opinion that the project, as proposed, is consistent with its use classification.

APPROVALS OBTAINED: (As to the Piers, Swim Line, and Swim Area)  
Tahoe Regional Planning Agency, United States Army Corps of Engineers, California Department of Fish and Game, Lahontan Regional Water Quality Control Board, and County of Placer.

FURTHER APPROVALS REQUIRED: (As to the Piers, Swim Line, and Swim Area)

None.

APPROVALS OBTAINED: (As to the Mooring Buoys)

None.

FURTHER APPROVALS REQUIRED: (As to the Mooring Buoys)  
Tahoe Regional Planning Agency, United States Army Corps of Engineers, California Department of Fish and Game, Lahontan Regional Water Quality Control Board, and County of Placer.

EXHIBITS:

- A. Land Description
- B. Location Map
- C. Local Government Comment
- D. Proposed Negative Declaration

IT IS RECOMMENDED THAT THE COMMISSION:

1. CERTIFY THAT A NEGATIVE DECLARATION, EIR ND 472, STATE CLEARINGHOUSE NO. 89050834, WAS PREPARED FOR THIS PROJECT PURSUANT TO THE PROVISIONS OF THE CEQA AND THAT THE COMMISSION HAS REVIEWED AND CONSIDERED THE INFORMATION CONTAINED THEREIN.
2. ADOPT SAID NEGATIVE DECLARATION AND DETERMINE THAT THE PROJECT, AS APPROVED, WILL NOT HAVE A SIGNIFICANT ON THE ENVIRONMENT.

CALENDAR ITEM NO. C 0 3 (CONT'D)

3. AUTHORIZE ISSUANCE TO LAKE TAHOE PARK ASSOCIATION, TRUSTEE, OF A FIVE-YEAR GENERAL PERMIT - RECREATIONAL USE BEGINNING SEPTEMBER 29, 1988; IN CONSIDERATION OF ANNUAL RENT IN THE AMOUNT OF \$607.06 FROM SEPTEMBER 29, 1988 THROUGH SEPTEMBER 28, 1989, AND \$684.74 THEREAFTER, PLUS P.R.C. 6503.5; AND OTHER CONSIDERATION IN THE AMOUNT OF \$273.52 FOR THE TERM JULY 1, 1987 THROUGH SEPTEMBER 28, 1988, AS TO THE SWIM LINE AND SWIM AREA; WITH THE STATE RESERVING THE RIGHT TO FIX A DIFFERENT RENTAL ON EACH FIFTH ANNIVERSARY OF THE PERMIT; AND WITH PROVISION OF PUBLIC LIABILITY INSURANCE FOR COMBINED SINGLE LIMIT COVERAGE OF \$1,000,000; FOR MAINTENANCE OF TWO EXISTING PIERS, A SWIM LINE AND SWIM AREA, AND FORTY-FIVE EXISTING MOORING BUOYS UTILIZED FOR NONCOMMERCIAL, MULTIPLE-USE, RECREATIONAL BOATING ON THE LAND DESCRIBED ON EXHIBIT "A" ATTACHED AND BY REFERENCE MADE A PART HEREOF.

**EXHIBIT "A"**

**WP 3887**

**LAND DESCRIPTION**

Forty-eight Parcels of State owned submerged land in Lake Tahoe, Placer County, California, said parcels are described as follows:

**PARCELS 1 & 2 - PIERS**

Two parcels of land lying beneath two existing piers, TOGETHER WITH those necessary use areas extending not more than 10 feet from the extremities of said piers; said piers are adjacent to the land described in the Deed recorded March 7, 1952 in Volume 604, page 336, Official Records of Placer County.

EXCEPTING THEREFROM any portion lying landward of the ordinary low water mark of Lake Tahoe.

**PARCEL 3 - SWIM AREA and SWIM LINE**

All that land bounded on the north and south by said Parcels 1 and 2; on the east by a line lying 50 feet westerly of the westerly buoys described as Parcels 4 through 47 of this description; and on west by the ordinary low water mark of Lake Tahoe.

**PARCELS 4 through 48 - BUOYS**

Forty-five circular parcels of land, each having a diameter of 40 feet lying adjacent to the land described in said Deed recorded in Volume 604, page 336, Official Records of Placer County.

**END OF DESCRIPTION**

**REVISED JULY 26, 1990 BY LLB.**

|               |     |
|---------------|-----|
| CALENDAR PAGE | 18  |
| MINUTE PAGE   | 351 |

LOCATION MAP

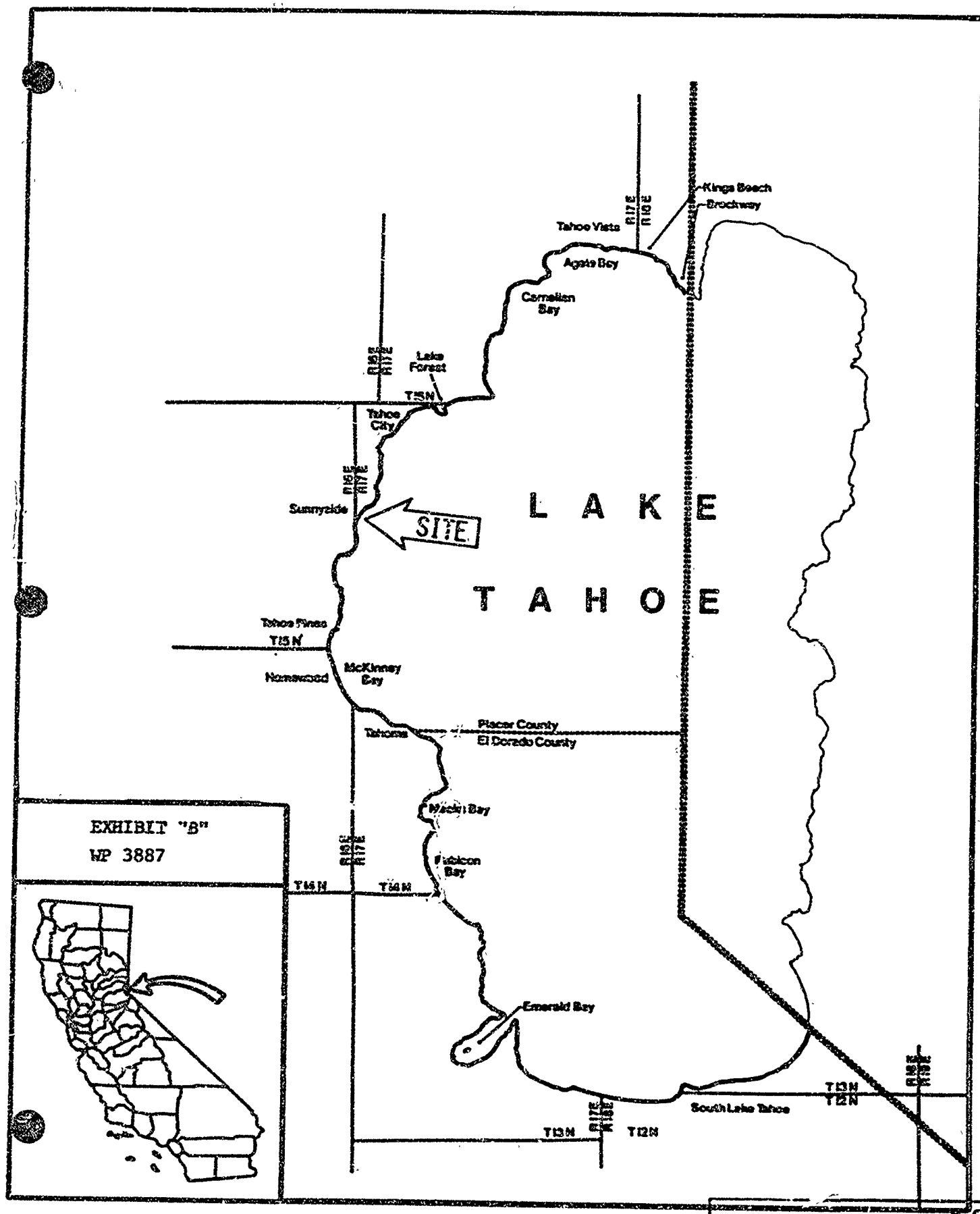

LOCAL GOVERNMENT COMMENT



PLACER COUNTY

DEPARTMENT OF PUBLIC WORKS

JACK WARREN, Director  
JAN WITTER, Assistant Director  
LARRY ODDO, Deputy Director  
ALAN ROY, Deputy Director

PLACER COUNTY DIVISION

March 3, 1989

Gerald D. Gordon  
California State Lands Commission  
1807 - 13th Street  
Sacramento, CA 95814

RE: PIER - SHOREZONE CONSTRUCTION

Dear Mr. Gordon:

The County of Placer has reviewed the below referenced requests for construction activities within the shorezone of Lake Tahoe. We have no objections to the construction activities described in the below applications contingent upon approval by your office.

- |   |         |
|---|---------|
| 1. McKinney Landing Home Owners Association | WP 4195 |
| 2. Strain Ranch                             | WP 4091 |
| 3. Lake Tahoe Park Association              | WP 3887 |
| 4. Cedar Point Home Owners Association      | WP 2859 |
| 5. Antiques and Heirlooms                   | W 23246 |
| 6. Michael Babcock                          | W 24201 |
| 7. Tahoe Tavern Property Owners Association | WP 5956 |
| 8. Lyon/Hawkins                             | WP 5884 |

Should you have any questions or if I can be of further assistance, please call at your convenience.

COUNTY OF PLACER  
DEPARTMENT OF PUBLIC WORKS  
JACK WARREN, DIRECTOR

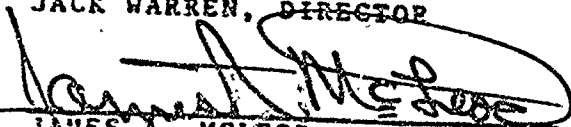
  
JAMES A. MCLEOD  
ASSISTANT CIVIL ENGINEER

JAH:ms



STATE LANDS COMMISSION  
1807 13TH STREET  
SACRAMENTO, CALIFORNIA 95814



## EXHIBIT D

PROPOSED NEGATIVE DECLARATION

EIR NO 472

File Ref.: WP 3887

SCH#: 89050834

Project Title: Lake Tahoe Park Assn. Piers/Buoys  
Project Proponent: Lake Tahoe Park Association  
Project Location: At Lake Tahoe, adjacent to Tahoe Park subdivision, south of Tahoe City, Placer County  
Project Description: Renewal of 2 existing, previously authorized piers, and permit 45 existing buoys, previously unauthorized.

Contact Person: Dan Cohen Telephone: (916) 324-8497

This document is prepared pursuant to the requirements of the California Environmental Quality Act (Section 21000 et seq., Public Resources Code), the State CEQA Guidelines (Section 15000 et seq., Title 14, California Code Regulations), and the State Lands Commission regulations (Section 2901 et seq., Title 2, California Code Regulations).

Based upon the attached Initial Study, it has been found that:

the project will not have a significant effect on the environment.

mitigation measures included in the project will avoid potentially significant effects.

|               |      |
|---------------|------|
| CALENDAR PAGE | 21   |
| MINUTE PAGE   | 3, 4 |

Form 13.17 (2/89)

ENVIRONMENTAL IMPACT ASSESSMENT CHECKLIST - PART II

Form 13-20 (7/82)

File Ref.: WP 3887

I. BACKGROUND INFORMATION

A. Applicant: Lake Tahoe Park Assn., Trustee
c/o Richard Wilson
P.O. Box 5771
Tahoe City, CA 95730

B. Checklist Date: 5 / 10 / 89

C. Contact Person: Dan Cohen
Telephone: ( 916 ) 324-8497

D. Purpose: Maintain existing recreational operation

E. Location: Lake Tahoe, adjacent to Tahoe Park subdivision, south of
Tahoe City, Placer County

F. Description: Existing previously authorized piers (two); existing unauthorized
boat mooring buoys (forty-five). Buoys are at 50-foot intervals
in a 350+ foot by 650+ foot buoy field.

G. Persons Contacted:
[Empty lines for contact information]

II. ENVIRONMENTAL IMPACTS. (Explain all "yes" and "maybe" answers)

Table with 3 columns: Question, Yes, Maybe, No. Contains 7 items related to environmental impacts like earth conditions, soil, topography, erosion, and geologic hazards.

CALENDAR PAGE 22
MINUTE PAGE 355

Yes Maybe No

B. Air. Will the proposal result in:

- 1. Substantial air emissions or deterioration of ambient air quality?
- 2. The creation of objectionable odors?
- 3. Alteration of air movement, moisture or temperature, or any change in climate, either locally or regionally?

C. Water. Will the proposal result in:

- 1. Changes in the currents, or the course or direction of water movements, in either marine or fresh waters?
- 2. Changes in absorption rates, drainage patterns, or the rate and amount of surface water runoff?
- 3. Alterations to the course or flow of flood waters?
- 4. Change in the amount of surface water in any water body?
- 5. Discharge into surface waters, or in any alteration of surface water quality, including but not limited to temperature, dissolved oxygen or turbidity?
- 6. Alteration of the direction or rate of flow of ground waters?
- 7. Change in the quantity of ground waters, either through direct additions or withdrawals, or through interception of an aquifer by cuts or excavations?
- 8. Substantial reduction in the amount of water otherwise available for public water supplies?
- 9. Exposure of people or property to water-related hazards such as flooding or tidal waves?
- 10. Significant changes in the temperature, flow or chemical content of surface thermal springs?

D. Plant Life. Will the proposal result in:

- 1. Change in the diversity of species, or number of any species of plants (including trees, shrubs, grass, crops, and aquatic plants)?
- 2. Reduction of the numbers of any unique, rare or endangered species of plants?
- 3. Introduction of new species of plants into an area, or in a barrier to the normal replenishment of existing species?
- 4. Reduction in acreage of any agricultural crop?

E. Animal Life. Will the proposal result in:

- 1. Change in the diversity of species, or numbers of any species of animals (birds, land animals including reptiles, fish and shellfish, benthic organisms, or insects)?
- 2. Reduction of the numbers of any unique, rare or endangered species of animals?
- 3. Introduction of new species of animals into an area, or result in a barrier to the migration or movement of animals?
- 4. Deterioration to existing fish or wildlife habitat?

F. Noise. Will the proposal result in:

- 1. Increase in existing noise levels?
- 2. Exposure of people to severe noise levels?

G. Light and Glare. Will the proposal result in:

- 1. The production of new light or glare?

H. Land Use. Will the proposal result in:

- 1. A substantial alteration of the present or planned land use of an area?

I. Natural Resources. Will the proposal result in:

- 1. Increase in the rate of use of any natural resources?
- 2. Substantial depletion of any nonrenewable resources?

|               |     |
|---------------|-----|
| CALENDAR PAGE | 23  |
| MINUTE PAGE   | 356 |

- J. Risk of Impact.** Does the proposal result in:
1. A risk of an explosion or the release of hazardous substances (including, but not limited to, oil, pesticides, chemicals, or radiation) in the event of an accident or upset conditions? Yes  Maybe  No
2. Possible interference with emergency response plan or an emergency evacuation plan? Yes  Maybe  No
- K. Population.** Will the proposal result in:
1. The alteration, distribution, density, or growth rate of the human population of the area? Yes  Maybe  No
- L. Housing.** Will the proposal result in:
1. Affecting existing housing, or create a demand for additional housing? Yes  Maybe  No
- M. Transportation/Circulation.** Will the proposal result in:
1. Generation of substantial additional vehicular movement? Yes  Maybe  No
2. Affecting existing parking facilities, or create a demand for new parking? Yes  Maybe  No
3. Substantial impact upon existing transportation systems? Yes  Maybe  No
4. Alterations to present patterns of circulation or movement of people and/or goods? Yes  Maybe  No
5. Alterations to waterborne, rail, or air traffic? Yes  Maybe  No
6. Increase in traffic hazards to motor vehicles, bicyclists, or pedestrians? Yes  Maybe  No
- N. Public Services.** Will the proposal have an effect upon, or result in a need for new or altered governmental services in any of the following areas:
1. Fire protection? Yes  Maybe  No
2. Police protection? Yes  Maybe  No
3. Schools? Yes  Maybe  No
4. Parks and other recreational facilities? Yes  Maybe  No
5. Maintenance of public facilities, including roads? Yes  Maybe  No
6. Other governmental services? Yes  Maybe  No
- O. Energy.** Will the proposal result in:
1. Use of substantial amounts of fuel or energy? Yes  Maybe  No
2. Substantial increase in demand upon existing sources of energy, or require the development of new sources? Yes  Maybe  No
- P. Utilities.** Will the proposal result in a need for new systems, or substantial alterations to the following utilities:
1. Power or natural gas? Yes  Maybe  No
2. Communication systems? Yes  Maybe  No
3. Water? Yes  Maybe  No
4. Sewer or septic tanks? Yes  Maybe  No
5. Storm water drainage? Yes  Maybe  No
6. Solid waste and disposal? Yes  Maybe  No
- Q. Human Health.** Will the proposal result in:
1. Creation of any health hazard or potential health hazard (excluding mental health)? Yes  Maybe  No
2. Exposure of people to potential health hazards? Yes  Maybe  No
- R. Aesthetics.** Will the proposal result in:
1. The obstruction of any scenic vista or view open to the public, or will the proposal result in the creation of an aesthetically offensive site open to public view? Yes  Maybe  No
- S. Recreation.** Will the proposal result in:
1. An impact upon the quality or quantity of existing recreational opportunities? Yes  Maybe  No

CALENDAR PAGE  24

MINUTE PAGE  33

T. Cultural Resources.

- |  | Yes                      | Maybe                    | No                                  |
|--|--------------------------|--------------------------|-------------------------------------|
| 1. Will the proposal result in the alteration of or the destruction of a prehistoric or historic archeological site? . . . . .             | <input type="checkbox"/> | <input type="checkbox"/> | <input checked="" type="checkbox"/> |
| 2. Will the proposal result in adverse physical or aesthetic effects to a prehistoric or historic building, structure or object? . . . . . | <input type="checkbox"/> | <input type="checkbox"/> | <input checked="" type="checkbox"/> |
| 3. Does the proposal have the potential to cause a physical change which would affect unique ethnic cultural values? . . . . .             | <input type="checkbox"/> | <input type="checkbox"/> | <input checked="" type="checkbox"/> |
| 4. Will the proposal restrict existing religious or sacred uses within the potential impact area? . . . . .                                | <input type="checkbox"/> | <input type="checkbox"/> | <input checked="" type="checkbox"/> |

U. Mandatory Findings of Significance.

- |  |                          |                          |                                     |
|--|--------------------------|--------------------------|-------------------------------------|
| 1. Does the project have the potential to degrade the quality of the environment, reduce the habitat of a fish or wildlife species, cause a fish or wildlife population to drop below self-sustaining levels, threaten to eliminate a plant or animal community, reduce the number or restrict the range of a rare or endangered plant or animal or eliminate important examples of the major periods of California history or prehistory? . . . . . | <input type="checkbox"/> | <input type="checkbox"/> | <input checked="" type="checkbox"/> |
| 2. Does the project have the potential to achieve short-term, to the disadvantage of long-term, environmental goals? . . . . .   | <input type="checkbox"/> | <input type="checkbox"/> | <input checked="" type="checkbox"/> |
| 3. Does the project have impacts which are individually limited, but cumulatively considerable? . . . . .  | <input type="checkbox"/> | <input type="checkbox"/> | <input checked="" type="checkbox"/> |
| 4. Does the project have environmental effects which will cause substantial adverse effects on human beings, either directly or indirectly? . . . . .  | <input type="checkbox"/> | <input type="checkbox"/> | <input checked="" type="checkbox"/> |

III. DISCUSSION OF ENVIRONMENTAL EVALUATION (See Comments Attached)

IV. PRELIMINARY DETERMINATION

On the basis of this initial evaluation:

- I find the proposed project COULD NOT have a significant effect on the environment, and a NEGATIVE DECLARATION will be prepared.
- I find that although the proposed project could have a significant effect on the environment, there will not be a significant effect in this case because the mitigation measures described on an attached sheet have been added to the project. A NEGATIVE DECLARATION will be prepared.
- I find the proposed project MAY have a significant effect on the environment, and an ENVIRONMENTAL IMPACT REPORT is required.

Date: 05 / 10 / 89

*[Signature]*  
For the State Lands Commission

|               |     |
|---------------|-----|
| CALENDAR PAGE | 25  |
| MINUTE PAGE#  | 308 |

**STATE LANDS COMMISSION**

LEO T. McCARTHY, *Lieutenant Governor*  
GRAY DAVIS, *Controller*  
JESSE R. HUFF, *Director of Finance*

EXECUTIVE OFFICE  
1807 - 13th Street  
Sacramento, CA 95811  
CHARLES WARREN  
Executive Officer

EXHIBIT D

PROPOSED NEGATIVE DECLARATION

EIR ND: 472

File Ref: W3887

SCH. NO.: 89050834

Project Title: Lake Tahoe Park Association swimline installation

Project Proponent: Lake Tahoe Park Association

Project Location: W. Shore Lake Tahoe parcel (APN 83-0100-03)

Project Description: Install a safety swim line 110 to 120 feet waterward of shore between two existing piers

Contact Person: Jacques Graber Telephone: (916) 323-7209

This document is prepared pursuant to the requirements of the California Environmental Quality Act (Section 2100 et seq., Public Resources Code), the State CEQA Guidelines (Section 15000 et seq., Title 14, California Code Regulations), and the State Lands Commission regulations (Section 2901 et seq., Title 2, California Code Regulations).

Based upon the Initial Study, it has been found that:

that project will not have a significant effect on the environment.

mitigation measures included in the project will avoid potentially significant effects.

FORM 13.17 (4/90)

|               |     |
|---------------|-----|
| CALENDAR PAGE | 26  |
| MINUTE PAGE   | 359 |

ENVIRONMENTAL IMPACT ASSESSMENT CHECKLIST - PART II

Form 13.20 (7/82)

File Ref.: W3887.1

I. BACKGROUND INFORMATION

A. Applicant: Lake Tahoe Park Association  
P. O. Box 5771  
Tahoe City, CA 95730  
(916) 583-3820

B. Checklist Date: 08/22/90

C. Contact Person: Jacques Graber  
Telephone: (916) 323-7209

D. Purpose: Install a safety swim line of buoys and plastic line between two existing piers.

E. Location: L.T.P.A. property on west shore of Lake Tahoe (APN 83-0100-03) between Truckee River and Ward Creek.

F. Description: Two existing piers extending 110 and 121 feet waterward of shore. The swim line will be stretched in the 200 foot space between the piers and lying 50 feet from the foot of the north pier, 90 feet of the south pier foot.

G. Persons Contacted: \_\_\_\_\_  
\_\_\_\_\_  
\_\_\_\_\_  
\_\_\_\_\_  
\_\_\_\_\_  
\_\_\_\_\_  
\_\_\_\_\_  
\_\_\_\_\_

II. ENVIRONMENTAL IMPACTS. (Explain all "yes" and "maybe" answers)

| A. Earth. Will the proposal result in:   | Yes                      | Maybe                    | No                                  |
|--|--------------------------|--------------------------|-------------------------------------|
| 1. Unstable earth conditions or changes in geologic substructures? .....   | <input type="checkbox"/> | <input type="checkbox"/> | <input checked="" type="checkbox"/> |
| 2. Disruptions, displacements, compaction, or overcovering of the soil? .....  | <input type="checkbox"/> | <input type="checkbox"/> | <input checked="" type="checkbox"/> |
| 3. Change in topography or ground surface relief features? .....   | <input type="checkbox"/> | <input type="checkbox"/> | <input checked="" type="checkbox"/> |
| 4. The destruction, covering, or modification of any unique geologic or physical features? .....   | <input type="checkbox"/> | <input type="checkbox"/> | <input checked="" type="checkbox"/> |
| 5. Any increase in wind or water erosion of soils, either on or off the site? .....  | <input type="checkbox"/> | <input type="checkbox"/> | <input checked="" type="checkbox"/> |
| 6. Changes in deposition or erosion of beach sands, or changes in siltation, deposition or erosion which may modify the channel of a river or stream or the bed of the ocean or any bay, inlet, or lake? ..... | <input type="checkbox"/> | <input type="checkbox"/> | <input checked="" type="checkbox"/> |
| 7. Exposure of all people or property to geologic hazards such as earthquakes, landslides, mudslides, ground failure, or similar hazards? .....  | <input type="checkbox"/> | <input type="checkbox"/> | <input checked="" type="checkbox"/> |

CALENDAR PAGE 27  
MINUTE PAGE 300

- |   |   | Yes                      | Maybe                    | No                                  |
|---|---|--------------------------|--------------------------|-------------------------------------|
| <b>B. Air.</b> Will the proposal result in:               |   |                          |                          |                                     |
| 1.  | Substantial air emissions or deterioration of ambient air quality?  | <input type="checkbox"/> | <input type="checkbox"/> | <input checked="" type="checkbox"/> |
| 2.  | The creation of objectionable odors?  | <input type="checkbox"/> | <input type="checkbox"/> | <input checked="" type="checkbox"/> |
| 3.  | Alteration of air movement, moisture or temperature, or any change in climate, either locally or regionally?  | <input type="checkbox"/> | <input type="checkbox"/> | <input checked="" type="checkbox"/> |
| <b>C. Water.</b> Will the proposal result in:             |   |                          |                          |                                     |
| 1.  | Changes in the currents, or the course or direction of water movements, in either marine or fresh waters?   | <input type="checkbox"/> | <input type="checkbox"/> | <input checked="" type="checkbox"/> |
| 2.  | Changes in absorption rates, drainage patterns, or the rate and amount of surface water runoff?   | <input type="checkbox"/> | <input type="checkbox"/> | <input checked="" type="checkbox"/> |
| 3.  | Alterations to the course or flow of flood waters?  | <input type="checkbox"/> | <input type="checkbox"/> | <input checked="" type="checkbox"/> |
| 4.  | Change in the amount of surface water in any water body?  | <input type="checkbox"/> | <input type="checkbox"/> | <input checked="" type="checkbox"/> |
| 5.  | Discharge into surface waters, or in any alteration of surface water quality, including but not limited to temperature, dissolved oxygen or turbidity?                | <input type="checkbox"/> | <input type="checkbox"/> | <input checked="" type="checkbox"/> |
| 6.  | Alteration of the direction or rate of flow of ground waters?   | <input type="checkbox"/> | <input type="checkbox"/> | <input checked="" type="checkbox"/> |
| 7.  | Change in the quantity of ground waters, either through direct additions or withdrawals, or through interception of an aquifer by cuts or excavations?                | <input type="checkbox"/> | <input type="checkbox"/> | <input checked="" type="checkbox"/> |
| 8.  | Substantial reduction in the amount of water otherwise available for public water supplies?   | <input type="checkbox"/> | <input type="checkbox"/> | <input checked="" type="checkbox"/> |
| 9.  | Exposure of people or property to water-related hazards such as flooding or tidal waves?  | <input type="checkbox"/> | <input type="checkbox"/> | <input checked="" type="checkbox"/> |
| 10.   | Significant changes in the temperature, flow or chemical content of surface thermal springs?  | <input type="checkbox"/> | <input type="checkbox"/> | <input checked="" type="checkbox"/> |
| <b>D. Plant Life.</b> Will the proposal result in:        |   |                          |                          |                                     |
| 1.  | Change in the diversity of species, or number of any species of plants (including trees, shrubs, grass, crops, and aquatic plants)?                                   | <input type="checkbox"/> | <input type="checkbox"/> | <input checked="" type="checkbox"/> |
| 2.  | Reduction of the numbers of any unique, rare or endangered species of plants?   | <input type="checkbox"/> | <input type="checkbox"/> | <input checked="" type="checkbox"/> |
| 3.  | Introduction of new species of plants into an area, or in a barrier to the normal replenishment of existing species?  | <input type="checkbox"/> | <input type="checkbox"/> | <input checked="" type="checkbox"/> |
| 4.  | Reduction in acreage of any agricultural crop?  | <input type="checkbox"/> | <input type="checkbox"/> | <input checked="" type="checkbox"/> |
| <b>E. Animal Life.</b> Will the proposal result in:       |   |                          |                          |                                     |
| 1.  | Change in the diversity of species, or numbers of any species of animals (birds, land animals including reptiles, fish and shellfish, benthic organisms, or insects)? | <input type="checkbox"/> | <input type="checkbox"/> | <input checked="" type="checkbox"/> |
| 2.  | Reduction of the numbers of any unique, rare or endangered species of animals?  | <input type="checkbox"/> | <input type="checkbox"/> | <input checked="" type="checkbox"/> |
| 3.  | Introduction of new species of animals into an area, or result in a barrier to the migration or movement of animals?  | <input type="checkbox"/> | <input type="checkbox"/> | <input checked="" type="checkbox"/> |
| 4.  | Deterioration to existing fish or wildlife habitat?   | <input type="checkbox"/> | <input type="checkbox"/> | <input checked="" type="checkbox"/> |
| <b>F. Noise.</b> Will the proposal result in:             |   |                          |                          |                                     |
| 1.  | Increase in existing noise levels?  | <input type="checkbox"/> | <input type="checkbox"/> | <input checked="" type="checkbox"/> |
| 2.  | Exposure of people to severe noise levels?  | <input type="checkbox"/> | <input type="checkbox"/> | <input checked="" type="checkbox"/> |
| <b>G. Light and Glare.</b> Will the proposal result in:   |   |                          |                          |                                     |
| 1.  | The production of new light or glare?   | <input type="checkbox"/> | <input type="checkbox"/> | <input checked="" type="checkbox"/> |
| <b>H. Land Use.</b> Will the proposal result in:          |   |                          |                          |                                     |
| 1.  | A substantial alteration of the present or planned land use of an area?   | <input type="checkbox"/> | <input type="checkbox"/> | <input checked="" type="checkbox"/> |
| <b>I. Natural Resources.</b> Will the proposal result in: |   |                          |                          |                                     |
| 1.  | Increase in the rate of use of any natural resources?   | <input type="checkbox"/> | <input type="checkbox"/> | <input checked="" type="checkbox"/> |
| 2.  | Substantial depletion of any nonrenewable resources?  | <input type="checkbox"/> | <input type="checkbox"/> | <input checked="" type="checkbox"/> |



J. *Risk of Upset.* Does the proposal result in:

- |   | Yes                      | Maybe                    | No                                  |
|---|--------------------------|--------------------------|-------------------------------------|
| 1. A risk of an explosion or the release of hazardous substances (including, but not limited to, oil, pesticides, chemicals, or radiation) in the event of an accident or upset conditions? ..... | <input type="checkbox"/> | <input type="checkbox"/> | <input checked="" type="checkbox"/> |
| 2. Possible interference with emergency response plan or an emergency evacuation plan? .....  | <input type="checkbox"/> | <input type="checkbox"/> | <input checked="" type="checkbox"/> |

K. *Population.* Will the proposal result in:

- |   |                          |                          |                                     |
|---|--------------------------|--------------------------|-------------------------------------|
| 1. The alteration, distribution, density, or growth rate of the human population of the area? ..... | <input type="checkbox"/> | <input type="checkbox"/> | <input checked="" type="checkbox"/> |
|---|--------------------------|--------------------------|-------------------------------------|

L. *Housing.* Will the proposal result in:

- |   |                          |                          |                                     |
|---|--------------------------|--------------------------|-------------------------------------|
| 1. Affecting existing housing, or create a demand for additional housing? ..... | <input type="checkbox"/> | <input type="checkbox"/> | <input checked="" type="checkbox"/> |
|---|--------------------------|--------------------------|-------------------------------------|

M. *Transportation/Circulation.* Will the proposal result in:

- |   |                          |                          |                                     |
|---|--------------------------|--------------------------|-------------------------------------|
| 1. Generation of substantial additional vehicular movement? .....                           | <input type="checkbox"/> | <input type="checkbox"/> | <input checked="" type="checkbox"/> |
| 2. Affecting existing parking facilities, or create a demand for new parking? .....         | <input type="checkbox"/> | <input type="checkbox"/> | <input checked="" type="checkbox"/> |
| 3. Substantial impact upon existing transportation systems? .....                           | <input type="checkbox"/> | <input type="checkbox"/> | <input checked="" type="checkbox"/> |
| 4. Alterations to present patterns of circulation or movement of people and/or goods? ..... | <input type="checkbox"/> | <input type="checkbox"/> | <input checked="" type="checkbox"/> |
| 5. Alterations to waterborne, rail, or air traffic? .....                                   | <input type="checkbox"/> | <input type="checkbox"/> | <input checked="" type="checkbox"/> |
| 6. Increase in traffic hazards to motor vehicles, bicyclists, or pedestrians? .....         | <input type="checkbox"/> | <input type="checkbox"/> | <input checked="" type="checkbox"/> |

N. *Public Services.* Will the proposal have an effect upon, or result in a need for new or altered governmental services in any of the following areas:

- |   |                          |                          |                                     |
|---|--------------------------|--------------------------|-------------------------------------|
| 1. Fire protection? .....                                   | <input type="checkbox"/> | <input type="checkbox"/> | <input checked="" type="checkbox"/> |
| 2. Police protection? .....                                 | <input type="checkbox"/> | <input type="checkbox"/> | <input checked="" type="checkbox"/> |
| 3. Schools? .....   | <input type="checkbox"/> | <input type="checkbox"/> | <input checked="" type="checkbox"/> |
| 4. Parks and other recreational facilities? .....           | <input type="checkbox"/> | <input type="checkbox"/> | <input checked="" type="checkbox"/> |
| 5. Maintenance of public facilities, including roads? ..... | <input type="checkbox"/> | <input type="checkbox"/> | <input checked="" type="checkbox"/> |
| 6. Other governmental services? .....                       | <input type="checkbox"/> | <input type="checkbox"/> | <input checked="" type="checkbox"/> |

O. *Energy.* Will the proposal result in:

- |   |                          |                          |                                     |
|---|--------------------------|--------------------------|-------------------------------------|
| 1. Use of substantial amounts of fuel or energy? .....  | <input type="checkbox"/> | <input type="checkbox"/> | <input checked="" type="checkbox"/> |
| 2. Substantial increase in demand upon existing sources of energy, or require the development of new sources? ..... | <input type="checkbox"/> | <input type="checkbox"/> | <input checked="" type="checkbox"/> |

P. *Utilities.* Will the proposal result in a need for new systems, or substantial alterations to the following utilities:

- |                                    |                          |                          |                                     |
|------------------------------------|--------------------------|--------------------------|-------------------------------------|
| 1. Power or natural gas? .....     | <input type="checkbox"/> | <input type="checkbox"/> | <input checked="" type="checkbox"/> |
| 2. Communication systems? .....    | <input type="checkbox"/> | <input type="checkbox"/> | <input checked="" type="checkbox"/> |
| 3. Water? .....                    | <input type="checkbox"/> | <input type="checkbox"/> | <input checked="" type="checkbox"/> |
| 4. Sewer or septic tanks? .....    | <input type="checkbox"/> | <input type="checkbox"/> | <input checked="" type="checkbox"/> |
| 5. Storm water drainage? .....     | <input type="checkbox"/> | <input type="checkbox"/> | <input checked="" type="checkbox"/> |
| 6. Solid waste and disposal? ..... | <input type="checkbox"/> | <input type="checkbox"/> | <input checked="" type="checkbox"/> |

Q. *Human Health.* Will the proposal result in:

- |  |                          |                          |                                     |
|--|--------------------------|--------------------------|-------------------------------------|
| 1. Creation of any health hazard or potential health hazard (excluding mental health)? ..... | <input type="checkbox"/> | <input type="checkbox"/> | <input checked="" type="checkbox"/> |
| 2. Exposure of people to potential health hazards? .....                                     | <input type="checkbox"/> | <input type="checkbox"/> | <input checked="" type="checkbox"/> |

R. *Aesthetics.* Will the proposal result in:

- |  |                          |                          |                                     |
|--|--------------------------|--------------------------|-------------------------------------|
| 1. The obstruction of any scenic vista or view open to the public, or will the proposal result in the creation of an aesthetically offensive site open to public view? ..... | <input type="checkbox"/> | <input type="checkbox"/> | <input checked="" type="checkbox"/> |
|--|--------------------------|--------------------------|-------------------------------------|

S. *Recreation.* Will the proposal result in:

- |   |                          |                          |                                     |
|---|--------------------------|--------------------------|-------------------------------------|
| 1. An impact upon the quality or quantity of existing recreational opportunities? ..... | <input type="checkbox"/> | <input type="checkbox"/> | <input checked="" type="checkbox"/> |
|---|--------------------------|--------------------------|-------------------------------------|

|               |    |                          |
|---------------|----|--------------------------|
| CALENDAR PAGE | 29 | <input type="checkbox"/> |
| MINUTE PAGE   | 36 | <input type="checkbox"/> |

T. Cultural Resources.

Yes Maybe No

- 1. Will the proposal result in the alteration of or the destruction of a prehistoric or historic archeological site?
- 2. Will the proposal result in adverse physical or aesthetic effects to a prehistoric or historic building, structure, or object?
- 3. Does the proposal have the potential to cause a physical change which would affect unique ethnic cultural values?
- 4. Will the proposal restrict existing religious or sacred uses within the potential impact area?

U. Mandatory Findings of Significance.

- 1. Does the project have the potential to degrade the quality of the environment, reduce the habitat of a fish or wildlife species, cause a fish or wildlife population to drop below self-sustaining levels, threaten to eliminate a plant or animal community, reduce the number or restrict the range of a rare or endangered plant or animal or eliminate important examples of the major periods of California history or prehistory?
- 2. Does the project have the potential to achieve short term, to the disadvantage of long-term, environmental goals?
- 3. Does the project have impacts which are individually limited, but cumulatively considerable?
- 4. Does the project have environmental effects which will cause substantial adverse effects on human beings, either directly or indirectly?

III. DISCUSSION OF ENVIRONMENTAL EVALUATION (See Comments Attached)

IV. PRELIMINARY DETERMINATION

On the basis of this initial evaluation:

- I find the proposed project COULD NOT have a significant effect on the environment, and a NEGATIVE DECLARATION will be prepared.
- I find that although the proposed project could have a significant effect on the environment, there will not be a significant effect in this case because the mitigation measures described on an attached sheet have been added to the project. A NEGATIVE DECLARATION will be prepared
- I find the proposed project MAY have a significant effect on the environment, and an ENVIRONMENTAL IMPACT REPORT is required.

Date: 8 / 24 / 90

*[Signature]*  
 CALENDAR PAGE 30  
 For the State Lands Commission MINUTE PAGE 343

## PROJECT SITE

The site of the proposed swim line is located between two piers constructed on State Lands in Lake Tahoe adjacent to property owned by the Lake Tahoe park Association; (APN 83-0100-03) in Placer County. The State-owned lands on which the piers are constructed are under lease from the State (WP 3887).

The parcel is located on the west shore of Lake Tahoe between the mouths of the Truckee River and Ward Creek which drain into Lake Tahoe.

The northerly pier is constructed from the elevation of 6331.8 feet, extending 110 feet southeasterly into the lake to 6216.7 feet elevation. This pier is constructed of 10-inch steel piles connected with wood stringers and deck.

The south pier is constructed in a similar manner. It lies approximately 200 feet south of the north pier. It extends 121 feet into the lake from its shoreward point. The deck elevation is the same as the north pier.

## PROPOSED PROJECT

The proposed project involves the extension of a buoyed plastic rope swim line between the two piers located at Tahoe Park Association property. The swim line will extend from a point approximately 50 feet waterward of the foot of the north pier. The swim line will be extended 200 feet southerly to be attached to the south pier. It will lie approximately 90 feet waterward of the head of the south pier.

The swim line will consist of a 3/8 inch plastic "poly" wound line. Floatation buoys are fitted to the line to furnish floatation and to provide a visible boundary for nearby boating traffic.

A mooring area with buoys to tie boats is located approximately 80 feet east of the planned swim line location. This mooring area is used primarily by Tahoe park Association members.

The proposed swim line is intended to be used as a seasonal barrier for a swimming area established for Tahoe Park Association members. The applicant indicates the swim line is intended for use during the swimming season; being deployed usually in late June and being withdrawn after Labor Day.

The line will be taken out of the water and stored during the winter season.

|               |     |
|---------------|-----|
| CALENDAR PAGE | 31  |
| MINUTE PAGE   | 314 |

TAHOE PARK ASSOCIATION  
PROPOSED SWIM LINE

R.O. 1388  
W.P. 38

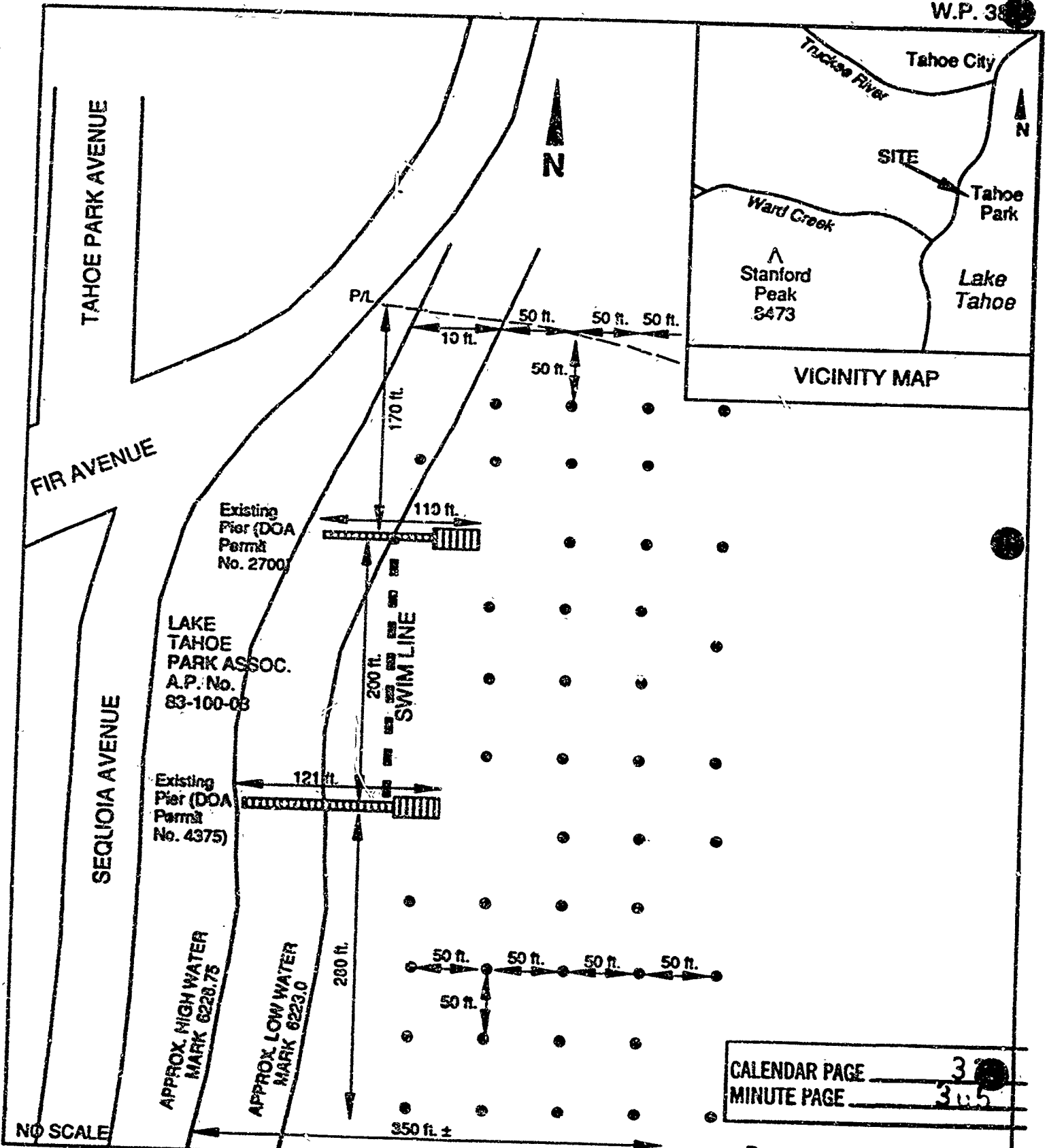

CALENDAR PAGE 3  
MINUTE PAGE 305

Prepared July 26, 1990 by LLB