

MINUTE ITEM

This Calendar Item No. C16
was approved as Minute Item
No. C16 by the State Lands
Commission by a vote of 2
to 0 at its 6/11/90
meeting.

CALENDAR ITEM

C 1 6

A 10
S 5

06/11/90
W 24416 PRC 7405
Maricle

GENERAL PERMIT - PUBLIC AGENCY USE

APPLICANT: Walnut Grove Fire District
P. O. Box 41
Walnut Grove, California 95690

AREA, TYPE LAND AND LOCATION:
A 0.076-acre parcel of tide and submerged land,
Sacramento River, Mile 26.95, Sacramento County.

LAND USE: Pilings, gangway, dock, and covered slip.

TERMS OF PROPOSED PERMIT:
Initial period: 49 years beginning April 1,
1990.

CONSIDERATION: The public health and safety; with the State
reserving the right at any time to set a
monetary rental if the Commission finds such
action to be in the State's best interest.

BASIS FOR CONSIDERATION:
Pursuant to 2 Cal. Code Regs. 2003.

APPLICANT STATUS:
Applicant is lessee of upland.

PREREQUISITE CONDITIONS, FEES AND EXPENSES:
Filing fee has been received.

STATUTORY AND OTHER REFERENCES:
A. P.R.C.: Div. 6, Parts 1 and 2; Div. 13.
B. Cal. Code Regs.: Title 2, Div. 3;
Title 14, Div. 6.

CALENDAR ITEM NO. C 16 (CONT'D)

AB 884:

06/20/90.

OTHER PERTINENT INFORMATION:

1. Pursuant to the Commission's delegation of authority and the State CEQA Guidelines (14 Cal. Code Regs. 15061), the staff has determined that this activity is exempt from the requirements of the CEQA as a categorically exempt project. The project is exempt under Class 3, New Construction, Small Structures, 2 Cal. Code Regs 2905(c)(1).

Authority: P.R.C. 21084, 14 Cal. Code Regs. 15300, and 2 Cal. Code Regs. 2905.

2. The Applicant has requested waiver of the \$350 minimum expense deposit because of a limited budget which does not include funds for such expense. In view of the Applicant's public function - response to any emergency in its service area - the staff of the State Lands Commission believes the request is proper.
3. The Applicant is a fire-fighting organization funded by Sacramento property taxes. It provides protection to the public on highways and waterways in the Delta.
4. If this project is approved, it will include the installation of four (4) steel pilings in the waterway; construction of a concrete stairway off the levee crown; installation of a 5 ft. x 60 ft. gangway connecting to an 8 ft. x 57 ft. dock and 16 ft. x 26 ft. covered boat slip. The proposed work is to provide for storage of the fireboat and emergency ingress and egress for firemen and other emergency response personnel.

APPROVALS OBTAINED:

United States Army Corps of Engineers.

FURTHER APPROVALS REQUIRED:

Sacramento County, Reclamation Board, and Reclamation District No. 3.

CALENDAR PAGE

98

MINUTE PAGE

1073

CALENDAR ITEM NO. C 1 6 (CONT'D)

EXHIBITS: A. Land Description.
 B. Location Map.

IT IS RECOMMENDED THAT THE COMMISSION:

1. FIND THAT THE ACTIVITY IS EXEMPT FROM THE REQUIREMENTS OF THE CEQA PURSUANT TO 14 CAL. CODE REGS. 15061 AS A CATEGORICALLY EXEMPT PROJECT, CLASS 3, NEW CONSTRUCTION, SMALL STRUCTURES, 14 CAL. CODE REGS. 15300, 2 CAL. CODE REGS. 2905(c)(1).
2. WAIVE THE \$350 MINIMUM EXPENSE DEPOSIT.
3. AUTHORIZE ISSUANCE TO THE WALNUT GROVE FIRE DISTRICT OF A 49-YEAR GENERAL PERMIT - PUBLIC AGENCY USE, BEGINNING APRIL 1, 1990; IN CONSIDERATION THE PUBLIC HEALTH AND SAFETY, WITH THE STATE RESERVING THE RIGHT AT ANY TIME TO SET A MONETARY RENTAL IF THE COMMISSION FINDS SUCH ACTION TO BE IN THE STATE'S BEST INTEREST; FOR A GANGWAY, FOUR STEEL PILINGS, AN 8-FOOT BY 57-FOOT DOCK AND A 16-FOOT X 26-FOOT BOAT SLIP ON THE LAND DESCRIBED ON EXHIBIT "A" ATTACHED AND BY REFERENCE MADE A PART HEREOF.

EXHIBIT "A"

LAND DESCRIPTION

W 24416

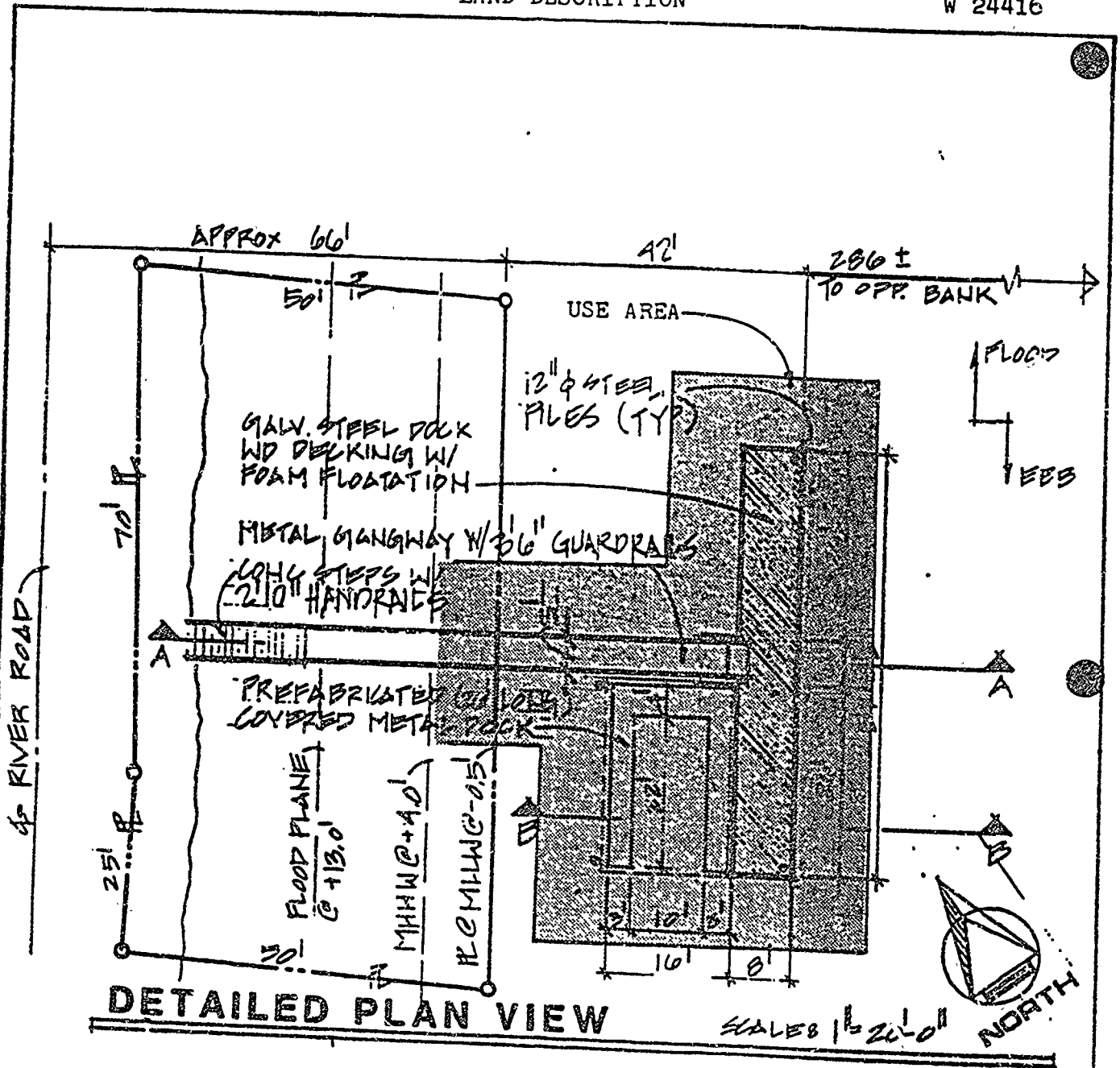

PREPARED JANUARY 19, 1990 BY BIU 1.

 816 778 1181
 WOLLMER & ASSOCIATES
 CIVIL ENGINEERS
 1000 N. ST. MARYS AVE. SUITE 100
 SACRAMENTO, CALIF. 95833

PROJECT: FIRE DISTRICT DOCK
 PARCEL NO. 142-0098-004
LOCATION: HIGHWAY 160
 WALNUT GROVE, CA 95690
 SACRAMENTO COUNTY

DATE:
 JUNE 1989
DATUM:
 NCVD
 CALENDAR PAGE
 MINUTE PAGE

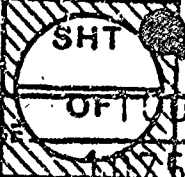
 SHT
 OF 10

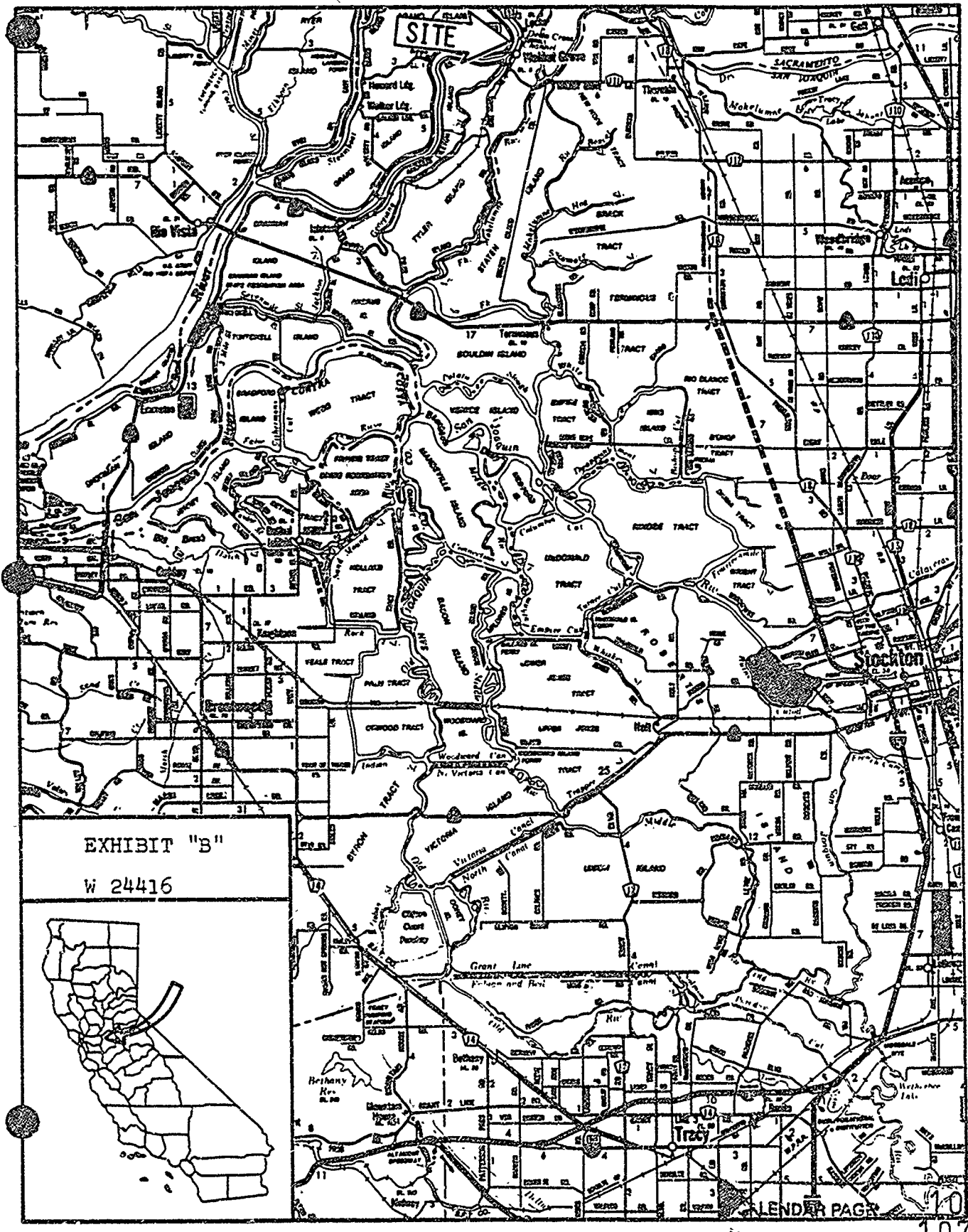

EXHIBIT "B"
W 24416

