

MINUTE ITEM

This Calendar Item No. 608  
was approved as Minute Item  
No. 8 by the State Lands  
Commission by a vote of 2  
to 0 at its 11/21/83  
meeting.

CALENDAR ITEM

608 1

11/21/83  
WP 5116  
G08-03  
Graber  
PRC 5116

DREDGING PERMIT

APPLICANT: Moss Landing Harbor District  
P. O. Box 102  
Moss Landing, California 95039

AREA, TYPE LAND AND LOCATION:  
Granted lands on the bed of Moss Landing  
Harbor, Monterey County, California.

LAND USE: Dredge up to 40,000 cubic yards of sediments  
to deepen the harbor channel for safe navi-  
gation and mooring within the harbor.

Spoils to be deposited at authorized sites  
on an adjacent harbor district-owned beach  
and at United States Army Corps of Engineers  
approved disposal site S.F. 12 off Sandholdt  
Pier. No royalty will be charged for spoils  
placed on publicly owned lands. A royalty  
of \$0.25 per cubic yard will be charged  
for spoils placed on privately owned property  
or sold for commercial benefit.

TERMS OF PROPOSED PERMIT:

Initial Period: One year from December 1,  
1983.

A 28

S 17

-1-

CALENDAR PAGE	<u>49</u>
MINUTE PAGE	<u>2598</u>

CALENDAR ITEM NO. C 0 8 (CONTD)

CONSIDERATION: No royalty to be charged for spoils placed on publicly owned lands and beaches. A royalty of \$0.25 per cubic yard will be charged for spoils placed on private property or sold for commercial benefit.

PREREQUISITE TERMS, FEES AND EXPENSES:  
Filing fee has been received.

STATUTORY AND OTHER REFERENCES:  
A. P.R.C. 6303, 6370 and 21065.  
B. 14 Cal Adm. Code 15304(g) CEQA Guidelines  
2 Cal. Adm. Code 2905, 2951-2954.

AB 884: 2/1/84.

OTHER PERTINENT INFORMATION:  
1. Determine this project is exempt from CEQA under CEQA Guidelines 15304 Class 4(g) as a maintenance dredging project.  
2. All necessary application requirements have been fulfilled.  
3. This project is situated on State lands identified as possessing significant environmental values pursuant to P.R.C. 370.1 and is classified in Use Category Class B-Limited and C-Multiple Use. Staff has coordinated this project with those agencies and organizations which nominated the site as containing significant environmental values. They have found this project to be compatible with their nomination.

EXHIBITS: A. Site Map.  
B. Land Description (Map).

APPROVALS OBTAINED:  
United States Army Corps of Engineers,  
California Coastal Commission, and State  
Water Quality Control Board.

IT IS RECOMMENDED THAT THE COMMISSION:

1. DETERMINE THAT AN ENVIRONMENTAL DOCUMENT HAS NOT BEEN PREPARED FOR THIS ACTIVITY AS SUCH DOCUMENT IS NOT REQUIRED UNDER THE PROVISIONS OF P.R.C. 21084, 14 CAL. ADM. CODE 15304 AND 2 CAL. ADM. CODE 2905.

CALENDAR ITEM NO. C08 (CONTD)

2. FIND THAT GRANTING OF THE PERMIT WILL HAVE NO SIGNIFICANT EFFECT UPON ENVIRONMENTAL CHARACTERISTICS IDENTIFIED PURSUANT TO SECTION 6370.1 OF THE P.R.C.
3. AUTHORIZE ISSUANCE TO THE MOSS LANDING HARBOR DISTRICT OF A ONE-YEAR DREDGING PERMIT FROM DECEMBER 1, 1983, IN CONSIDERATION OF NO ROYALTY TO BE CHARGED FOR SPOILS PLACED ON PUBLICLY OWNED LANDS.

CALENDAR PAGE	51
MINUTE PAGE	2600

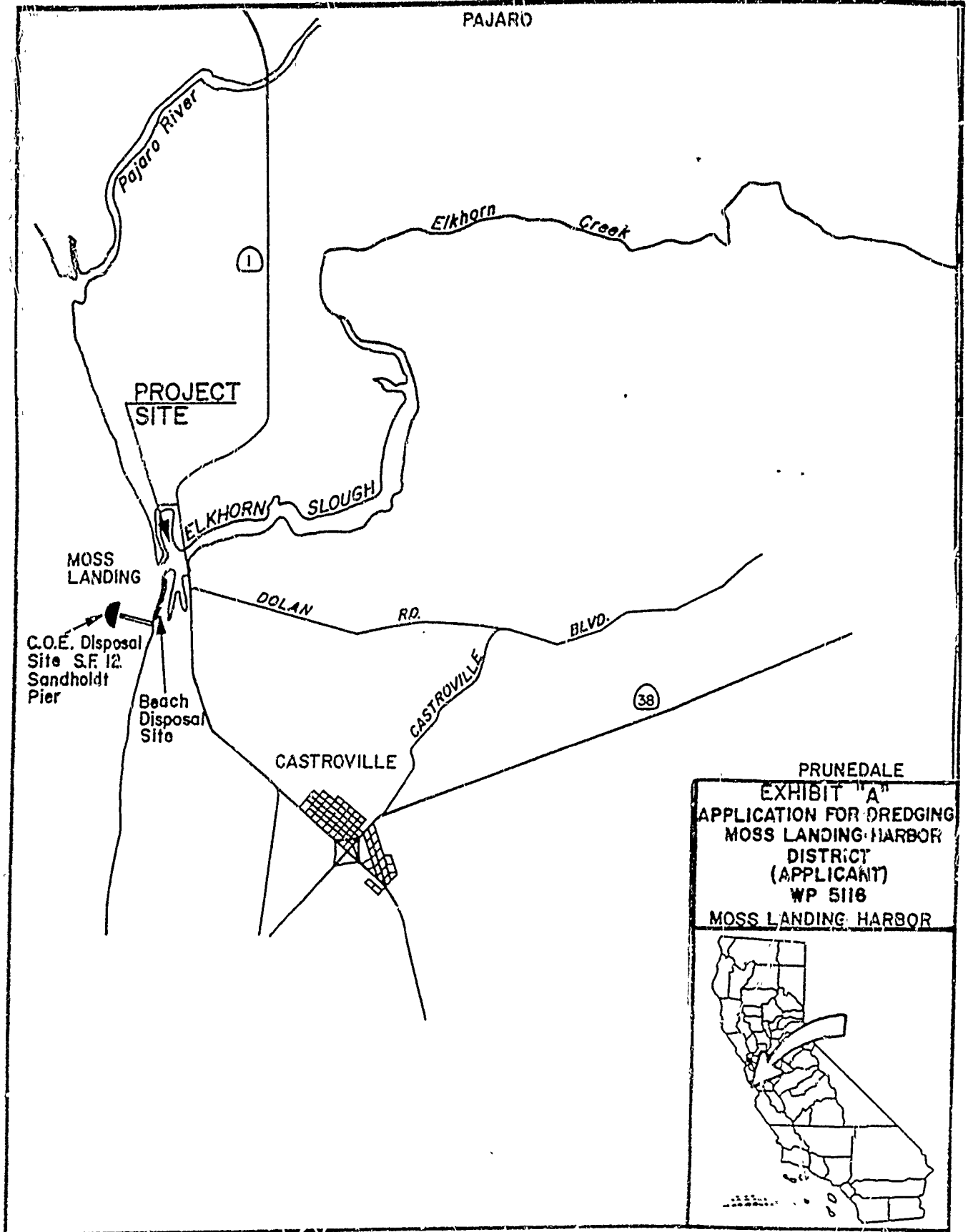

PRUNEDALE  
 EXHIBIT "A"  
 APPLICATION FOR DREDGING  
 MOSS LANDING HARBOR  
 DISTRICT  
 (APPLICANT)  
 WP 5116  
 MOSS LANDING HARBOR

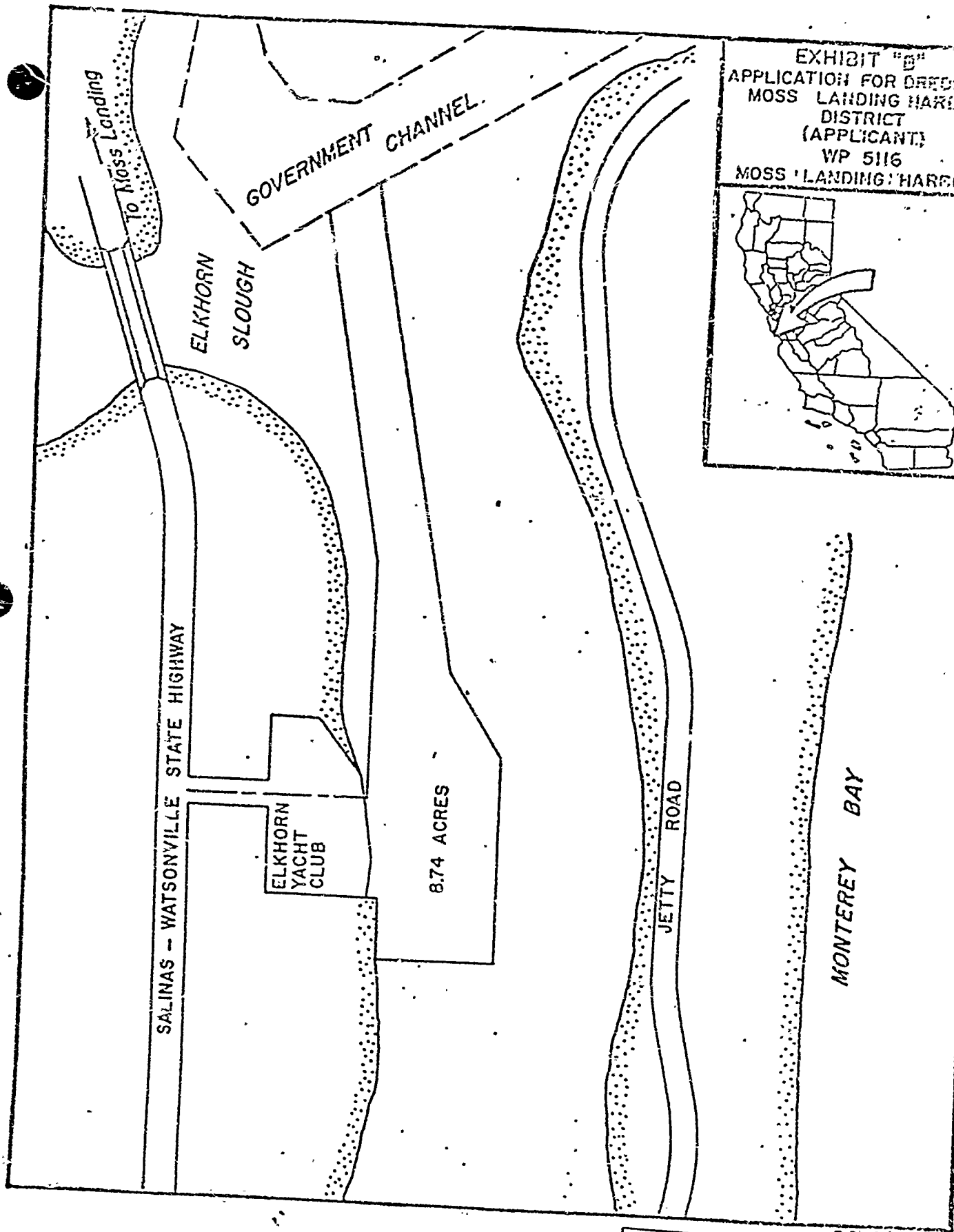

EXHIBIT "B"  
 APPLICATION FOR DREDGING  
 MOSS LANDING HARBOR  
 DISTRICT  
 (APPLICANT)  
 WP 5116  
 MOSS LANDING HARBOR



MONTEREY BAY

8.74 ACRES

ELKHORN  
 YACHT  
 CLUB

SALINAS - WATSONVILLE STATE HIGHWAY

Moss Landing

ELKHORN  
 SLOUGH

GOVERNMENT CHANNEL

JETTY ROAD

R.O. 10/65

CALENDAR PAGE	53
MINUTE PAGE	2602