

MINUTE ITEM

This Calendar Item No. C8  
was approved as Minute Item  
No. 8 by the State Lands  
Commission by a vote of 2  
to 0 at its 11/23/81  
meeting.

CALENDAR ITEM

C 0 8

11/23/81  
W 22195  
Lane  
PRC 6086

GENERAL PERMIT - PROTECTIVE STRUCTURE USE

APPLICANT: Daniel Yamshon  
1220 H Street, Suite 102  
Sacramento, California 95814

AREA, TYPE LAND AND LOCATION:  
A 0.08-acre parcel of tide and submerged  
land in the Sacramento River, Sacramento  
County.

LAND USE: Bank stabilization and protection.

TERMS OF PROPOSED PERMIT:  
Initial period: 25 years from April 3,  
1980.

CONSIDERATION: The public benefit with the State reserving  
the right at any time to set monetary rental  
if the Commission finds such action to  
be in the State's best interest.

BASIS FOR CONSIDERATION:  
Pursuant to 2 Cal. Adm. Code 2005.

PREREQUISITE TERMS, FEES AND EXPENSES:  
Applicant is owner of upland.

Filing fee and processing costs have been  
received.

STATUTORY AND OTHER REFERENCES:  
A. P.R.C.: Div. 6, Parts 1 and 2; Div. 13.  
B. Cal. Adm. Code: Title 2, Div. 3; Title 14,  
Div. 6.

AB 884: 10/22/82.

OTHER PERTINENT INFORMATION:

1. The applicant proposes to place approximately  
4,700 cubic yards of riprap material  
on the bank of the Sacramento River  
to stabilize the levee.

A 5

S 3

CALENDAR PAGE	27
MINUTE PAGE	2459

CALENDAR ITEM NO. C 0-8 (CONTD)

Staff feels that bank protection at this location will be of mutual benefit to both the applicant and the public. The bank will have additional protection at no cost to the public.

2. The annual rental value of the site is estimated to be \$70.
3. An EIR is not required. This transaction is within the purview of 14 Cal. Adm. Code, Div. 6, Section 15104, which exempts minor alterations in the condition of land and water.
4. This project is situated on State land identified as possessing significant environmental values pursuant to P.R.C. 6370.1, and is classified in a use category, Class B, which authorizes Limited Use.

Staff has coordinated this project with those agencies and organizations which nominated the site as containing significant environmental values. They have found this project to be compatible with their nomination.

- EXHIBITS:
- A. Land Description.
  - B. Location Map.

IT IS RECOMMENDED THAT THE COMMISSION:

1. DETERMINE THAT AN ENVIRONMENTAL DOCUMENT HAS NOT BEEN PREPARED FOR THIS ACTIVITY AS SUCH DOCUMENT IS NOT REQUIRED UNDER THE PROVISIONS OF P.R.C. 21084, 14 CAL. ADM. CODE 15100 ET SEQ., AND 2 CAL. ADM. CODE 2907.
2. FIND THAT GRANTING OF THE PERMIT WILL HAVE NO SIGNIFICANT EFFECT UPON ENVIRONMENTAL CHARACTERISTICS IDENTIFIED PURSUANT TO SECTION 6370.1, OF THE P.R.C.
3. AUTHORIZE ISSUANCE TO DANIEL YAMSHON OF A 25-YEAR GENERAL PERMIT - PROTECTIVE STRUCTURE USE FROM APRIL 3, 1980; IN CONSIDERATION OF THE PUBLIC BENEFIT, WITH THE STATE RESERVING THE RIGHT AT ANY TIME TO SET A MONETARY RENTAL IF THE COMMISSION FINDS SUCH ACTION TO BE IN THE STATE'S BEST INTEREST; FOR BANK STABILIZATION AND PROTECTION ON THE LAND DESCRIBED ON EXHIBIT "A" ATTACHED AND BY REFERENCE MADE A PART HEREOF.

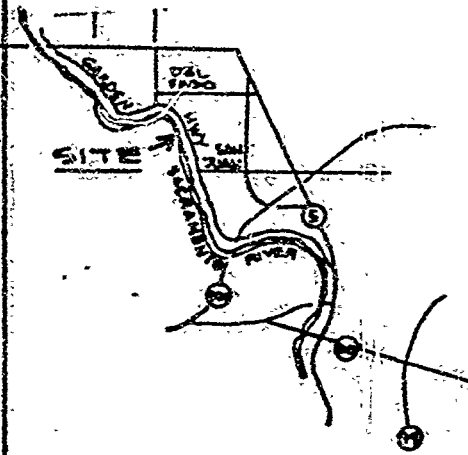
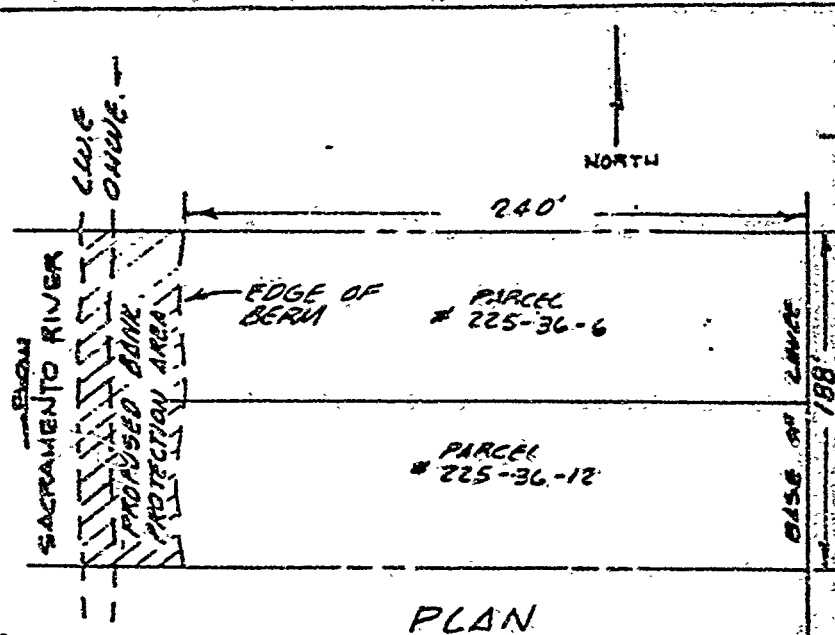

NOTE:  
NO ASPHALT WILL BE USED FOR RIP-RAP.

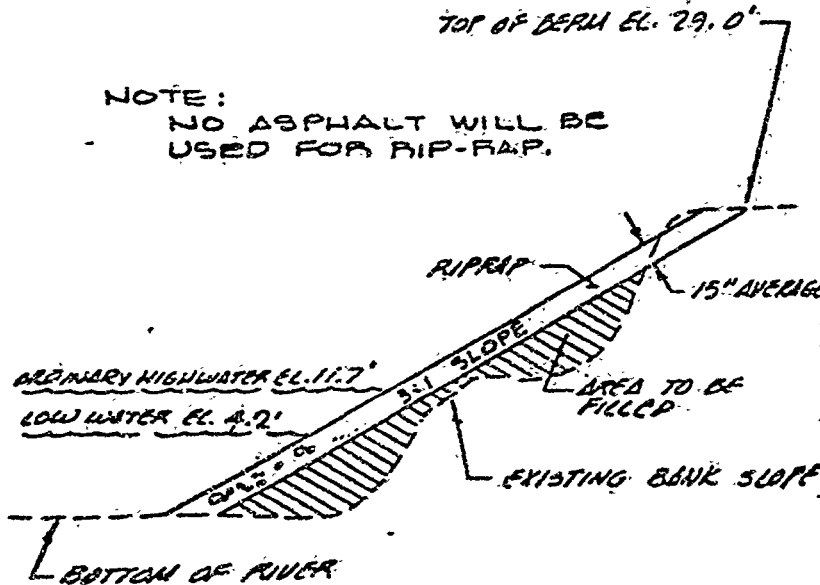

- NOTE:
- (A) TOP OF RIP-RAP TO BE PLACED UP TO FLOOD PLAIN EL. OF 29'
  - (B) RIP-RAP TO BE PLACED AT 3-1 SLOPE, ROCK AND CONCRETE, AVERAGE DIA. 18"
  - (C) ALL ELEVATIONS SHOWN REFER TO U.S.G.S. M.S.L. ELEVATION.

PROPOSED BANK PROTECTION

LOCATION: ASSESSOR'S PARCEL  
225-36-6-12  
SACRAMENTO CO.  
APPLICATION BY:  
DANIEL YAMSHON  
1220 H ST STE 102  
SACRAMENTO, CA.  
95814

DATE: 10 APRIL 1979  
SHEET 1 OF 1

EXHIBIT "A"  
LAND DESCRIPTION

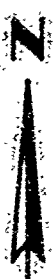
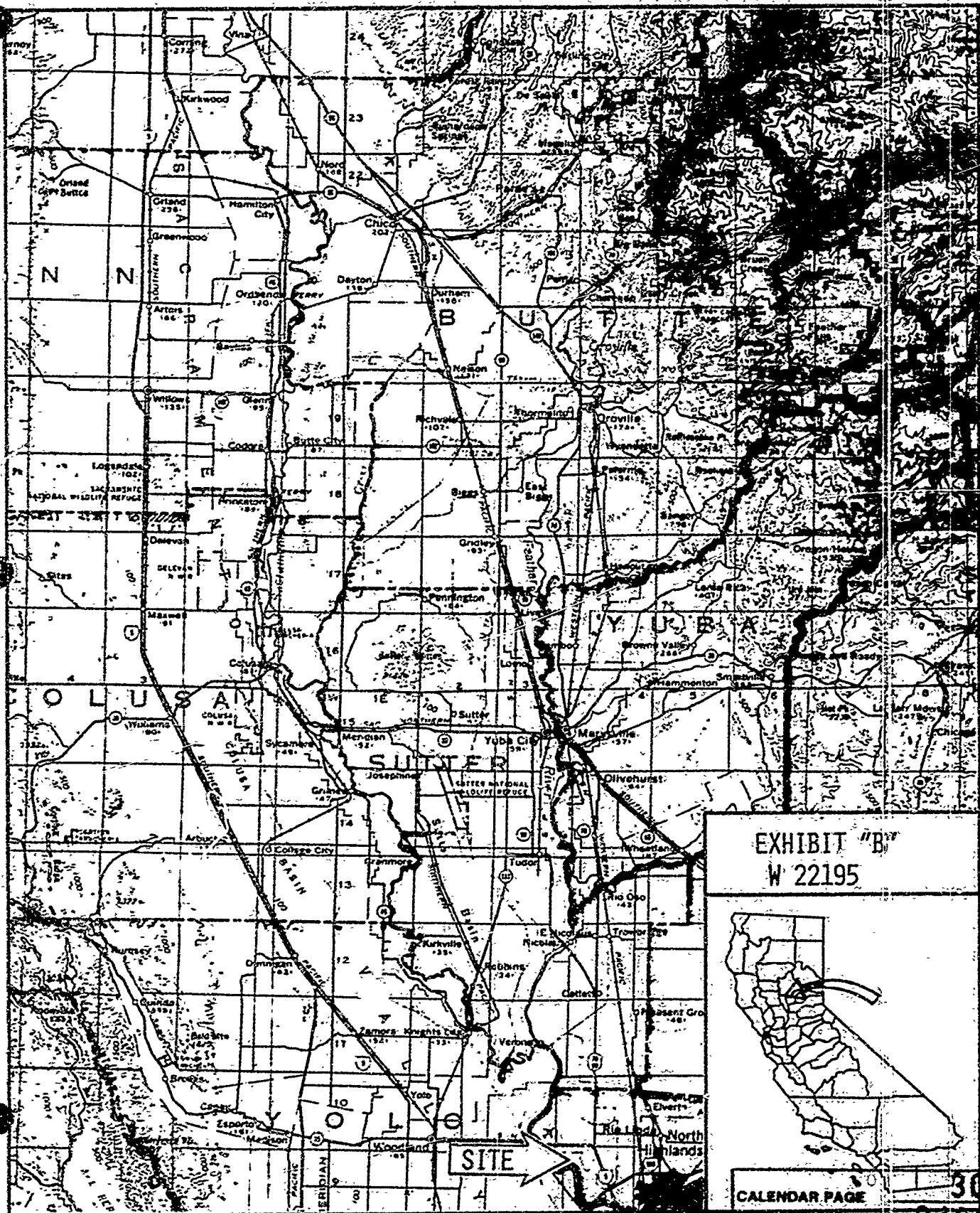

EXHIBIT "B"  
W 22195



CALENDAR PAGE	30
MINUTE PAGE	2462